

FACILITY NAME Red Panther Chemical Co.  
 FACILITY ADDRESS P.O. Box 550, Clarksdale, MS 38614-  
 TANK IDENTIFICATION NO./NAME

TS-05

1. Product stored; e.g. crude oil, gasoline, etc.	Soybean Oil
2. True vapor pressure of product at storage temperature (PSIA/°F)	N/A
3. Reid vapor pressure of product at storage temperature (PSIA/°F)	N/A
4. Density of product stored at storage temperature (lbs/gal)	N/A
5. Molecular weight of product vapor at storage temperature lb/lb mole	N/A
6. Throughput for the most recent calendar year (gals/year)	5,000
7. Tank Capacity (gals)	30,000
8. Tank Diameter (feet)	16
9. Tank Height (feet)	20
10. Average Vapor Space Height (feet)	2.0
11. Tank Construction: Riveted or Welded	Welded
12. Type of Tank:	
Fixed Roof	✓
Floating Roof: External or Internal	
Variable Vapor Space	
Pressure	
Other, Describe	
13. For external floating roof tanks, Type Seals:	
Metallic shoe seal	
Primary seal only	N/A
With shoe mounted secondary seal	N/A
With rim mounted secondary seal	N/A
Liquid mounted resilient seal	
Primary seal only	N/A
With weather shield	N/A
With rim mounted secondary seal	N/A
Vapor mounted resilient seal	
Primary seal only	N/A
With weather shield	N/A
With rim mounted secondary seal	N/A

TANK IDENTIFICATION NO./NAME

TS-05

14. For internal floating roof tanks, Type Seals:	
Liquid mounted resilient seal	
<u>Primary seal only</u>	N/A
<u>With rim mounted secondary seal</u>	N/A
Vapor mounted resilient seal	
<u>Primary seal only</u>	N/A
<u>With rim mounted secondary seal</u>	N/A
Is the roof column supported? If yes, give	
a. <u>Number of columns</u>	N/A
b. <u>Column diameter (inches)</u>	N/A
15. Tank paint color; White, Aluminum (diffuse or specular), Light Gray, Medium Gray, Gray, Other (describe)	Gray
16. Tank paint condition: Good or Poor	Good
17. Tank shell condition: Light rust, dense rust, gunite lined	Aluminum
18. Tank seal condition: Good or Poor	N/A
19. Date tank installed	1988
20. Tank modifications: Give date and describe	N/A
21. Is the tank equipped with a vapor recovery system? If yes, describe	No
22. Average wind velocity of the area (miles/hour)	7mph

FACILITY NAME Red Pontiac Chemical Co.

FACILITY ADDRESS P.O. Box 550, Clarksville MS 38601

TANK IDENTIFICATION NO./NAME

TS-06

1. Product stored; e.g. crude oil, gasoline, etc.	Cythion RTU
2. True vapor pressure of product at storage temperature (PSIA/°F)	0.00004
3. Reid vapor pressure of product at storage temperature (PSIA/°F)	N/A
4. Density of product stored at storage temperature (lbs/gal)	8.9
5. Molecular weight of product vapor at storage temperature lb/lb mole	N/A
6. Throughput for the most recent calendar year (gals/year)	0
7. Tank Capacity (gals)	30,000
8. Tank Diameter (feet)	16
9. Tank Height (feet)	20
10. Average Vapor Space Height (feet)	2.0
11. Tank Construction: Riveted or Welded	Welded
12. Type of Tank:	
Fixed Roof	✓
Floating Roof: External or Internal	
Variable Vapor Space	
Pressure	
Other, Describe	
13. For external floating roof tanks, Type Seals:	
Metallic shoe seal	
Primary seal only	N/A
With shoe mounted secondary seal	N/A
With rim mounted secondary seal	N/A
Liquid mounted resilient seal	
Primary seal only	N/A
With weather shield	N/A
With rim mounted secondary seal	N/A
Vapor mounted resilient seal	
Primary seal only	N/A
With weather shield	N/A
With rim mounted secondary seal	N/A

TANK IDENTIFICATION NO./NAME

TS-06

14. For internal floating roof tanks, Type Seals:	
Liquid mounted resilient seal	
<u>Primary seal only</u>	N/A
<u>With rim mounted secondary seal</u>	N/A
Vapor mounted resilient seal	
<u>Primary seal only</u>	N/A
<u>With rim mounted secondary seal</u>	N/A
Is the roof column supported? If yes, give	
a. <u>Number of columns</u>	N/A
b. <u>Column diameter (inches)</u>	N/A
15. Tank paint color; White, Aluminum (diffuse or specular), Light Gray, Medium Gray, Gray, Other (describe)	Gray
16. Tank paint condition: Good or Poor	Good
17. Tank shell condition: Light rust, dense rust, gunite lined	Aluminum
18. Tank seal condition: Good or Poor	N/A
19. Date tank installed	1988
20. Tank modifications: Give date and describe	N/A
21. Is the tank equipped with a vapor recovery system? If yes, describe	No
22. Average wind velocity of the area (miles/hour)	7mph

FACILITY NAME Redd Inther Chemical Co.  
 FACILITY ADDRESS P.O. Box 550, Clarksdale, MS 38614  
 TANK IDENTIFICATION NO./NAME

TS-07

1. Product stored; e.g. crude oil, gasoline, etc.	Empty
2. True vapor pressure of product at storage temperature (PSIA/°F)	N/A
3. Reid vapor pressure of product at storage temperature (PSIA/°F)	N/A
4. Density of product stored at storage temperature (lbs/gal)	N/A
5. Molecular weight of product vapor at storage temperature lb/lb mole	N/A
6. Throughput for the most recent calendar year (gals/year)	N/A
7. Tank Capacity (gals)	30,000
8. Tank Diameter (feet)	16
9. Tank Height (feet)	20
10. Average Vapor Space Height (feet)	2.0
11. Tank Construction: Riveted or Welded	Welded
12. Type of Tank:	
Fixed Roof	✓
Floating Roof: External or Internal	
Variable Vapor Space	
Pressure	
Other, Describe	
13. For external floating roof tanks, Type Seals:	
Metallic shoe seal	
Primary seal only	N/A
With shoe mounted secondary seal	N/A
With rim mounted secondary seal	N/A
Liquid mounted resilient seal	
Primary seal only	N/A
With weather shield	N/A
With rim mounted secondary seal	N/A
Vapor mounted resilient seal	
Primary seal only	N/A
With weather shield	N/A
With rim mounted secondary seal	N/A

TANK IDENTIFICATION NO./NAME

TS-07

14. For internal floating roof tanks, Type Seals:	
Liquid mounted resilient seal	
<u>Primary seal only</u>	N/A
<u>With rim mounted secondary seal</u>	N/A
Vapor mounted resilient seal	
<u>Primary seal only</u>	N/A
<u>With rim mounted secondary seal</u>	N/A
Is the roof column supported? If yes, give	
a. <u>Number of columns</u>	N/A
b. <u>Column diameter (inches)</u>	N/A
15. Tank paint color; White, Aluminum (diffuse or specular), Light Gray, Medium Gray, Gray, Other (describe)	Gray
16. Tank paint condition: Good or Poor	Good
17. Tank shell condition: Light rust, dense rust, gunite lined	Aluminum
18. Tank seal condition: Good or Poor	N/A
19. Date tank installed	1988
20. Tank modifications: Give date and describe	N/A
21. Is the tank equipped with a vapor recovery system? If yes, describe	No
22. Average wind velocity of the area (miles/hour)	7mph

FACILITY NAME Panther Chemical Co.  
 FACILITY ADDRESS P.O. Box 550, Clarksdale, MS 38614-  
 TANK IDENTIFICATION NO./NAME

T5-08

1. Product stored; e.g. crude oil, gasoline, etc.	T500/100
2. True vapor pressure of product at storage temperature ( <del>PSIA/°F</del> ) (mmHg @ 20°C)	0.2
3. Reid vapor pressure of product at storage temperature (PSIA/°F)	N/A
4. Density of product stored at storage temperature (lbs/gal)	7.24
5. Molecular weight of product vapor at storage temperature lb/lb mole	N/A
6. Throughput for the most recent calendar year (gals/year)	26,000
7. Tank Capacity (gals)	30,000
8. Tank Diameter (feet)	16
9. Tank Height (feet)	20
10. Average Vapor Space Height (feet)	2.0
11. Tank Construction: Riveted or Welded	Welded
12. Type of Tank:	
Fixed Roof	✓
Floating Roof: External or Internal	
Variable Vapor Space	
Pressure	
Other, Describe	
13. For external floating roof tanks, Type Seals:	
Metallic shoe seal	
Primary seal only	N/A
With shoe mounted secondary seal	N/A
With rim mounted secondary seal	N/A
Liquid mounted resilient seal	
Primary seal only	N/A
With weather shield	N/A
With rim mounted secondary seal	N/A
Vapor mounted resilient seal	
Primary seal only	N/A
With weather shield	N/A
With rim mounted secondary seal	N/A

TANK IDENTIFICATION NO./NAME

TS-09

14. For internal floating roof tanks, Type Seals:	
Liquid mounted resilient seal	
<u>Primary seal only</u>	N/A
<u>With rim mounted secondary seal</u>	N/A
Vapor mounted resilient seal	
<u>Primary seal only</u>	N/A
<u>With rim mounted secondary seal</u>	N/A
Is the roof column supported? If yes, give	
a. <u>Number of columns</u>	N/A
b. <u>Column diameter (inches)</u>	N/A
15. Tank paint color; White, Aluminum (diffuse or specular), Light Gray, Medium Gray, Gray, Other (describe)	Gray
16. Tank paint condition: Good or Poor	Good
17. Tank shell condition: Light rust, dense rust, gunite lined	Aluminum
18. Tank seal condition: Good or Poor	N/A
19. Date tank installed	1988
20. Tank modifications: Give date and describe	N/A
21. Is the tank equipped with a vapor recovery system? If yes, describe	No
22. Average wind velocity of the area (miles/hour)	7mph



FACILITY NAME Kod Partner Chemical Co.  
 FACILITY ADDRESS P.O. Box 550, Clarksdale, MS 38614  
 TANK IDENTIFICATION NO./NAME

TS-09

1. Product stored; e.g. crude oil, gasoline, etc.	Empty
2. True vapor pressure of product at storage temperature (PSIA/°F)	N/A
3. Reid vapor pressure of product at storage temperature (PSIA/°F)	N/A
4. Density of product stored at storage temperature (lbs/gal)	N/A
5. Molecular weight of product vapor at storage temperature lb/lb mole	N/A
6. Throughput for the most recent calendar year (gals/year)	N/A
7. Tank Capacity (gals)	20,000
8. Tank Diameter (feet)	3.8
9. Tank Height (feet)	24
10. Average Vapor Space Height (feet)	N/A
11. Tank Construction: Riveted or Welded	Welded
12. Type of Tank:	
<u>Fixed Roof</u>	✓
<u>Floating Roof: External or Internal</u>	
<u>Variable Vapor Space</u>	
<u>Pressure</u>	
<u>Other, Describe</u>	
13. For external floating roof tanks, Type Seals:	
Metallic shoe seal	
<u>Primary seal only</u>	N/A
<u>With shoe mounted secondary seal</u>	N/A
<u>With rim mounted secondary seal</u>	N/A
Liquid mounted resilient seal	
<u>Primary seal only</u>	N/A
<u>With weather shield</u>	N/A
<u>With rim mounted secondary seal</u>	N/A
Vapor mounted resilient seal	
<u>Primary seal only</u>	N/A
<u>With weather shield</u>	N/A
<u>With rim mounted secondary seal</u>	N/A

TANK IDENTIFICATION NO./NAME

TS-09

14. For internal floating roof tanks, Type Seals:	
Liquid mounted resilient seal	
<u>Primary seal only</u>	N/A
<u>With rim mounted secondary seal</u>	N/A
Vapor mounted resilient seal	
<u>Primary seal only</u>	N/A
<u>With rim mounted secondary seal</u>	N/A
Is the roof column supported? If yes, give	
a. Number of columns	N/A
b. Column diameter (inches)	N/A
15. Tank paint color; White, Aluminum (diffuse or specular), Light Gray, Medium Gray, Gray, Other (describe)	Aluminum (Diffuse)
16. Tank paint condition: Good or Poor	Good
17. Tank shell condition: Light rust, dense rust, gunite lined	Light Rust
18. Tank seal condition: Good or Poor	N/A
19. Date tank installed	1988
20. Tank modifications: Give date and describe	N/A
21. Is the tank equipped with a vapor recovery system? If yes, describe	No
22. Average wind velocity of the area (miles/hour)	7mph

FACILITY NAME Red Panther Chemical Co.

FACILITY ADDRESS P.O. Box 550, Clarksdale, MS 38614

TANK IDENTIFICATION NO./NAME

TS-10

1. Product stored; e.g. crude oil, gasoline, etc.	Methanol
2. True vapor pressure of product at storage temperature (PSIA/°F)	96
3. Reid vapor pressure of product at storage temperature (PSIA/°F)	N/A
4. Density of product stored at storage temperature (lbs/gal)	6.5
5. Molecular weight of product vapor at storage temperature lb/lb mole	N/A
6. Throughput for the most recent calendar year (gals/year)	100,000
7. Tank Capacity (gals)	20,000
8. Tank Diameter (feet)	3.8
9. Tank Height (feet)	24
10. Average Vapor Space Height (feet)	2.0
11. Tank Construction: Riveted or Welded	Welded
12. Type of Tank:	
Fixed Roof	✓
Floating Roof: External or Internal	
Variable Vapor Space	
Pressure	
Other, Describe	
13. For external floating roof tanks, Type Seals:	
Metallic shoe seal	
Primary seal only	N/A
With shoe mounted secondary seal	N/A
With rim mounted secondary seal	N/A
Liquid mounted resilient seal	
Primary seal only	N/A
With weather shield	N/A
With rim mounted secondary seal	N/A
Vapor mounted resilient seal	
Primary seal only	N/A
With weather shield	N/A
With rim mounted secondary seal	N/A

14. For internal floating roof tanks, Type Seals:	
Liquid mounted resilient seal	
<u>Primary seal only</u>	N/A
<u>With rim mounted secondary seal</u>	N/A
Vapor mounted resilient seal	
<u>Primary seal only</u>	N/A
<u>With rim mounted secondary seal</u>	N/A
Is the roof column supported? If yes, give	
a. <u>Number of columns</u>	N/A
b. <u>Column diameter (inches)</u>	N/A
15. Tank paint color; White, Aluminum (diffuse or specular), Light Gray, Medium Gray, Gray, Other (describe)	Aluminum (Diffuse)
16. Tank paint condition: Good or Poor	Good
17. Tank shell condition: Light rust, dense rust, gunite lined	Light Rust
18. Tank seal condition: Good or Poor	N/A
19. Date tank installed	1988
20. Tank modifications: Give date and describe	N/A
21. Is the tank equipped with a vapor recovery system? If yes, describe	No
22. Average wind velocity of the area (miles/hour)	7mph

FACILITY NAME Panther Chemical Co.  
 FACILITY ADDRESS P.O. Box 550, Clarksdale, MS 38614  
 TANK IDENTIFICATION NO./NAME

TS-11

1. Product stored; e.g. crude oil, gasoline, etc.	Cyclohexanone
2. True vapor pressure of product at storage temperature ( <del>PSIA/°F</del> ) (mmHg @ 38.7°C)	10
3. Reid vapor pressure of product at storage temperature (PSIA/°F)	N/A
4. Density of product stored at storage temperature (lbs/gal)	7.89
5. Molecular weight of product vapor at storage temperature lb/lb mole	N/A
6. Throughput for the most recent calendar year (gals/year)	155,600
7. Tank Capacity (gals)	20,000
8. Tank Diameter (feet)	3.8
9. Tank Height (feet)	24
10. Average Vapor Space Height (feet)	1.5
11. Tank Construction: Riveted or Welded	Welded
12. Type of Tank:	
Fixed Roof	✓
Floating Roof: External or Internal	
Variable Vapor Space	
Pressure	
Other, Describe	
13. For external floating roof tanks, Type Seals:	
Metallic shoe seal	
Primary seal only	N/A
With shoe mounted secondary seal	N/A
With rim mounted secondary seal	N/A
Liquid mounted resilient seal	
Primary seal only	N/A
With weather shield	N/A
With rim mounted secondary seal	N/A
Vapor mounted resilient seal	
Primary seal only	N/A
With weather shield	N/A
With rim mounted secondary seal	N/A

TANK IDENTIFICATION NO./NAME

TS-11

14. For internal floating roof tanks, Type Seals:	
Liquid mounted resilient seal	
<u>Primary seal only</u>	N/A
<u>With rim mounted secondary seal</u>	N/A
Vapor mounted resilient seal	
<u>Primary seal only</u>	N/A
<u>With rim mounted secondary seal</u>	N/A
Is the roof column supported? If yes, give	
a. <u>Number of columns</u>	N/A
b. <u>Column diameter (inches)</u>	N/A
15. Tank paint color; White, Aluminum (diffuse or specular), Light Gray, Medium Gray, Gray, Other (describe)	Aluminum (Diffuse)
16. Tank paint condition: Good or Poor	Good
17. Tank shell condition: Light rust, dense rust, gunite lined	Light Rust
18. Tank seal condition: Good or Poor	N/A
19. Date tank installed	1988
20. Tank modifications: Give date and describe	N/A
21. Is the tank equipped with a vapor recovery system? If yes, describe	No
22. Average wind velocity of the area (miles/hour)	7mph

FACILITY NAME Parther Chemical Co.  
 FACILITY ADDRESS P.O. Box 550, Clarksdale, MS 38614  
 TANK IDENTIFICATION NO./NAME

TS-12

1. Product stored; e.g. crude oil, gasoline, etc.	Empty
2. True vapor pressure of product at storage temperature (PSIA/°F)	N/A
3. Reid vapor pressure of product at storage temperature (PSIA/°F)	N/A
4. Density of product stored at storage temperature (lbs/gal)	N/A
5. Molecular weight of product vapor at storage temperature lb/lb mole	N/A
6. Throughput for the most recent calendar year (gals/year)	N/A
7. Tank Capacity (gals)	20,000
8. Tank Diameter (feet)	3.8
9. Tank Height (feet)	24
10. Average Vapor Space Height (feet)	N/A
11. Tank Construction: Riveted or Welded	Welded
12. Type of Tank:	
Fixed Roof	✓
Floating Roof: External or Internal	
Variable Vapor Space	
Pressure	
Other, Describe	
13. For external floating roof tanks, Type Seals:	
Metallic shoe seal	
Primary seal only	N/A
With shoe mounted secondary seal	N/A
With rim mounted secondary seal	N/A
Liquid mounted resilient seal	
Primary seal only	N/A
With weather shield	N/A
With rim mounted secondary seal	N/A
Vapor mounted resilient seal	
Primary seal only	N/A
With weather shield	N/A
With rim mounted secondary seal	N/A

TANK IDENTIFICATION NO./NAME

T5-12

14. For internal floating roof tanks, Type Seals:	
Liquid mounted resilient seal	
<u>Primary seal only</u>	N/A
<u>With rim mounted secondary seal</u>	N/A
Vapor mounted resilient seal	
<u>Primary seal only</u>	N/A
<u>With rim mounted secondary seal</u>	N/A
Is the roof column supported? If yes, give	
a. Number of columns	N/A
b. Column diameter (inches)	N/A
15. Tank paint color; White, Aluminum (diffuse or specular), Light Gray, Medium Gray, Gray, Other (describe)	Aluminum (Diffuse)
16. Tank paint condition: Good or Poor	Good
17. Tank shell condition: Light rust, dense rust, gunite lined	Light Rust
18. Tank seal condition: Good or Poor	N/A
19. Date tank installed	1988
20. Tank modifications: Give date and describe	N/A
21. Is the tank equipped with a vapor recovery system? If yes, describe	No
22. Average wind velocity of the area (miles/hour)	7 mph



FACILITY NAME Parther Chemical Co.  
 FACILITY ADDRESS P.O. Box 550, Clarksdale, MS 38644  
 TANK IDENTIFICATION NO./NAME

TS-13

1. Product stored; e.g. crude oil, gasoline, etc.	Waste
2. True vapor pressure of product at storage temperature (PSIA/°F)	N/A
3. Reid vapor pressure of product at storage temperature (PSIA/°F)	N/A
4. Density of product stored at storage temperature (lbs/gal)	N/A
5. Molecular weight of product vapor at storage temperature lb/lb mole	N/A
6. Throughput for the most recent calendar year (gals/year)	6,000
7. Tank Capacity (gals)	6,000
8. Tank Diameter (feet)	9.9
9. Tank Height (feet)	10.5
10. Average Vapor Space Height (feet)	3.0
11. Tank Construction: Riveted or Welded	Plastic
12. Type of Tank:	
Fixed Roof	✓
Floating Roof: External or Internal	
Variable Vapor Space	
Pressure	
Other, Describe	
13. For external floating roof tanks, Type Seals:	
Metallic shoe seal	
Primary seal only	N/A
With shoe mounted secondary seal	N/A
With rim mounted secondary seal	N/A
Liquid mounted resilient seal	
Primary seal only	N/A
With weather shield	N/A
With rim mounted secondary seal	N/A
Vapor mounted resilient seal	
Primary seal only	N/A
With weather shield	N/A
With rim mounted secondary seal	N/A

TANK IDENTIFICATION NO./NAME

TS-13

14. For internal floating roof tanks, Type Seals:	
Liquid mounted resilient seal	
<u>Primary seal only</u>	N/A
<u>With rim mounted secondary seal</u>	N/A
Vapor mounted resilient seal	
<u>Primary seal only</u>	N/A
<u>With rim mounted secondary seal</u>	N/A
Is the roof column supported? If yes, give	
a. Number of columns	N/A
b. Column diameter (inches)	N/A
15. Tank paint color; White, Aluminum (diffuse or specular), Light Gray, Medium Gray, Gray, Other (describe)	White
16. Tank paint condition: Good or Poor	Good
17. Tank shell condition: Light rust, dense rust, gunite lined	Plastic
18. Tank seal condition: Good or Poor	N/A
19. Date tank installed	1988
20. Tank modifications: Give date and describe	N/A
21. Is the tank equipped with a vapor recovery system? If yes, describe	No
22. Average wind velocity of the area (miles/hour)	7mph

FACILITY NAME Panther Chemical Co.  
 FACILITY ADDRESS P.O. Box 550, Clarksdale, MS 38614  
 TANK IDENTIFICATION NO./NAME

TS-14

1. Product stored; e.g. crude oil, gasoline, etc.	Vydate
2. True vapor pressure of product at storage temperature (PSIA/°F)	N/A
3. Reid vapor pressure of product at storage temperature (PSIA/°F)	N/A
4. Density of product stored at storage temperature (lbs/gal)	N/A
5. Molecular weight of product vapor at storage temperature lb/lb mole	N/A
6. Throughput for the most recent calendar year (gals/year)	5,000
7. Tank Capacity (gals)	20,000
8. Tank Diameter (feet)	3.8
9. Tank Height (feet)	24
10. Average Vapor Space Height (feet)	1.5
11. Tank Construction: Riveted or Welded	Welded
12. Type of Tank:	
Fixed Roof	✓
Floating Roof: External or Internal	
Variable Vapor Space	
Pressure	
Other, Describe	
13. For external floating roof tanks, Type Seals:	
Metallic shoe seal	
Primary seal only	N/A
With shoe mounted secondary seal	N/A
With rim mounted secondary seal	N/A
Liquid mounted resilient seal	
Primary seal only	N/A
With weather shield	N/A
With rim mounted secondary seal	N/A
Vapor mounted resilient seal	
Primary seal only	N/A
With weather shield	N/A
With rim mounted secondary seal	N/A

TANK IDENTIFICATION NO./NAME

TS-14

14. For internal floating roof tanks, Type Seals:	
Liquid mounted resilient seal	
<u>Primary seal only</u>	N/A
<u>With rim mounted secondary seal</u>	N/A
Vapor mounted resilient seal	
<u>Primary seal only</u>	N/A
<u>With rim mounted secondary seal</u>	N/A
Is the roof column supported? If yes, give	
a. Number of columns	N/A
b. Column diameter (inches)	N/A
15. Tank paint color; White, Aluminum (diffuse or specular), Light Gray, Medium Gray, Gray, Other (describe)	Gray
16. Tank paint condition: Good or Poor	Good
17. Tank shell condition: Light rust, dense rust, gunite lined	Stainless Steel
18. Tank seal condition: Good or Poor	N/A
19. Date tank installed	1988
20. Tank modifications: Give date and describe	N/A
21. Is the tank equipped with a vapor recovery system? If yes, describe	No
22. Average wind velocity of the area (miles/hour)	7mph

FACILITY NAME Red Feather Chemical Co  
 FACILITY ADDRESS PO. Box 550, Clarksdale, MS 38614

BULK STORAGE TANKS (LOADING/UNLOADING INFORMATION)

TN-01

Item No.	For Most Recent Calendar Year	1991
1.	Product transferred: crude oil, gasoline, etc.	MSMA
2.	Amount transferred (loading), gals/day	5,000
3.	Amount transferred (unloading), gals/day	N/A
4.	Amount transferred (pipe line), gals/day	80
5.	Bulk temperature of the product, °F	Ambient
6.	True vapor pressure of the product at storage temperature, psia	N/A
7.	Reid vapor pressure of the product, psia	N/A
8.	Molecular weight of the product, lb/lb mole	N/A
9.	Density of the product at bulk temperature (lbs/gal)	6.6
10.	Type of loading: vessel, barge, truck, other (specify)	Truck
11.	Type of filling: submerged, fill pipe splash filling, bottom filling, other (specify)	Bottom Filling
11a.	If submerged fill is used, what approximate percent is the fill pipe submerged	N/A
12.	Type of service: dedicated service to one product, vapor balance service, other (specify)	Dedicated Service to one product
13.	Is loading/unloading operation equipped with vapor recovery or other pollution control system (specify)	No
14.	Efficiency of vapor collection system	N/A
15.	For ships/barges; The arrival cargo true ullage (feet) prior to dockside discharge	N/A
16.	For ships/barges; compartment condition before cargo discharge: fully loaded or lightered/short-loaded	N/A
17.	For ships; ballast water (gallons)	N/A
18.	For ships/barges; Receiving vessel/tank conditions: Uncleaned, Ballasted, Cleaned, Gas-Freed	N/A
19.	For ships/barges; The previous cargo was: Volatile, Non-Volatile, other (specify)	N/A

FACILITY NAME Old Panther Chemical Co.  
 FACILITY ADDRESS P.O. Box 550, Clarkdale, MS 38614

BULK STORAGE TANKS (LOADING/UNLOADING INFORMATION)

TN-02

Item		
No.	For Most Recent Calendar Year	1991
1.	Product transferred: crude oil, gasoline, etc.	Caustic
2.	Amount transferred (loading), gals/day	3,000
3.	Amount transferred (unloading), gals/day	N/A
4.	Amount transferred (pipe line), gals/day	20
5.	Bulk temperature of the product, °F	Ambient
6.	True vapor pressure of the product at storage temperature, psia	6.3/104
7.	Reid vapor pressure of the product, psia	N/A
8.	Molecular weight of the product, lb/lb mole	N/A
9.	Density of the product at bulk temperature (lbs/gal)	12.82
10.	Type of loading: vessel, barge, truck, other (specify)	Truck
11.	Type of filling: submerged, fill pipe splash filling, bottom filling, other (specify)	Bottom Filling
11a.	If submerged fill is used, what approximate percent is the fill pipe submerged	N/A
12.	Type of service: dedicated service to one product, vapor balance service, other (specify)	Dedicated Service to One Product
13.	Is loading/unloading operation equipped with vapor recovery or other pollution control system (specify)	No
14.	Efficiency of vapor collection system	N/A
15.	For ships/barges; The arrival cargo true ullage (feet) prior to dockside discharge	N/A
16.	For ships/barges; compartment condition before cargo discharge: fully loaded or lightered/short-loaded	N/A
17.	For ships; ballast water (gallons)	N/A
18.	For ships/barges; Receiving vessel/tank conditions: Uncleaned, Ballasted, Cleaned, Gas-Freed	N/A
19.	For ships/barges; The previous cargo was: Volatile, Non-Volatile, other (specify)	N/A

FACILITY NAME R. Panther Chemical Co.  
 FACILITY ADDRESS P.O. Box 550, Clarksdale, MS 38644

BULK STORAGE TANKS (LOADING/UNLOADING INFORMATION)

TN-03

Item		
No.	For Most Recent Calendar Year	1991
1.	Product transferred: crude oil, gasoline, etc.	MSMA
2.	Amount transferred (loading), gals/day	5,000
3.	Amount transferred (unloading), gals/day	N/A
4.	Amount transferred (pipe line), gals/day	60
5.	Bulk temperature of the product, °F	Ambient
6.	True vapor pressure of the product at storage temperature, psia	N/A
7.	Reid vapor pressure of the product, psia	N/A
8.	Molecular weight of the product, lb/lb mole	N/A
9.	Density of the product at bulk temperature (lbs/gal)	6.6
10.	Type of loading: vessel, barge, truck, other (specify)	Truck
11.	Type of filling: submerged, fill pipe splash filling, bottom filling, other (specify)	Bottom Filling
11a.	If submerged fill is used, what approximate percent is the fill pipe submerged	N/A
12.	Type of service: dedicated service to one product, vapor balance service, other (specify)	Dedicated Service to one Product
13.	Is loading/unloading operation equipped with vapor recovery or other pollution control system (specify)	No
14.	Efficiency of vapor collection system	N/A
15.	For ships/barges; The arrival cargo true ullage (feet) prior to dockside discharge	N/A
16.	For ships/barges; compartment condition before cargo discharge: fully loaded or lightered/short-loaded	N/A
17.	For ships; ballast water (gallons)	N/A
18.	For ships/barges; Receiving vessel/tank conditions: Uncleaned, Ballasted, Cleaned, Gas-Freed	N/A
19.	For ships/barges; The previous cargo was: Volatile, Non-Volatile, other (specify)	N/A



FACILITY NAME R. Panther Chemical Co.  
 FACILITY ADDRESS P.O. Box 550, Clarksdale, MS 38614

BULK STORAGE TANKS (LOADING/UNLOADING INFORMATION)

TN-04

Item No.	For Most Recent Calendar Year	1991
1.	Product transferred: crude oil, gasoline, etc.	Orhex 796
2.	Amount transferred (loading), gals/day	3,000
3.	Amount transferred (unloading), gals/day	N/A
4.	Amount transferred (pipe line), gals/day	20
5.	Bulk temperature of the product, °F	Ambient
6.	True vapor pressure of the product at storage temperature, <del>psia</del> (mmHg @ 20°C)	< 0.01
7.	Reid vapor pressure of the product, psia	N/A
8.	Molecular weight of the product, lb/lb mole	≈ 330
9.	Density of the product at bulk temperature (lbs/gal)	7.07
10.	Type of loading: vessel, barge, truck, other (specify)	Truck
11.	Type of filling: submerged, fill pipe splash filling, bottom filling, other (specify)	Bottom Filling
11a.	If submerged fill is used, what approximate percent is the fill pipe submerged	N/A
12.	Type of service: dedicated service to one product, vapor balance service, other (specify)	Dedicated Service to One Product
13.	Is loading/unloading operation equipped with vapor recovery or other pollution control system (specify)	No
14.	Efficiency of vapor collection system	N/A
15.	For ships/barges; The arrival cargo true ullage (feet) prior to dockside discharge	N/A
16.	For ships/barges; compartment condition before cargo discharge: fully loaded or lightered/short-loaded	N/A
17.	For ships; ballast water (gallons)	N/A
18.	For ships/barges; Receiving vessel/tank conditions: Uncleaned, Ballasted, Cleaned, Gas-Freed	N/A
19.	For ships/barges; The previous cargo was: Volatile, Non-Volatile, other (specify)	N/A



FACILITY NAME P. J. Panther Chemical Co.  
 FACILITY ADDRESS P.O. Box 550, Clarksdale, MS 38614

BULK STORAGE TANKS (LOADING/UNLOADING INFORMATION)

TN-05

Item No.	For Most Recent Calendar Year	1991
1.	Product transferred: crude oil, gasoline, etc.	MSMA
2.	Amount transferred (loading), gals/day	5,000
3.	Amount transferred (unloading), gals/day	N/A
4.	Amount transferred (pipe line), gals/day	60
5.	Bulk temperature of the product, °F	Ambient
6.	True vapor pressure of the product at storage temperature, psia	N/A
7.	Reid vapor pressure of the product, psia	N/A
8.	Molecular weight of the product, lb/lb mole	N/A
9.	Density of the product at bulk temperature (lbs/gal)	6.6
10.	Type of loading: vessel, barge, truck, other (specify)	Truck
11.	Type of filling: submerged, fill pipe splash filling, bottom filling, other (specify)	Bottom Filling
11a.	If submerged fill is used, what approximate percent is the fill pipe submerged	N/A
12.	Type of service: dedicated service to one product, vapor balance service, other (specify)	Dedicated Service to One Product
13.	Is loading/unloading operation equipped with vapor recovery or other pollution control system (specify)	No
14.	Efficiency of vapor collection system	N/A
15.	For ships/barges; The arrival cargo true ullage (feet) prior to dockside discharge	N/A
16.	For ships/barges; compartment condition before cargo discharge: fully loaded or lightered/short-loaded	N/A
17.	For ships; ballast water (gallons)	N/A
18.	For ships/barges; Receiving vessel/tank conditions: Uncleaned, Ballasted, Cleaned, Gas-Freed	N/A
19.	For ships/barges; The previous cargo was: Volatile, Non-Volatile, other (specify)	N/A

FACILITY NAME Red Panther Chemical Co.  
 FACILITY ADDRESS P.O. Box 550, Clarksdale, MS 38614

BULK STORAGE TANKS (LOADING/UNLOADING INFORMATION)

TN-06

Item No.	For Most Recent Calendar Year	1991
1.	Product transferred: crude oil, gasoline, etc.	FloMo Low Form
2.	Amount transferred (loading), gals/day	5,000
3.	Amount transferred (unloading), gals/day	N/A
4.	Amount transferred (pipe line), gals/day	30
5.	Bulk temperature of the product, °F	Ambient
6.	True vapor pressure of the product at storage temperature, psia	N/A
7.	Reid vapor pressure of the product, psia	N/A
8.	Molecular weight of the product, lb/lb mole	N/A
9.	Density of the product at bulk temperature (lbs/gal)	8.4
10.	Type of loading: vessel, barge, truck, other (specify)	Truck
11.	Type of filling: submerged, fill pipe splash filling, bottom filling, other (specify)	Bottom Filling
11a.	If submerged fill is used, what approximate percent is the fill pipe submerged	N/A
12.	Type of service: dedicated service to one product, vapor balance service, other (specify)	Dedicated Service to one product
13.	Is loading/unloading operation equipped with vapor recovery or other pollution control system (specify)	No
14.	Efficiency of vapor collection system	N/A
15.	For ships/barges; The arrival cargo true ullage (feet) prior to dockside discharge	N/A
16.	For ships/barges; compartment condition before cargo discharge: fully loaded or lightered/short-loaded	N/A
17.	For ships; ballast water (gallons)	N/A
18.	For ships/barges; Receiving vessel/tank conditions: Uncleaned, Ballasted, Cleaned, Gas-Freed	N/A
19.	For ships/barges; The previous cargo was: Volatile, Non-Volatile, other (specify)	N/A

FACILITY NAME R. Panther Chemical Co.  
 FACILITY ADDRESS P.O. Box 550, Clarksdale, MS 38617

BULK STORAGE TANKS (LOADING/UNLOADING INFORMATION)

TN-07

Item No.	For Most Recent Calendar Year	1991
1.	Product transferred: crude oil, gasoline, etc.	Empty
2.	Amount transferred (loading), gals/day	N/A
3.	Amount transferred (unloading), gals/day	N/A
4.	Amount transferred (pipe line), gals/day	N/A
5.	Bulk temperature of the product, °F	N/A
6.	True vapor pressure of the product at storage temperature, psia	N/A
7.	Reid vapor pressure of the product, psia	N/A
8.	Molecular weight of the product, lb/lb mole	N/A
9.	Density of the product at bulk temperature (lbs/gal)	N/A
10.	Type of loading: vessel, barge, truck, other (specify)	N/A
11.	Type of filling: submerged, fill pipe splash filling, bottom filling, other (specify)	Bottom Filling
11a.	If submerged fill is used, what approximate percent is the fill pipe submerged	N/A
12.	Type of service: dedicated service to one product, vapor balance service, other (specify)	N/A
13.	Is loading/unloading operation equipped with vapor recovery or other pollution control system (specify)	N/A
14.	Efficiency of vapor collection system	N/A
15.	For ships/barges; The arrival cargo true ullage (feet) prior to dockside discharge	N/A
16.	For ships/barges; compartment condition before cargo discharge: fully loaded or lightered/short-loaded	N/A
17.	For ships; ballast water (gallons)	N/A
18.	For ships/barges; Receiving vessel/tank conditions: Uncleaned, Ballasted, Cleaned, Gas-Freed	N/A
19.	For ships/barges; The previous cargo was: Volatile, Non-Volatile, other (specify)	N/A

FACILITY NAME Red Panther Chemical Co.FACILITY ADDRESS P.O. Box 550, Clarksdale, MS 38617

## BULK STORAGE TANKS (LOADING/UNLOADING INFORMATION)

Page 8 of 36

TN-08

Item No.	For Most Recent Calendar Year	1991
1.	Product transferred: crude oil, gasoline, etc.	Vegetable Oil
2.	Amount transferred (loading), gals/day	5,000
3.	Amount transferred (unloading), gals/day	N/A
4.	Amount transferred (pipe line), gals/day	15
5.	Bulk temperature of the product, °F	Ambient
6.	True vapor pressure of the product at storage temperature, psia	N/A
7.	Reid vapor pressure of the product, psia	N/A
8.	Molecular weight of the product, lb/lb mole	N/A
9.	Density of the product at bulk temperature (lbs/gal)	N/A
10.	Type of loading: vessel, barge, truck, other (specify)	Truck
11.	Type of filling: submerged, fill pipe splash filling, bottom filling, other (specify)	Bottom Filling
11a.	If submerged fill is used, what approximate percent is the fill pipe submerged	N/A
12.	Type of service: dedicated service to one product, vapor balance service, other (specify)	Dedicated Service to One Product
13.	Is loading/unloading operation equipped with vapor recovery or other pollution control system (specify)	No
14.	Efficiency of vapor collection system	N/A
15.	For ships/barges; The arrival cargo true ullage (feet) prior to dockside discharge	N/A
16.	For ships/barges; compartment condition before cargo discharge: fully loaded or lightered/short-loaded	N/A
17.	For ships; ballast water (gallons)	N/A
18.	For ships/barges; Receiving vessel/tank conditions: Uncleaned, Ballasted, Cleaned, Gas-Freed	N/A
19.	For ships/barges; The previous cargo was: Volatile, Non-Volatile, other (specify)	N/A

FACILITY NAME Rea Leather Chemical Co.  
 FACILITY ADDRESS P.O. Box 550, Clarksdale, MS 38614

BULK STORAGE TANKS (LOADING/UNLOADING INFORMATION)

TN-09

Item No.	For Most Recent Calendar Year	1991
1.	Product transferred: crude oil, gasoline, etc.	MSMA
2.	Amount transferred (loading), gals/day	3,000
3.	Amount transferred (unloading), gals/day	N/A
4.	Amount transferred (pipe line), gals/day	40
5.	Bulk temperature of the product, °F	Ambient.
6.	True vapor pressure of the product at storage temperature, psia	N/A
7.	Reid vapor pressure of the product, psia	N/A
8.	Molecular weight of the product, lb/lb mole	N/A
9.	Density of the product at bulk temperature (lbs/gal)	6.6
10.	Type of loading: vessel, barge, truck, other (specify)	Truck
11.	Type of filling: submerged, fill pipe splash filling, bottom filling, other (specify)	Bottom Filling
11a.	If submerged fill is used, what approximate percent is the fill pipe submerged	N/A
12.	Type of service: dedicated service to one product, vapor balance service, other (specify)	Dedicated Service to one Product
13.	Is loading/unloading operation equipped with vapor recovery or other pollution control system (specify)	No
14.	Efficiency of vapor collection system	N/A
15.	For ships/barges; The arrival cargo true ullage (feet) prior to dockside discharge	N/A
16.	For ships/barges; compartment condition before cargo discharge: fully loaded or lightered/short-loaded	N/A
17.	For ships; ballast water (gallons)	N/A
18.	For ships/barges; Receiving vessel/tank conditions: Uncleaned, Ballasted, Cleaned, Gas-Freed	N/A
19.	For ships/barges; The previous cargo was: Volatile, Non-Volatile, other (specify)	N/A



FACILITY NAME Panther Chemical Co.  
 FACILITY ADDRESS P.O. Box 550, Clarksdale, MS 38614

BULK STORAGE TANKS (LOADING/UNLOADING INFORMATION)

TN-10

Item No.	For Most Recent Calendar Year	1991
1.	Product transferred: crude oil, gasoline, etc.	MSMA
2.	Amount transferred (loading), gals/day	3,000
3.	Amount transferred (unloading), gals/day	N/A
4.	Amount transferred (pipe line), gals/day	60
5.	Bulk temperature of the product, °F	Ambient
6.	True vapor pressure of the product at storage temperature, psia	N/A
7.	Reid vapor pressure of the product, psia	N/A
8.	Molecular weight of the product, lb/lb mole	N/A
9.	Density of the product at bulk temperature (lbs/gal)	6.6
10.	Type of loading: vessel, barge, truck, other (specify)	Truck
11.	Type of filling: submerged, fill pipe splash filling, bottom filling, other (specify)	Bottom Filling
11a.	If submerged fill is used, what approximate percent is the fill pipe submerged	N/A
12.	Type of service: dedicated service to one product, vapor balance service, other (specify)	Dedicated Service to One Product
13.	Is loading/unloading operation equipped with vapor recovery or other pollution control system (specify)	No
14.	Efficiency of vapor collection system	N/A
15.	For ships/barges; The arrival cargo true ullage (feet) prior to dockside discharge	N/A
16.	For ships/barges; compartment condition before cargo discharge: fully loaded or lightered/short-loaded	N/A
17.	For ships; ballast water (gallons)	N/A
18.	For ships/barges; Receiving vessel/tank conditions: Uncleaned, Ballasted, Cleaned, Gas-Freed	N/A
19.	For ships/barges; The previous cargo was: Volatile, Non-Volatile, other (specify)	N/A

FACILITY NAME Red Panther Chemical Co.  
 FACILITY ADDRESS PO, Box 550, Clarksdale, MS 38624

BULK STORAGE TANKS (LOADING/UNLOADING INFORMATION)

TN-11

Item No.	For Most Recent Calendar Year	1991
1.	Product transferred: crude oil, gasoline, etc.	MSMA
2.	Amount transferred (loading), gals/day	3,000
3.	Amount transferred (unloading), gals/day	N/A
4.	Amount transferred (pipe line), gals/day	60
5.	Bulk temperature of the product, °F	Ambient
6.	True vapor pressure of the product at storage temperature, psia	N/A
7.	Reid vapor pressure of the product, psia	N/A
8.	Molecular weight of the product, lb/lb mole	N/A
9.	Density of the product at bulk temperature (lbs/gal)	6.6
10.	Type of loading: vessel, barge, truck, other (specify)	Truck
11.	Type of filling: submerged, fill pipe splash filling, bottom filling, other (specify)	Bottom Filling
11a.	If submerged fill is used, what approximate percent is the fill pipe submerged	N/A
12.	Type of service: dedicated service to one product, vapor balance service, other (specify)	Dedicated Service to One Product
13.	Is loading/unloading operation equipped with vapor recovery or other pollution control system (specify)	No
14.	Efficiency of vapor collection system	N/A
15.	For ships/barges; The arrival cargo true ullage (feet) prior to dockside discharge	N/A
16.	For ships/barges; compartment condition before cargo discharge: fully loaded or lightered/short-loaded	N/A
17.	For ships; ballast water (gallons)	N/A
18.	For ships/barges; Receiving vessel/tank conditions: Uncleaned, Ballasted, Cleaned, Gas-Freed	N/A
19.	For ships/barges; The previous cargo was: Volatile, Non-Volatile, other (specify)	N/A

FACILITY NAME Re Panther Chemical Co.  
 FACILITY ADDRESS P.O. Box 550, Clarksdale, MS 38614

BULK STORAGE TANKS (LOADING/UNLOADING INFORMATION)

TN-12

Item No.	For Most Recent Calendar Year	1991
1.	Product transferred: crude oil, gasoline, etc.	Asana
2.	Amount transferred (loading), gals/day	3,000
3.	Amount transferred (unloading), gals/day	N/A
4.	Amount transferred (pipe line), gals/day	160
5.	Bulk temperature of the product, °F	Ambient
6.	True vapor pressure of the product at storage temperature, psia	N/A
7.	Reid vapor pressure of the product, psia	N/A
8.	Molecular weight of the product, lb/lb mole	N/A
9.	Density of the product at bulk temperature (lbs/gal)	7.99
10.	Type of loading: vessel, barge, truck, other (specify)	Truck
11.	Type of filling: submerged, fill pipe splash filling, bottom filling, other (specify)	Bottom Filling
11a.	If submerged fill is used, what approximate percent is the fill pipe submerged	N/A
12.	Type of service: dedicated service to one product, vapor balance service, other (specify)	Dedicated Service to One Product
13.	Is loading/unloading operation equipped with vapor recovery or other pollution control system (specify)	No
14.	Efficiency of vapor collection system	N/A
15.	For ships/barges; The arrival cargo true ullage (feet) prior to dockside discharge	N/A
16.	For ships/barges; compartment condition before cargo discharge: fully loaded or lightered/short-loaded	N/A
17.	For ships; ballast water (gallons)	N/A
18.	For ships/barges; Receiving vessel/tank conditions: Uncleaned, Ballasted, Cleaned, Gas-Freed	N/A
19.	For ships/barges; The previous cargo was: Volatile, Non-Volatile, other (specify)	N/A



FACILITY NAME Re Panther Chemical Co.  
 FACILITY ADDRESS P.O. Box 550, Clarksdale, MS 38614

BULK STORAGE TANKS (LOADING/UNLOADING INFORMATION)

TN-13

Item No.	For Most Recent Calendar Year	1991
1.	Product transferred: crude oil, gasoline, etc.	Asana
2.	Amount transferred (loading), gals/day	3,000
3.	Amount transferred (unloading), gals/day	N/A
4.	Amount transferred (pipe line), gals/day	160
5.	Bulk temperature of the product, °F	Ambient
6.	True vapor pressure of the product at storage temperature, psia	N/A
7.	Reid vapor pressure of the product, psia	N/A
8.	Molecular weight of the product, lb/lb mole	N/A
9.	Density of the product at bulk temperature (lbs/gal)	7.99
10.	Type of loading: vessel, barge, truck, other (specify)	Truck
11.	Type of filling: submerged, fill pipe splash filling, bottom filling, other (specify)	Bottom Filling
11a.	If submerged fill is used, what approximate percent is the fill pipe submerged	N/A
12.	Type of service: dedicated service to one product, vapor balance service, other (specify)	Dedicated Service to One Product
13.	Is loading/unloading operation equipped with vapor recovery or other pollution control system (specify)	No
14.	Efficiency of vapor collection system	N/A
15.	For ships/barges; The arrival cargo true ullage (feet) prior to dockside discharge	N/A
16.	For ships/barges; compartment condition before cargo discharge: fully loaded or lightered/short-loaded	N/A
17.	For ships; ballast water (gallons)	N/A
18.	For ships/barges; Receiving vessel/tank conditions: Uncleaned, Ballasted, Cleaned, Gas-Freed	N/A
19.	For ships/barges; The previous cargo was: Volatile, Non-Volatile, other (specify)	N/A

FACILITY NAME Re Panther Chemical Co.  
 FACILITY ADDRESS P.O. Box 550, Clarksdale, MS 38614

BULK STORAGE TANKS (LOADING/UNLOADING INFORMATION)

TN-14

Item	
No.	For Most Recent Calendar Year
	1991
1.	Product transferred: crude oil, gasoline, etc.
	Kerosene
2.	Amount transferred (loading), gals/day
	5,000
3.	Amount transferred (unloading), gals/day
	N/A
4.	Amount transferred (pipe line), gals/day
	15
5.	Bulk temperature of the product, °F
	Ambient
6.	True vapor pressure of the product at storage temperature, psia
	N/A
7.	Reid vapor pressure of the product, psia
	N/A
8.	Molecular weight of the product, lb/lb mole
	N/A
9.	Density of the product at bulk temperature (lbs/gal)
	N/A
10.	Type of loading: vessel, barge, truck, other (specify)
	Truck
11.	Type of filling: submerged, fill pipe splash filling, bottom filling, other (specify)
	Bottom Filling
11a.	If submerged fill is used, what approximate percent is the fill pipe submerged
	N/A
12.	Type of service: dedicated service to one product, vapor balance service, other (specify)
	Dedicated Service to One Product
13.	Is loading/unloading operation equipped with vapor recovery or other pollution control system (specify)
	No
14.	Efficiency of vapor collection system
	N/A
15.	For ships/barges; The arrival cargo true ullage (feet) prior to dockside discharge
	N/A
16.	For ships/barges; compartment condition before cargo discharge: fully loaded or lightered/short-loaded
	N/A
17.	For ships; ballast water (gallons)
	N/A
18.	For ships/barges; Receiving vessel/tank conditions: Uncleaned, Ballasted, Cleaned, Gas-Freed
	N/A
19.	For ships/barges; The previous cargo was: Volatile, Non-Volatile, other (specify)
	N/A

FACILITY NAME Re Panther Chemical Co.  
 FACILITY ADDRESS P.O. Box 550, Clarkdale, MS 38614

BULK STORAGE TANKS (LOADING/UNLOADING INFORMATION)

Page 15 of 36

TN-15

Item No.	For Most Recent Calendar Year	1991
1.	Product transferred: crude oil, gasoline, etc.	F10 M0125%
2.	Amount transferred (loading), gals/day	5,000
3.	Amount transferred (unloading), gals/day	N/A
4.	Amount transferred (pipe line), gals/day	15
5.	Bulk temperature of the product, °F	Ambient
6.	True vapor pressure of the product at storage temperature, psia	N/A
7.	Reid vapor pressure of the product, psia	N/A
8.	Molecular weight of the product, lb/lb mole	N/A
9.	Density of the product at bulk temperature (lbs/gal)	7.95
10.	Type of loading: vessel, barge, truck, other (specify)	Truck
11.	Type of filling: submerged, fill pipe splash filling, bottom filling, other (specify)	Bottom Filling
11a.	If submerged fill is used, what approximate percent is the fill pipe submerged	N/A
12.	Type of service: dedicated service to one product, vapor balance service, other (specify)	Dedicated Service to One Product
13.	Is loading/unloading operation equipped with vapor recovery or other pollution control system (specify)	No
14.	Efficiency of vapor collection system	N/A
15.	For ships/barges; The arrival cargo true ullage (feet) prior to dockside discharge	1 1/2
16.	For ships/barges; compartment condition before cargo discharge: fully loaded or lightered/short-loaded	N/A
17.	For ships; ballast water (gallons)	N/A
18.	For ships/barges; Receiving vessel/tank conditions: Uncleaned, Ballasted, Cleaned, Gas-Freed	N/A
19.	For ships/barges; The previous cargo was: Volatile, Non-Volatile, other (specify)	N/A

FACILITY NAME R Panther Chemical Co.

FACILITY ADDRESS P.O. Box 550, Clarksdale, MS 38614

BULK STORAGE TANKS (LOADING/UNLOADING INFORMATION)

TN-16

Page 16 of 36

Item No.	For Most Recent Calendar Year	1991
1.	Product transferred: crude oil, gasoline, etc.	Armul CBJD
2.	Amount transferred (loading), gals/day	5,000
3.	Amount transferred (unloading), gals/day	N/A
4.	Amount transferred (pipe line), gals/day	30
5.	Bulk temperature of the product, °F	Ambient
6.	True vapor pressure of the product at storage temperature, psia	N/A
7.	Reid vapor pressure of the product, psia	N/A
8.	Molecular weight of the product, lb/lb mole	N/A
9.	Density of the product at bulk temperature (lbs/gal)	8.4
10.	Type of loading: vessel, barge, truck, other (specify)	Truck
11.	Type of filling: submerged, fill pipe splash filling, bottom filling, other (specify)	Bottom Filling
11a.	If submerged fill is used, what approximate percent is the fill pipe submerged	N/A
12.	Type of service: dedicated service to one product, vapor balance service, other (specify)	Dedicated Service to One Product
13.	Is loading/unloading operation equipped with vapor recovery or other pollution control system (specify)	No
14.	Efficiency of vapor collection system	N/A
15.	For ships/barges; The arrival cargo true ullage (feet) prior to dockside discharge	N/A
16.	For ships/barges; compartment condition before cargo discharge: fully loaded or lightered/short-loaded	N/A
17.	For ships; ballast water (gallons)	N/A
18.	For ships/barges; Receiving vessel/tank conditions: Uncleaned, Ballasted, Cleaned, Gas-Freed	N/A
19.	For ships/barges; The previous cargo was: Volatile, Non-Volatile, other (specify)	N/A

FACILITY NAME Re Panther Chemical Co.  
 FACILITY ADDRESS P.O. Box 550, Clarksdale, MS 38614

BULK STORAGE TANKS (LOADING/UNLOADING INFORMATION)

TN-17

Item No.	For Most Recent Calendar Year	1991
1.	Product transferred: crude oil, gasoline, etc.	Methanol
2.	Amount transferred (loading), gals/day	5,000
3.	Amount transferred (unloading), gals/day	N/A
4.	Amount transferred (pipe line), gals/day	110
5.	Bulk temperature of the product, °F	Ambient
6.	True vapor pressure of the product at storage temperature, <del>psia</del> mmHg @ 20°C	96
7.	Reid vapor pressure of the product, psia	N/A
8.	Molecular weight of the product, lb/lb mole	N/A
9.	Density of the product at bulk temperature (lbs/gal)	6.5
10.	Type of loading: vessel, barge, truck, other (specify)	Truck
11.	Type of filling: submerged, fill pipe splash filling, bottom filling, other (specify)	Bottom Filling
11a.	If submerged fill is used, what approximate percent is the fill pipe submerged	N/A
12.	Type of service: dedicated service to one product, vapor balance service, other (specify)	Dedicated Service to One Product
13.	Is loading/unloading operation equipped with vapor recovery or other pollution control system (specify)	No
14.	Efficiency of vapor collection system	N/A
15.	For ships/barges; The arrival cargo true ullage (feet) prior to dockside discharge	N/A
16.	For ships/barges; compartment condition before cargo discharge: fully loaded or lightered/short-loaded	N/A
17.	For ships; ballast water (gallons)	N/A
18.	For ships/barges; Receiving vessel/tank conditions: Uncleaned, Ballasted, Cleaned, Gas-Freed	N/A
19.	For ships/barges; The previous cargo was: Volatile, Non-Volatile, other (specify)	N/A



FACILITY NAME Re Panther Chemical Co.  
 FACILITY ADDRESS P.O. Box 550, Clarksdale, MS 38614.

BULK STORAGE TANKS (LOADING/UNLOADING INFORMATION)

TN-18

Item No.	For Most Recent Calendar Year	1991
1.	Product transferred: crude oil, gasoline, etc.	Ethanol
2.	Amount transferred (loading), gals/day	3,000
3.	Amount transferred (unloading), gals/day	N/A
4.	Amount transferred (pipe line), gals/day	20
5.	Bulk temperature of the product, °F	Ambient
6.	True vapor pressure of the product at storage temperature, <del>psia</del> (mm Hg @ 20°C)	21
7.	Reid vapor pressure of the product, psia	N/A
8.	Molecular weight of the product, lb/lb mole	N/A
9.	Density of the product at bulk temperature (lbs/gal)	
10.	Type of loading: vessel, barge, truck, other (specify)	Truck
11.	Type of filling: submerged, fill pipe splash filling, bottom filling, other (specify)	Bottom Filling
11a.	If submerged fill is used, what approximate percent is the fill pipe submerged	N/A
12.	Type of service: dedicated service to one product, vapor balance service, other (specify)	Dedicated Service to One Product
13.	Is loading/unloading operation equipped with vapor recovery or other pollution control system (specify)	No
14.	Efficiency of vapor collection system	N/A
15.	For ships/barges; The arrival cargo true ullage (feet) prior to dockside discharge	N/A
16.	For ships/barges; compartment condition before cargo discharge: fully loaded or lightered/short-loaded	N/A
17.	For ships; ballast water (gallons)	N/A
18.	For ships/barges; Receiving vessel/tank conditions: Uncleaned, Ballasted, Cleaned, Gas-Freed	N/A
19.	For ships/barges; The previous cargo was: Volatile, Non-Volatile, other (specify)	N/A

FACILITY NAME R Panther Chemical Co.  
 FACILITY ADDRESS P.O. Box 550, Clarksdale, MS 38614

BULK STORAGE TANKS (LOADING/UNLOADING INFORMATION)

TN-19

Item No.	For Most Recent Calendar Year	1991
1.	Product transferred: crude oil, gasoline, etc.	Ethylene Glycol
2.	Amount transferred (loading), gals/day	5,000
3.	Amount transferred (unloading), gals/day	N/A
4.	Amount transferred (pipe line), gals/day	30
5.	Bulk temperature of the product, °F	Ambient
6.	True vapor pressure of the product at storage temperature, psia (mm Hg @ 20°C)	0.08
7.	Reid vapor pressure of the product, psia	N/A
8.	Molecular weight of the product, lb/lb mole	N/A
9.	Density of the product at bulk temperature (lbs/gal)	9.28
10.	Type of loading: vessel, barge, truck, other (specify)	Truck
11.	Type of filling: submerged, fill pipe splash filling, bottom filling, other (specify)	Bottom Filling
11a.	If submerged fill is used, what approximate percent is the fill pipe submerged	N/A
12.	Type of service: dedicated service to one product, vapor balance service, other (specify)	Dedicated Service to One Product
13.	Is loading/unloading operation equipped with vapor recovery or other pollution control system (specify)	No
14.	Efficiency of vapor collection system	N/A
15.	For ships/barges; The arrival cargo true ullage (feet) prior to dockside discharge	N/A
16.	For ships/barges; compartment condition before cargo discharge: fully loaded or lightered/short-loaded	N/A
17.	For ships; ballast water (gallons)	N/A
18.	For ships/barges; Receiving vessel/tank conditions: Uncleaned, Ballasted, Cleaned, Gas-Freed	N/A
19.	For ships/barges; The previous cargo was: Volatile, Non-Volatile, other (specify)	N/A

FACILITY NAME Re Panther Chemical Co.  
 FACILITY ADDRESS P.O. Box 550, Clarksdale MS 38614

BULK STORAGE TANKS (LOADING/UNLOADING INFORMATION)

TN-20

Item No.	For Most Recent Calendar Year	1991
1.	Product transferred: crude oil, gasoline, etc.	Aromatic 100
2.	Amount transferred (loading), gals/day	5,000
3.	Amount transferred (unloading), gals/day	N/A
4.	Amount transferred (pipe line), gals/day	30
5.	Bulk temperature of the product, °F	Ambient
6.	True vapor pressure of the product at storage temperature, <del>psia</del> (mmHg/°F)	≈ 10/100
7.	Reid vapor pressure of the product, psia	N/A
8.	Molecular weight of the product, lb/lb mole	N/A
9.	Density of the product at bulk temperature (lbs/gal)	7.3
10.	Type of loading: vessel, barge, truck, other (specify)	Truck
11.	Type of filling: submerged, fill pipe splash filling, bottom filling, other (specify)	Bottom Filling
11a.	If submerged fill is used, what approximate percent is the fill pipe submerged	N/A
12.	Type of service: dedicated service to one product, vapor balance service, other (specify)	Dedicated Service to One Product
13.	Is loading/unloading operation equipped with vapor recovery or other pollution control system (specify)	No
14.	Efficiency of vapor collection system	N/A
15.	For ships/barges; The arrival cargo true ullage (feet) prior to dockside discharge	N/A
16.	For ships/barges; compartment condition before cargo discharge: fully loaded or lightered/short-loaded	N/A
17.	For ships; ballast water (gallons)	N/A
18.	For ships/barges; Receiving vessel/tank conditions: Uncleaned, Ballasted, Cleaned, Gas-Freed	N/A
19.	For ships/barges; The previous cargo was: Volatile, Non-Volatile, other (specify)	N/A



FACILITY NAME Red Antler Chemical Co.  
 FACILITY ADDRESS P.O. Box 550, Clarksdale, MS 38614

BULK STORAGE TANKS (LOADING/UNLOADING INFORMATION)

TN-21

Item No.	For Most Recent Calendar Year	1991
1.	Product transferred: crude oil, gasoline, etc.	Aromatic 200
2.	Amount transferred (loading), gals/day	5,000
3.	Amount transferred (unloading), gals/day	N/A
4.	Amount transferred (pipe line), gals/day	30
5.	Bulk temperature of the product, °F	Ambient
6.	True vapor pressure of the product at storage temperature, <del>psia</del> (mm.Hg @ 25°C)	< 2
7.	Reid vapor pressure of the product, psia	N/A
8.	Molecular weight of the product, lb/lb mole	1166
9.	Density of the product at bulk temperature (lbs/gal)	8.2
10.	Type of loading: vessel, barge, truck, other (specify)	Truck
11.	Type of filling: submerged, fill pipe splash filling, bottom filling, other (specify)	Bottom Filling
11a.	If submerged fill is used, what approximate percent is the fill pipe submerged	N/A
12.	Type of service: dedicated service to one product, vapor balance service, other (specify)	Dedicated Service to One Product
13.	Is loading/unloading operation equipped with vapor recovery or other pollution control system (specify)	No
14.	Efficiency of vapor collection system	N/A
15.	For ships/barges; The arrival cargo true ullage (feet) prior to dockside discharge	N/A
16.	For ships/barges; compartment condition before cargo discharge: fully loaded or lightered/short-loaded	N/A
17.	For ships; ballast water (gallons)	N/A
18.	For ships/barges; Receiving vessel/tank conditions: Uncleaned, Ballasted, Cleaned, Gas-Freed	N/A
19.	For ships/barges; The previous cargo was: Volatile, Non-Volatile, other (specify)	N/A

FACILITY NAME Red Her Chemical Co.  
 FACILITY ADDRESS P.O. Box 550, Clarksdale, MS 38614

BULK STORAGE TANKS (LOADING/UNLOADING INFORMATION)

TN-22

Item No.	For Most Recent Calendar Year	1991
1.	Product transferred: crude oil, gasoline, etc.	Chloronil 500
2.	Amount transferred (loading), gals/day	2,000
3.	Amount transferred (unloading), gals/day	N/A
4.	Amount transferred (pipe line), gals/day	160
5.	Bulk temperature of the product, °F	Ambient
6.	True vapor pressure of the product at storage temperature, psia	5.72
7.	Reid vapor pressure of the product, psia	N/A
8.	Molecular weight of the product, lb/lb mole	N/A
9.	Density of the product at bulk temperature (lbs/gal)	10.32
10.	Type of loading: vessel, barge, truck, other (specify)	Truck
11.	Type of filling: submerged, fill pipe splash filling, bottom filling, other (specify)	Bottom Filling
11a.	If submerged fill is used, what approximate percent is the fill pipe submerged	N/A
12.	Type of service: dedicated service to one product, vapor balance service, other (specify)	Dedicated Service to One Product
13.	Is loading/unloading operation equipped with vapor recovery or other pollution control system (specify)	No
14.	Efficiency of vapor collection system	N/A
15.	For ships/barges; The arrival cargo true ullage (feet) prior to dockside discharge	N/A
16.	For ships/barges; compartment condition before cargo discharge: fully loaded or lightered/short-loaded	N/A
17.	For ships; ballast water (gallons)	N/A
18.	For ships/barges; Receiving vessel/tank conditions: Uncleaned, Ballasted, Cleaned, Gas-Freed	N/A
19.	For ships/barges; The previous cargo was: Volatile, Non-Volatile, other (specify)	N/A

FACILITY NAME Re Panther Chemical Co.  
 FACILITY ADDRESS P.O. Box 550, Clarksdale, MS 38614

BULK STORAGE TANKS (LOADING/UNLOADING INFORMATION)

TS-01

Page 23 of 36

Item No.	Description	Value
	For Most Recent Calendar Year	1991
1.	Product transferred: crude oil, gasoline, etc.	Allox 3404 F
2.	Amount transferred (loading), gals/day	3,000
3.	Amount transferred (unloading), gals/day	N/A
4.	Amount transferred (pipe line), gals/day	5
5.	Bulk temperature of the product, °F	Ambient
6.	True vapor pressure of the product at storage temperature, <del>psia</del> (mm Hg @ 20°C)	92
7.	Reid vapor pressure of the product, psia	N/A
8.	Molecular weight of the product, lb/lb mole	N/A
9.	Density of the product at bulk temperature (lbs/gal)	8.7
10.	Type of loading: vessel, barge, truck, other (specify)	Truck
11.	Type of filling: submerged, fill pipe splash filling, bottom filling, other (specify)	Bottom Filling
11a.	If submerged fill is used, what approximate percent is the fill pipe submerged	N/A
12.	Type of service: dedicated service to one product, vapor balance service, other (specify)	Dedicated Service to One Product
13.	Is loading/unloading operation equipped with vapor recovery or other pollution control system (specify)	No
14.	Efficiency of vapor collection system	N/A
15.	For ships/barges; The arrival cargo true ullage (feet) prior to dockside discharge	N/A
16.	For ships/barges; compartment condition before cargo discharge: fully loaded or lightered/short-loaded	N/A
17.	For ships; ballast water (gallons)	N/A
18.	For ships/barges; Receiving vessel/tank conditions: Uncleaned, Ballasted, Cleaned, Gas-Freed	N/A
19.	For ships/barges; The previous cargo was: Volatile, Non-Volatile, other (specify)	N/A

FACILITY NAME Red Panther Chemical Co.

FACILITY ADDRESS P.O. Box 550, Clarksdale, MS 38644.

BULK STORAGE TANKS (LOADING/UNLOADING INFORMATION)

TS-02

Item No.	For Most Recent Calendar Year	
1.	Product transferred: crude oil, gasoline, etc.	1991 Atlox 3403 F
2.	Amount transferred (loading), gals/day	3,000
3.	Amount transferred (unloading), gals/day	N/A
4.	Amount transferred (pipe line), gals/day	5
5.	Bulk temperature of the product, °F	Ambient
6.	True vapor pressure of the product at storage temperature, psia	N/A
7.	Reid vapor pressure of the product, psia	N/A
8.	Molecular weight of the product, lb/lb mole	N/A
9.	Density of the product at bulk temperature (lbs/gal)	8.5
10.	Type of loading: vessel, barge, truck, other (specify)	Truck
11.	Type of filling: submerged, fill pipe splash filling, bottom filling, other (specify)	Bottom Filling
11a.	If submerged fill is used, what approximate percent is the fill pipe submerged	N/A
12.	Type of service: dedicated service to one product, vapor balance service, other (specify)	Dedicated Service to One Product
13.	Is loading/unloading operation equipped with vapor recovery or other pollution control system (specify)	No
14.	Efficiency of vapor collection system	N/A
15.	For ships/barges; The arrival cargo true ullage (feet) prior to dockside discharge	N/A
16.	For ships/barges; compartment condition before cargo discharge: fully loaded or lightered/short-loaded	N/A
17.	For ships; ballast water (gallons)	N/A
18.	For ships/barges; Receiving vessel/tank conditions: Uncleaned, Ballasted, Cleaned, Gas-Freed	N/A
19.	For ships/barges; The previous cargo was: Volatile, Non-Volatile, other (specify)	N/A

FACILITY NAME Red Panther Chemical Co.FACILITY ADDRESS P.O. Box 550, Clarksdale, MS 38614

## BULK STORAGE TANKS (LOADING/UNLOADING INFORMATION)

TS-03

Page 25 of 36

Item No.	For Most Recent Calendar Year	1991
1.	Product transferred: crude oil, gasoline, etc.	Cythion
2.	Amount transferred (loading), gals/day	3,000
3.	Amount transferred (unloading), gals/day	N/A
4.	Amount transferred (pipe line), gals/day	11
5.	Bulk temperature of the product, °F	Ambient
6.	True vapor pressure of the product at storage temperature, psia	.0.00004
7.	Reid vapor pressure of the product, psia	N/A
8.	Molecular weight of the product, lb/lb mole	N/A
9.	Density of the product at bulk temperature (lbs/gal)	8.9
10.	Type of loading: vessel, barge, truck, other (specify)	Truck
11.	Type of filling: submerged, fill pipe splash filling, bottom filling, other (specify)	Bottom Filling
11a.	If submerged fill is used, what approximate percent is the fill pipe submerged	N/A
12.	Type of service: dedicated service to one product, vapor balance service, other (specify)	Dedicated Service to One Product
13.	Is loading/unloading operation equipped with vapor recovery or other pollution control system (specify)	No
14.	Efficiency of vapor collection system	N/A
15.	For ships/barges; The arrival cargo true ullage (feet) prior to dockside discharge	N/A
16.	For ships/barges; compartment condition before cargo discharge: fully loaded or lightered/short-loaded	N/A
17.	For ships; ballast water (gallons)	N/A
18.	For ships/barges; Receiving vessel/tank conditions: Uncleaned, Ballasted, Cleaned, Gas-Freed	N/A
19.	For ships/barges; The previous cargo was: Volatile, Non-Volatile, other (specify)	N/A



FACILITY NAME Red Panther Chemical Co.  
 FACILITY ADDRESS P.O. Box 550, Clarksdale, MS 38614

BULK STORAGE TANKS (LOADING/UNLOADING INFORMATION)

TS-04

Page 26 of 36

Item No.	For Most Recent Calendar Year	1991
1.	Product transferred: crude oil, gasoline, etc.	Methanol
2.	Amount transferred (loading), gals/day	3,000
3.	Amount transferred (unloading), gals/day	N/A
4.	Amount transferred (pipe line), gals/day	460
5.	Bulk temperature of the product, °F	Ambient
6.	True vapor pressure of the product at storage temperature, <del>psia</del> (mmHg @ 20°C)	96
7.	Reid vapor pressure of the product, psia	N/A
8.	Molecular weight of the product, lb/lb mole	N/A
9.	Density of the product at bulk temperature (lbs/gal)	6.5
10.	Type of loading: vessel, barge, truck, other (specify)	Truck
11.	Type of filling: submerged, fill pipe splash filling, bottom filling, other (specify)	Bottom Filling
11a.	If submerged fill is used, what approximate percent is the fill pipe submerged	N/A
12.	Type of service: dedicated service to one product, vapor balance service, other (specify)	Dedicated Service to One Product
13.	Is loading/unloading operation equipped with vapor recovery or other pollution control system (specify)	No
14.	Efficiency of vapor collection system	N/A
15.	For ships/barges; The arrival cargo true ullage (feet) prior to dockside discharge	N/A
16.	For ships/barges; compartment condition before cargo discharge: fully loaded or lightered/short-loaded	N/A
17.	For ships; ballast water (gallons)	N/A
18.	For ships/barges; Receiving vessel/tank conditions: Uncleaned, Ballasted, Cleaned, Gas-Freed	N/A
19.	For ships/barges; The previous cargo was: Volatile, Non-Volatile, other (specify)	N/A

FACILITY NAME Red Panther Chemical Co.  
 FACILITY ADDRESS P.O. Box 550, Clarksdale, MS 38614

BULK STORAGE TANKS (LOADING/UNLOADING INFORMATION)

TS-05

Item No.	For Most Recent Calendar Year	1991
1.	Product transferred: crude oil, gasoline, etc.	Southern Oil
2.	Amount transferred (loading), gals/day	5,000
3.	Amount transferred (unloading), gals/day	N/A
4.	Amount transferred (pipe line), gals/day	15
5.	Bulk temperature of the product, °F	Ambient
6.	True vapor pressure of the product at storage temperature, psia	N/A
7.	Reid vapor pressure of the product, psia	N/A
8.	Molecular weight of the product, lb/lb mole	N/A
9.	Density of the product at bulk temperature (lbs/gal)	N/A
10.	Type of loading: vessel, barge, truck, other (specify)	Truck
11.	Type of filling: submerged, fill pipe splash filling, bottom filling, other (specify)	Bottom Filling
11a.	If submerged fill is used, what approximate percent is the fill pipe submerged	N/A
12.	Type of service: dedicated service to one product, vapor balance service, other (specify)	Dedicated Service to One Product
13.	Is loading/unloading operation equipped with vapor recovery or other pollution control system (specify)	No
14.	Efficiency of vapor collection system	N/A
15.	For ships/barges; The arrival cargo true ullage (feet) prior to dockside discharge	N/A
16.	For ships/barges; compartment condition before cargo discharge: fully loaded or lightered/short-loaded	N/A
17.	For ships; ballast water (gallons)	N/A
18.	For ships/barges; Receiving vessel/tank conditions: Uncleaned, Ballasted, Cleaned, Gas-Freed	N/A
19.	For ships/barges; The previous cargo was: Volatile, Non-Volatile, other (specify)	N/A

FACILITY NAME Red Oxher Chemical Co.

FACILITY ADDRESS P.O. Box 550, Clarksville, MS 38614

BULK STORAGE TANKS (LOADING/UNLOADING INFORMATION)

TS-06

Item No.	For Most Recent Calendar Year	1991
1.	Product transferred: crude oil, gasoline, etc.	Cyflion RTU
2.	Amount transferred (loading), gals/day	0
3.	Amount transferred (unloading), gals/day	N/A
4.	Amount transferred (pipe line), gals/day	0
5.	Bulk temperature of the product, °F	Ambient
6.	True vapor pressure of the product at storage temperature, psia	0.00004
7.	Reid vapor pressure of the product, psia	N/A
8.	Molecular weight of the product, lb/lb mole	N/A
9.	Density of the product at bulk temperature (lbs/gal)	8.9
10.	Type of loading: vessel, barge, truck, other (specify)	Truck
11.	Type of filling: submerged, fill pipe splash filling, bottom filling, other (specify)	Bottom Filling
11a.	If submerged fill is used, what approximate percent is the fill pipe submerged	N/A
12.	Type of service: dedicated service to one product, vapor balance service, other (specify)	Dedicated Service to One Product
13.	Is loading/unloading operation equipped with vapor recovery or other pollution control system (specify)	No
14.	Efficiency of vapor collection system	N/A
15.	For ships/barges; The arrival cargo true ullage (feet) prior to dockside discharge	N/A
16.	For ships/barges; compartment condition before cargo discharge: fully loaded or lightered/short-loaded	N/A
17.	For ships; ballast water (gallons)	N/A
18.	For ships/barges; Receiving vessel/tank conditions: Uncleaned, Ballasted, Cleaned, Gas-Freed	N/A
19.	For ships/barges; The previous cargo was: Volatile, Non-Volatile, other (specify)	N/A



FACILITY NAME Red Antler Chemical Co.  
 FACILITY ADDRESS P.O. Box 550, Clarksdale, MS 38624

BULK STORAGE TANKS (LOADING/UNLOADING INFORMATION)

TS-07

Item No.	For Most Recent Calendar Year	1991
1.	Product transferred: crude oil, gasoline, etc.	Empty
2.	Amount transferred (loading), gals/day	N/A
3.	Amount transferred (unloading), gals/day	N/A
4.	Amount transferred (pipe line), gals/day	N/A
5.	Bulk temperature of the product, °F	N/A
6.	True vapor pressure of the product at storage temperature, psia	N/A
7.	Reid vapor pressure of the product, psia	N/A
8.	Molecular weight of the product, lb/lb mole	N/A
9.	Density of the product at bulk temperature (lbs/gal)	N/A
10.	Type of loading: vessel, barge, truck, other (specify)	N/A
11.	Type of filling: submerged, fill pipe splash filling, bottom filling, other (specify)	Bottom Filling
11a.	If submerged fill is used, what approximate percent is the fill pipe submerged	N/A
12.	Type of service: dedicated service to one product, vapor balance service, other (specify)	N/A
13.	Is loading/unloading operation equipped with vapor recovery or other pollution control system (specify)	No
14.	Efficiency of vapor collection system	N/A
15.	For ships/barges; The arrival cargo true ullage (feet) prior to dockside discharge	N/A
16.	For ships/barges; compartment condition before cargo discharge: fully loaded or lightered/short-loaded	N/A
17.	For ships; ballast water (gallons)	N/A
18.	For ships/barges; Receiving vessel/tank conditions: Uncleaned, Ballasted, Cleaned, Gas-Freed	N/A
19.	For ships/barges; The previous cargo was: Volatile, Non-Volatile, other (specify)	N/A

FACILITY NAME Red Panther Chemical Co.

FACILITY ADDRESS P.O. Box 550, Clarksdale, MS 38614

BULK STORAGE TANKS (LOADING/UNLOADING INFORMATION)

TS-08

Item No.	For Most Recent Calendar Year	1991
1.	Product transferred: crude oil, gasoline, etc.	TS00/100
2.	Amount transferred (loading), gals/day	3,000
3.	Amount transferred (unloading), gals/day	N/A
4.	Amount transferred (pipe line), gals/day	70
5.	Bulk temperature of the product, °F	Ambient
6.	True vapor pressure of the product at storage temperature, <del>psia</del> (mmHg @ 20°C)	0.2
7.	Reid vapor pressure of the product, psia	N/A
8.	Molecular weight of the product, lb/lb mole	N/A
9.	Density of the product at bulk temperature (lbs/gal)	7.24
10.	Type of loading: vessel, barge, truck, other (specify)	Truck
11.	Type of filling: submerged, fill pipe splash filling, bottom filling, other (specify)	Bottom Filling
11a.	If submerged fill is used, what approximate percent is the fill pipe submerged	N/A
12.	Type of service: dedicated service to one product, vapor balance service, other (specify)	Dedicated Service to One Product
13.	Is loading/unloading operation equipped with vapor recovery or other pollution control system (specify)	No
14.	Efficiency of vapor collection system	N/A
15.	For ships/barges; The arrival cargo true ullage (feet) prior to dockside discharge	N/A
16.	For ships/barges; compartment condition before cargo discharge: fully loaded or lightered/short-loaded	N/A
17.	For ships; ballast water (gallons)	N/A
18.	For ships/barges; Receiving vessel/tank conditions: Uncleaned, Ballasted, Cleaned, Gas-Freed	N/A
19.	For ships/barges; The previous cargo was: Volatile, Non-Volatile, other (specify)	N/A

FACILITY NAME Red Panther Chemical Co.  
 FACILITY ADDRESS P.O. Box 550, Clarksdale, MS 38614

BULK STORAGE TANKS (LOADING/UNLOADING INFORMATION)

TS-09

Item No.	For Most Recent Calendar Year	1991
1.	Product transferred: crude oil, gasoline, etc.	Empty
2.	Amount transferred (loading), gals/day	N/A
3.	Amount transferred (unloading), gals/day	N/A
4.	Amount transferred (pipe line), gals/day	N/A
5.	Bulk temperature of the product, °F	N/A
6.	True vapor pressure of the product at storage temperature, psia	N/A
7.	Reid vapor pressure of the product, psia	N/A
8.	Molecular weight of the product, lb/lb mole	N/A
9.	Density of the product at bulk temperature (lbs/gal)	N/A
10.	Type of loading: vessel, barge, truck, other (specify)	N/A
11.	Type of filling: submerged, fill pipe splash filling, bottom filling, other (specify)	Bottom Filling
11a.	If submerged fill is used, what approximate percent is the fill pipe submerged	N/A
12.	Type of service: dedicated service to one product, vapor balance service, other (specify)	N/A
13.	Is loading/unloading operation equipped with vapor recovery or other pollution control system (specify)	No
14.	Efficiency of vapor collection system	N/A
15.	For ships/barges; The arrival cargo true ullage (feet) prior to dockside discharge	N/A
16.	For ships/barges; compartment condition before cargo discharge: fully loaded or lightered/short-loaded	N/A
17.	For ships; ballast water (gallons)	N/A
18.	For ships/barges; Receiving vessel/tank conditions: Uncleaned, Ballasted, Cleaned, Gas-Freed	N/A
19.	For ships/barges; The previous cargo was: Volatile, Non-Volatile, other (specify)	N/A

FACILITY NAME Redd's Other Chemical Co.  
 FACILITY ADDRESS P.O. Box 550, Clarksdale, MS 38614

BULK STORAGE TANKS (LOADING/UNLOADING INFORMATION)

TS-10

Item No.	For Most Recent Calendar Year	1991
1.	Product transferred: crude oil, gasoline, etc.	Methanol
2.	Amount transferred (loading), gals/day	3,000
3.	Amount transferred (unloading), gals/day	N/A
4.	Amount transferred (pipe line), gals/day	270
5.	Bulk temperature of the product, °F	Ambient
6.	True vapor pressure of the product at storage temperature, psia	96
7.	Reid vapor pressure of the product, psia	N/A
8.	Molecular weight of the product, lb/lb mole	N/A
9.	Density of the product at bulk temperature (lbs/gal)	6.5
10.	Type of loading: vessel, barge, truck, other (specify)	Truck
11.	Type of filling: submerged, fill pipe splash filling, bottom filling, other (specify)	Bottom Filling
11a.	If submerged fill is used, what approximate percent is the fill pipe submerged	N/A
12.	Type of service: dedicated service to one product, vapor balance service, other (specify)	Dedicated Service to One Product
13.	Is loading/unloading operation equipped with vapor recovery or other pollution control system (specify)	No
14.	Efficiency of vapor collection system	N/A
15.	For ships/barges; The arrival cargo true ullage (feet) prior to dockside discharge	N/A
16.	For ships/barges; compartment condition before cargo discharge: fully loaded or lightered/short-loaded	N/A
17.	For ships; ballast water (gallons)	N/A
18.	For ships/barges; Receiving vessel/tank conditions: Uncleaned, Ballasted, Cleaned, Gas-Freed	N/A
19.	For ships/barges; The previous cargo was: Volatile, Non-Volatile, other (specify)	N/A

FACILITY NAME Red Panther Chemical Co.  
 FACILITY ADDRESS P.O. Box 550, Clarksdale, M.S. 38614

BULK STORAGE TANKS (LOADING/UNLOADING INFORMATION)

TS-11

Item No.	For Most Recent Calendar Year	1991
1.	Product transferred: crude oil, gasoline, etc.	Cyclohexanone
2.	Amount transferred (loading), gals/day	2,000
3.	Amount transferred (unloading), gals/day	N/A
4.	Amount transferred (pipe line), gals/day	425
5.	Bulk temperature of the product, °F	Ambient
6.	True vapor pressure of the product at storage temperature, psia (max @ 38.7°C)	10
7.	Reid vapor pressure of the product, psia	N/A
8.	Molecular weight of the product, lb/lb mole	N/A
9.	Density of the product at bulk temperature (lbs/gal)	7.89
10.	Type of loading: vessel, barge, truck, other (specify)	Truck
11.	Type of filling: submerged, fill pipe splash filling, bottom filling, other (specify)	Bottom Filling
11a.	If submerged fill is used, what approximate percent is the fill pipe submerged	N/A
12.	Type of service: dedicated service to one product, vapor balance service, other (specify)	Dedicated Service to One Product
13.	Is loading/unloading operation equipped with vapor recovery or other pollution control system (specify)	No
14.	Efficiency of vapor collection system	N/A
15.	For ships/barges; The arrival cargo true ullage (feet) prior to dockside discharge	N/A
16.	For ships/barges; compartment condition before cargo discharge: fully loaded or lightered/short-loaded	N/A
17.	For ships; ballast water (gallons)	N/A
18.	For ships/barges; Receiving vessel/tank conditions: Uncleaned, Ballasted, Cleaned, Gas-Freed	N/A
19.	For ships/barges; The previous cargo was: Volatile, Non-Volatile, other (specify)	N/A



FACILITY NAME Red Anthracite Chemical Co.

FACILITY ADDRESS P.O. Box 550, Clarksville MS 38614

BULK STORAGE TANKS (LOADING/UNLOADING INFORMATION)

TS-12

Item No.	For Most Recent Calendar Year	1991
1.	Product transferred: crude oil, gasoline, etc.	Empty
2.	Amount transferred (loading), gals/day	N/A
3.	Amount transferred (unloading), gals/day	N/A
4.	Amount transferred (pipe line), gals/day	N/A
5.	Bulk temperature of the product, °F	N/A
6.	True vapor pressure of the product at storage temperature, psia	N/A
7.	Reid vapor pressure of the product, psia	N/A
8.	Molecular weight of the product, lb/lb mole	N/A
9.	Density of the product at bulk temperature (lbs/gal)	N/A
10.	Type of loading: vessel, barge, truck, other (specify)	N/A
11.	Type of filling: submerged, fill pipe splash filling, bottom filling, other (specify)	Bottom Filling
11a.	If submerged fill is used, what approximate percent is the fill pipe submerged	N/A
12.	Type of service: dedicated service to one product, vapor balance service, other (specify)	N/A
13.	Is loading/unloading operation equipped with vapor recovery or other pollution control system (specify)	No
14.	Efficiency of vapor collection system	N/A
15.	For ships/barges; The arrival cargo true ullage (feet) prior to dockside discharge	N/A
16.	For ships/barges; compartment condition before cargo discharge: fully loaded or lightered/short-loaded	N/A
17.	For ships; ballast water (gallons)	N/A
18.	For ships/barges; Receiving vessel/tank conditions: Uncleaned, Ballasted, Cleaned, Gas-Freed	N/A
19.	For ships/barges; The previous cargo was: Volatile, Non-Volatile, other (specify)	N/A



FACILITY NAME Red Lather Chemical Co.  
 FACILITY ADDRESS P.O. Box 550, Clarksdale, MS 38614

BULK STORAGE TANKS (LOADING/UNLOADING INFORMATION)

TS-13

Item No.	For Most Recent Calendar Year	1991
1.	Product transferred: crude oil, gasoline, etc.	Waste
2.	Amount transferred (loading), gals/day	5
3.	Amount transferred (unloading), gals/day	6,000
4.	Amount transferred (pipe line), gals/day	N/A
5.	Bulk temperature of the product, °F	Ambient
6.	True vapor pressure of the product at storage temperature, psia	N/A
7.	Reid vapor pressure of the product, psia	N/A
8.	Molecular weight of the product, lb/lb mole	N/A
9.	Density of the product at bulk temperature (lbs/gal)	N/A
10.	Type of loading: vessel, barge, truck, other (specify)	Pipe
11.	Type of filling: submerged, fill pipe splash filling, bottom filling, other (specify)	Bottom Filling
11a.	If submerged fill is used, what approximate percent is the fill pipe submerged.	N/A
12.	Type of service: dedicated service to one product, vapor balance service, other (specify)	Dedicated Service to One Product
13.	Is loading/unloading operation equipped with vapor recovery or other pollution control system (specify)	No
14.	Efficiency of vapor collection system	N/A
15.	For ships/barges; The arrival cargo true ullage (feet) prior to dockside discharge	N/A
16.	For ships/barges; compartment condition before cargo discharge: fully loaded or lightered/short-loaded	N/A
17.	For ships; ballast water (gallons)	N/A
18.	For ships/barges; Receiving vessel/tank conditions: Uncleaned, Ballasted, Cleaned, Gas-Freed	N/A
19.	For ships/barges; The previous cargo was: Volatile, Non-Volatile, other (specify)	N/A

FACILITY NAME Red Onther Chemical Co.

FACILITY ADDRESS P.O. Box 550, Clarksdale, MS 38614

BULK STORAGE TANKS (LOADING/UNLOADING INFORMATION)

TS-14

Item No.	For Most Recent Calendar Year	1991
1.	Product transferred: crude oil, gasoline, etc.	Update
2.	Amount transferred (loading), gals/day	3,000
3.	Amount transferred (unloading), gals/day	N/A
4.	Amount transferred (pipe line), gals/day	15
5.	Bulk temperature of the product, °F	Ambient
6.	True vapor pressure of the product at storage temperature, psia	N/A
7.	Reid vapor pressure of the product, psia	N/A
8.	Molecular weight of the product, lb/lb mole	N/A
9.	Density of the product at bulk temperature (lbs/gal)	N/A
10.	Type of loading: vessel, barge, truck, other (specify)	Truck
11.	Type of filling: submerged, fill pipe splash filling, bottom filling, other (specify)	Bottom Filling
11a.	If submerged fill is used, what approximate percent is the fill pipe submerged	N/A
12.	Type of service: dedicated service to one product, vapor balance service, other (specify)	Dedicated Service to One Product
13.	Is loading/unloading operation equipped with vapor recovery or other pollution control system (specify)	No
14.	Efficiency of vapor collection system	N/A
15.	For ships/barges; The arrival cargo true ullage (feet) prior to dockside discharge	N/A
16.	For ships/barges; compartment condition before cargo discharge: fully loaded or lightered/short-loaded	N/A
17.	For ships; ballast water (gallons)	N/A
18.	For ships/barges; Receiving vessel/tank conditions: Uncleaned, Ballasted, Cleaned, Gas-Freed	N/A
19.	For ships/barges; The previous cargo was: Volatile, Non-Volatile, other (specify)	N/A



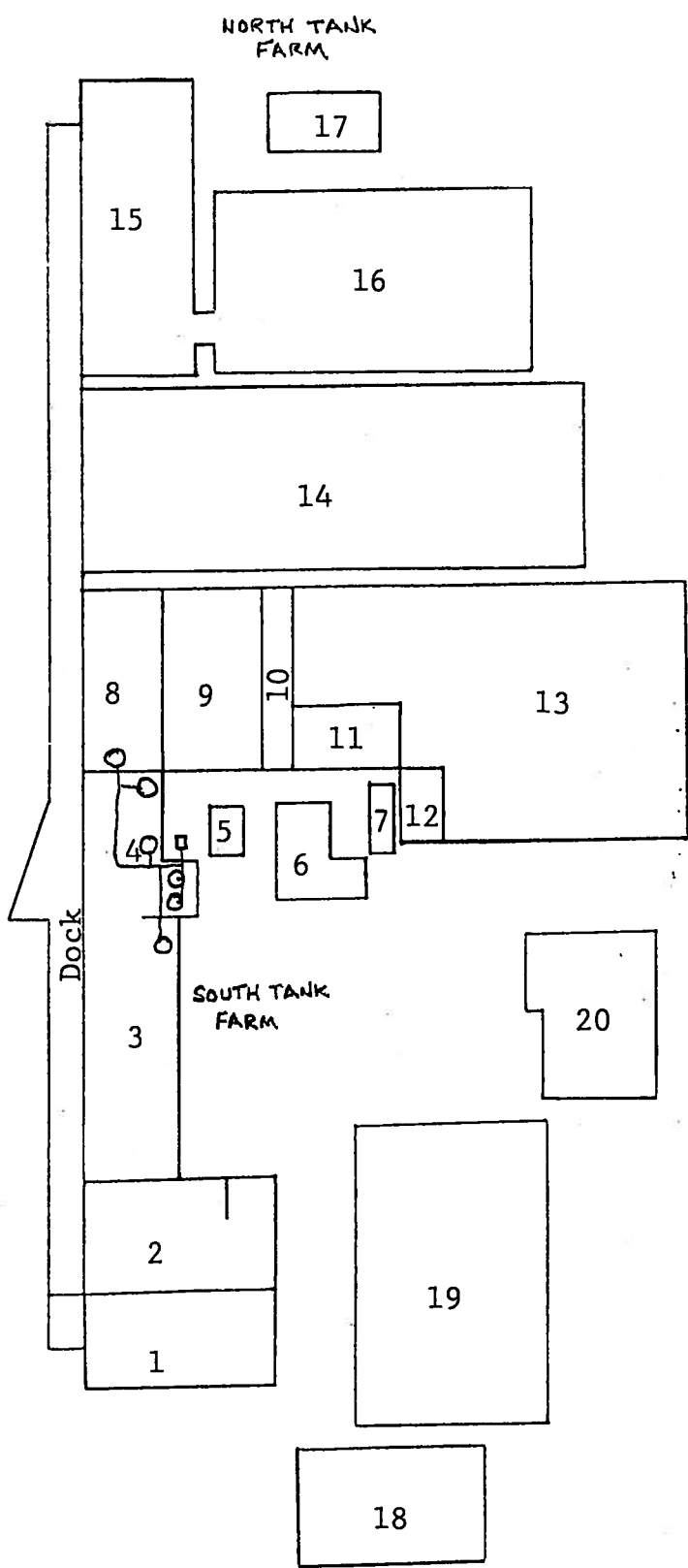

1. Flowable Pilot Plant
2. Dust Plant #3
3. Liquid Plant Warehouse
4. Liquid Plant (Insecticide)
5. Boiler Room
6. Lab Storage Room
7. Air Compressor Room
8. Dust Plant #1
9. Dust Plant #1A
10. Hallway
11. Dust Plant #2
12. Storage Room
13. Raw Material Warehouse
14. Shipping/Receiving Warehouse
15. Liquid Plant (Insecticide)
16. Liquid Plant Warehouse
17. Drum Storage
18. Shower & Change Room
19. Shop & Stockroom
20. Main Office
21. Warehouse (Final Product)

Approximate Scale

**LEGEND** 1"=100'  
 ○ MIXING TANK  
 □ CARBON ADSORPTION FILTER

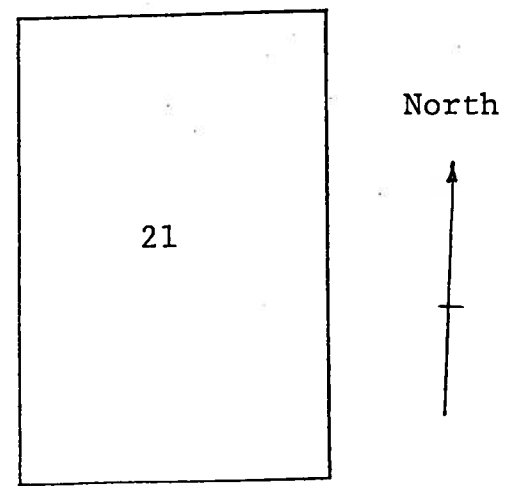

Red Panther Chemical Company

NORTH TANK FARM

- TN-01 MSMA TN-02 CAUSTIC
- TN-03 MSMA TN-04 ORCHEX 796
- TN-05 MSMA TN-06 FLO MD LOW FORM
- TN-07 EPFTY TN-08 VEGETABLE OIL
- TN-09 MSMA TN-10 MSMA
- TN-11 MSMA TN-12 ASANA
- TN-13 ASANA TN-14 KEROSENE
- TN-15 FLO MD1252 TN-16 APRUL CBJD
- TN-17 METHANOL TN-18 ETHANOL
- TN-19 ETHYLENE GLYCOL TN-20 AROMATIC 100
- TN-21 AROMATIC 200 TN-22 CHLORONIL 500

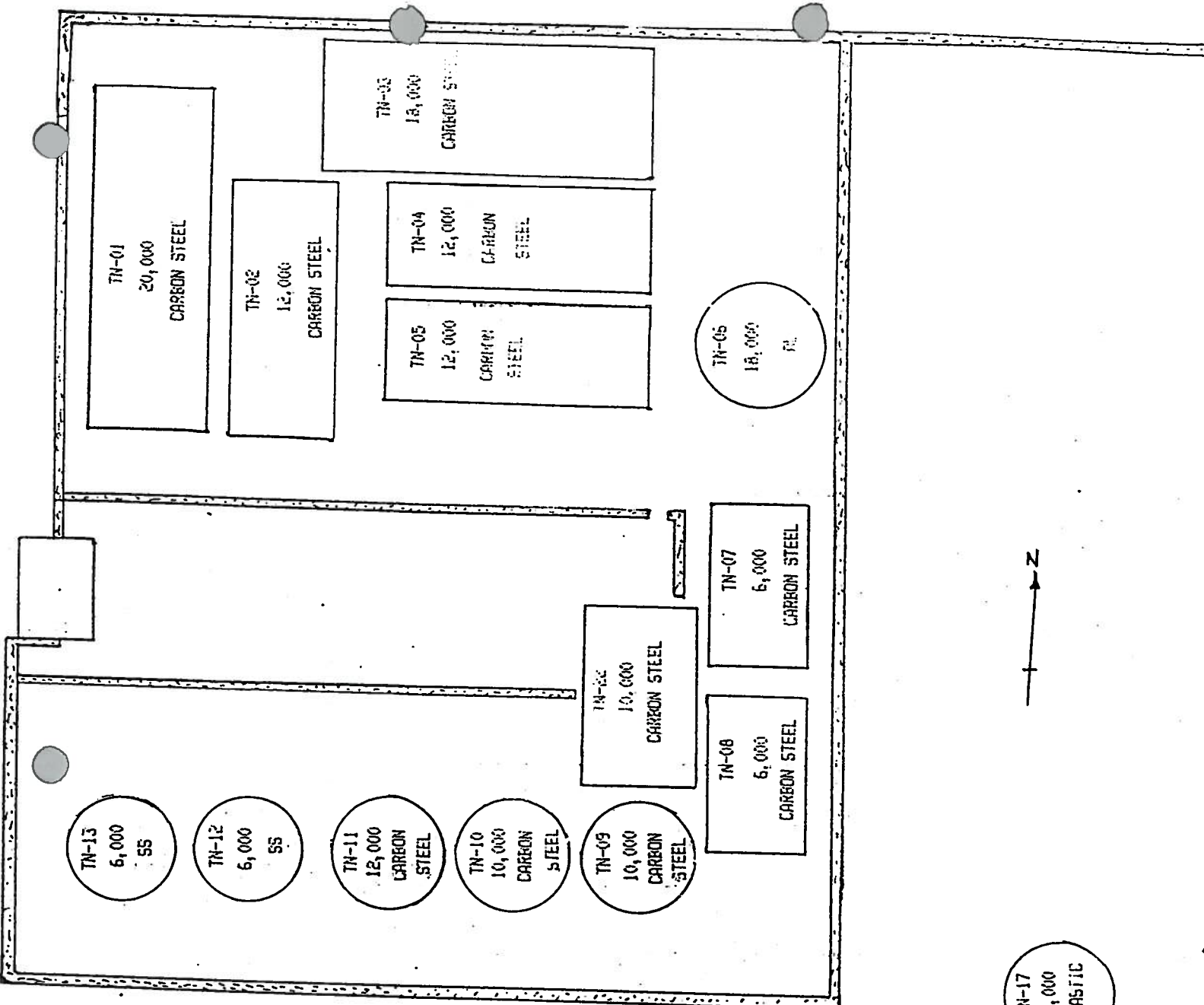

2 3 6

SOUTH TANK FARM

TS-01 ATLOX 3404F

TS-02 ATLOX 3403F

TS-03 CYTHION

TS-04 METHANOL

TS-05 SOYBEAN OIL

TS-06 CYTHION RTU

TS-07 EMPTY

TS-08 T500/100

TS-09 EMPTY

TS-10 METHANOL

TS-11 CYCLOHEXANONE

TS-12 EMPTY

TS-13 HAZARDOUS WASTE

TS-14 VYDATE

