

Add a New Site

Site Name: Red Panther Chemical Company

Official / Legal Name: Red Panther Chemical Company

Air Type: ~~FH~~ True Moner

Water Type: Ind

HW Type: Non Gen

SW Type:

Site General Information

ENTERED BY mcc
on 12/16/94

County: Coahoma

Contact Name: Cain, Bobby

Contact Title: Quality Control Manager

Contact Phone: 601-627-4731

Physical Address
City, State, Zip: NORMANDY & PATTON Streets
Clarksdale MS 38614

Mailing Address
City, State, Zip: P.O BOX 550
Clarksdale MS 38614

Owner's Name: ,

Owner's Address
City, State, Zip:

Operator or
Contractor Name: ,

Address
City, State, Zip:

Site Identification Information

ECED Contact:

SIC1: 2819 SIC2: SIC3:

Air ID: 00010 5 digit ID assigned by Air Divisio

Dunn and Bradstreet Number:



RED PANTHER CHEMICAL COMPANY/P.O. BOX 550/CLARKSDALE, MS 38614 PH. (601) 627-4731

May 23, 1985

Mississippi Department of Natural Resources
Bureau of Pollution Control
P. O. Box 10385
Jackson, MS. 39209

Dear Mr. Huff,

Re: State Operating Permit 84-005
Clarksdale, Mississippi
Coahoma County

This is in response to your letter concerning the drum storage area and tank farm at Red Panther Chemical Company.

All valves have been installed in the drum storage dikes and the dikes are now completely enclosed. Night watchmen have been assigned the responsibility of being sure the valves are closed at all times.

Should you have any questions please let me know.

Sincerely yours,

Clifford D. Porterfield
Technical Services

CDP/lt

May 3, 1985

Mr. Cliff Porterfield
Red Panther Chemical Company
P. O. Box 550
Clarksdale, Mississippi 38614

FILE COPY

Dear Mr. Porterfield:

Re: State Operating Permit 84-005
Clarksdale, Mississippi
Coahoma County

In my March 28, 1985 letter I addressed the drum storage area and tank farm. There were no valves in the drum storage dikes and the dikes were not completely enclosed.

Also, the valves in the tank farm were opened, and I suggested to you to make one individual responsible for checking the valves.

Please reply in writing within 10 days after the receipt of this letter to the above comments. Should you wish to discuss any matters, please call me at 961-5171.

Sincerely,

Walter Huff
Industrial Wastewater Control Section

WH:cm

March 28, 1985

Mr. Clifford Porterfield
Red Panther Chemical Company
P. O. Box 550
Clarksdale, Mississippi 38614

Dear Mr. Porterfield:

Re: State Operating Permit 84-005
Clarksdale, Mississippi
Coahoma County

As a result of my March 19, 1985 inspection, I would like to make the following comments:

1. The dikes around the drum storage area did not have any valves installed. The employee showing me around stated that the valves were on order and would be installed immediately upon arrival. Also, the dike did not completely enclose the drum storage area. There is a 2 foot opening between two buildings that is not diked. Please correct this situation.
2. The valves in the tank farm were opened. Please keep the valves shut unless you are allowing uncontaminated runoff to be discharged. I suggest you appoint one man responsible for opening and closing the valves. If someone is accountable for the valves maybe he or she will see to it they stay in the closed position.

Please inform me when you have installed the valves in the drum storage area. Also, if you have any questions, feel free to call me at 961-5171.

Very truly yours,

Walter Huff
Industrial Wastewater Control Section

WH:els

cc: Mr. Steve Spengler, BPC



RED PANTHER CHEMICAL COMPANY/P.O. BOX 550/CLARKSDALE, MS 38614 PH. (601) 627-4731

December 21, 1984

RECEIVED
1984 DEC 21 11 22

Mr. Walter Huff
Mississippi Department of Natural Resources
P.O. Box 10385
Jackson, Miss. 39209

Dear Mr. Huff:

Re: State Operating Permit No. 84-005
Clarksdale, Miss.
Coahoma County

A concrete dike has been completed around the drum storage area. An agreement has been made with the City of Clarksdale to install a new sewer line and cut off valve on the back side of the facility. They have not started this project yet.

Sincerley,

Clifford D. Porterfield
Head TEchnical Services

CDP/rr

December 10, 1984

Mr. Clifford Porterfield
Red Panther Chemical Company
P. O. Box 550
Clarksdale, Mississippi 38614

FILE COPY

Dear Mr. Porterfield:

Re: State Operating Permit No. 84-005
Clarksdale, Mississippi
Coahoma County

Please inform the Bureau in writing within 10 days after the receipt of this letter as to the state of the drum storage area. If you have any questions, call me at (601) 961-5171.

Sincerely,

Walter Huff
Industrial Wastewater Control Section

WH:cm



RED PANTHER CHEMICAL COMPANY/P.O. BOX 550/CLARKSDALE, MS 38614 PH. (601) 627-4731

September 26, 1984

Mississippi Department of Natural Resources
Bureau of Pollution Control
P.O. Box 10385
Jackson, Miss. 39209

Attention: Mr. Walter Huff

Dear Mr. Huff:

Re: State Operating Permit No. 84-005
Clarksdale, Mississippi
Coahoma County

We have been informed by our contractor that the dike around the drum storage area will be complete by October 15, 1984.

The Clarksdale City Engineer, Mr. Jim Wannamaker is working with us on a system where the out flow of water can be controlled by a large gate valve. This will allow us to close the water drain when unloading rail cars.

We will notify you when the dike is complete.

Sincerely,

CLIFFORD B. PORTERFIELD
DIRECTOR OF SALES AND TECH SERVICE

CDP/rr

RECEIVED
1984 SEP 28 PM 9:46
MISSISSIPPI DEPARTMENT OF NATURAL RESOURCES
BUREAU OF POLLUTION CONTROL

September 12, 1984

Mr. Cliff Porterfield
Red Panther Chemical
P.O. Box 550
Clarksdale, Mississippi 38614

Dear Mr. Porterfield:

RE: State Operating Permit No. 84-005
Clarksdale, Mississippi
Coahoma County

I would like a progress report on the diking of the drum storage area and the plan you will use to close off the water drain in case a rail car had a spill.

Please submit the above information within 10 days after receiving this letter. Should you have any questions call me at 961-5171.

Very truly yours,

Walter Huff
Industrial Wastewater Control Section

WH:ps

cc: Steve Spengler, BPC

~~cc: Steve Spengler, BPC~~ This copy for

File Copy

September 12, 1984

Mr. Cliff Porterfield
Red Panther Chemical
P.O. Box 550
Clarksdale, Mississippi 38614

Dear Mr. Porterfield:

RE: State Operating Permit No. 84-005
Clarksdale, Mississippi
Coahoma County

I would like a progress report on the diking of the drum storage area and the plan you will use to close off the water drain in case a rail car had a spill.

Please submit the above information within 10 days after receiving this letter. Should you have any questions call me at 961-5171.

Very truly yours,

Walter Huff
Industrial Wastewater Control Section

WH:ps

cc: Steve Spengler, EPC

August 2, 1984

CERTIFIED MAIL - RETURN RECEIPT REQUESTED

Mr. Clifford Porterfield
Red Panther Chemical Company
P. O. Box 550
Clarksdale, Mississippi 38614

Dear Mr. Porterfield:

Re: State Operating Permit No. 84-005
Clarksdale, Mississippi
Coahoma County

Enclosed is State Operating Permit Number 84-005, which is hereby issued to Red Panther Chemical Company. Special attention should be given to the conditions of the permit found in Parts A.1, A.4 and B.6.

This permit is issued in accordance with the Mississippi Air and Water Pollution Control Law (Sections 49-17-1 through 49-17-43, Mississippi Code of 1972), and the regulations adopted and promulgated thereunder.

If Red Panther Chemical Company desires that a Permit Board hearing be held regarding this permit, it should make written application to the Board within thirty (30) days after receipt of this notice; otherwise, the terms, conditions and limitations in the permit shall become final.

If you have any questions, please contact us.

Very truly yours,

Walter Huff
Industrial Wastewater Control Section

WH:cm

Enclosures

cc: North Regional Office
Mr. Wm. Stephen Spengler, P. E., BPC

Warren Foster

← This copy for

August 2, 1984

FILE

CERTIFIED MAIL - RETURN RECEIPT REQUESTED

Mr. Clifford Porterfield
Red Panther Chemical Company
P. O. Box 550
Clarkdale, Mississippi 38614

Dear Mr. Porterfield:

Re: State
Clark
Coah

Enclosed is State Operating Permit Number
Red Panther Chemical Company. Special
conditions of the permit found in Part

This permit is issued in accordance with
Pollution Control Law (Sections 49-17-
Code of 1972), and the regulations add

If Red Panther Chemical Company desire
regarding this permit, it should make
thirty (30) days after receipt of this
and limitations in the permit shall be

If you have any questions, please contact

Very truly

Walter Hu
Industrial Wastewater Control Section

WH:cm
Enclosures
cc: North Regional Office
Mr. Wm. Stephen Spengler, P. E., BPC
Warren Foster

PS Form 3811, Dec. 1980

SENDER: Complete items 1, 2, 3, and 4.
Add your address in the "RETURN TO" space on reverse.

(CONSULT POSTMASTER FOR FEES)

1. The following service is requested (check one).
 Show to whom and date delivered
 Show to whom, date, and address of delivery..
 RESTRICTED DELIVERY
(The restricted delivery fee is charged in addition to the return receipt fee.)

TOTAL \$

3. ARTICLE ADDRESSED TO:
 Mr. Clifford Porterfield
 Red Panther Chemical Co.
 P.O. Box 550
 Clarkdale MS 38614

4. TYPE OF SERVICE: <input type="checkbox"/> REGISTERED <input type="checkbox"/> INSURED <input checked="" type="checkbox"/> CERTIFIED <input type="checkbox"/> COD <input type="checkbox"/> EXPRESS MAIL	ARTICLE NUMBER 602-382
--	-------------------------------

(Always obtain signature of addressee or agent)

I have received the article described above.
 SIGNATURE Addressee Authorized agent
Walter Hu

5. DATE OF DELIVERY POSTMARK
 1984

6. ADDRESSEE'S ADDRESS (Only if requested)

7. UNABLE TO DELIVER BECAUSE: 7a. EMPLOYEE'S INITIALS

RETURN RECEIPT, REGISTERED, INSURED AND CERTIFIED MAIL
 Alex City - King Mfg. Co. (Corinth)



RED PANTHER CHEMICAL COMPANY/P.O. BOX 550/CLARKSDALE, MS 38614 PH. (601) 627-4731

July 11, 1984

Mississippi Department of Natural Resources
Bureau of Pollution Control
PO Box 10385
Jackson, Mississippi 39209

Attention: Mr. Walter Huff

Dear Mr. Huff:

In reference to your letter of June 19, 1984, the following action has been taken.

1. A contract has been let to dike the drum storage area.
2. Dikes have been inspected and any drain pipes not equipped with a valve have been plugged with concrete.
3. Seepage on the outside wall of the North Dike has been corrected.
4. A method of spill containment is being constructed to close off the water drain in the area where rail cars are unloaded.

The new cooling tower has been installed. but will not be in use for sometime.

If further information is needed, please let me know.

Sincerely,

CLIFFORD D. PORTERFIELD
DIRECTOR OF SALES AND TECHNICAL SERVICES

CDP/rr

RECEIVED
1984 JUL 13 AM 9:39
MISSISSIPPI DEPARTMENT OF NATURAL RESOURCES
BUREAU OF POLLUTION CONTROL

Application Number

Date Received

STATE OF MISSISSIPPI
BUREAU OF POLLUTION CONTROL
P. O. BOX 10385
JACKSON, MISSISSIPPI 39209

APPLICATION FOR A STATE OPERATING PERMIT

RECEIVED
MAR - 2 REC'D
BUREAU OF POLLUTION CONTROL
RESOURCE

(Please print or type)

1. Name of Applicant: RED PANTHER CHEMICAL COMPANY

2. Mailing Address of Applicant:
Number & Street (P.O. Box): PO Box 550
City: CLARKSDALE State: MISS. Zip: 38614

3. Applicant's Authorized Agent:
Name & Title: CLIFFORD D. PORTERFIELD DIRECTOR OF SALES & TECHNICAL SERVICE
Number & Street (P.O. Box): PO BOX 550
City: CLARKSDALE State: MISS. Zip: 38614
Telephone Number: 601-627-4731

4. Facilities Location:
Number & Street: NORMANDY AND PATTON STREETS
City: CLARKSDALE County: COAHOMA

5. Nature of Business: FORMULATING OF LIQUID AND POWDERS OF AGRICULTURAL
CHEMICALS

6. Do you Discharge Wastewater to a POTW? Yes No
If "Yes" Continue, if "No" go to Item 10.
Name of POTW Receiving Wastewater: _____
Number & Street (P.O. Box): _____
City: _____ County: _____

12. Give narrative description of process(es) producing discharge, or in the case of no discharge, that generates wastewater.

NO DISCHARGE

13. List raw materials used:

14. Effluent Characteristics:

A. You must provide the results of at least one analysis for every pollutant in this table. Complete one table for each outfall to the city sewer. If your facility does not have a discharge indicate so and disregard.

NO DISCHARGE

<u>Parameter</u>	<u>Maximum Daily Value</u>	<u>Maximum 30 Day Value</u>	<u>Long Term Average Value</u>
BOD ₅	_____	_____	_____
COD	_____	_____	_____
TSS	_____	_____	_____
Ammonia	_____	_____	_____
Oil & Grease	_____	_____	_____
pH	_____	_____	_____

B. Review the substances listed in Table One and indicate which of these substances you have reason to believe may be in your discharge. For instance you may use solvents or Biocides that contain one or more of the indicated solvents. For each substance indicated you must perform at least one analysis and report results.

NO DISCHARGE

15. Treatment Units:

- A. Do you provide treatment for your wastewater? Yes No
- B. If yes, list and describe each treatment unit and attach a line schematic of the treatment system indicating each treatment unit and a water balance.

I certify that I am familiar with the information contained in this application and that to the best of my knowledge and belief such information is true and correct.

CLIFFORD D. PORTERFIELD
Printed Name of Applicant's Authorized Agent

DIRECTOR OF SALES & TECHNICAL SERVICE
Title

2-29-84
Date Application Signed

Clifford D Porterfield
Signature of Authorized Agent

- ① SHOP WAREHOUSE
- ② SHOP
- ③ DUST PLANT # 3
- ④ SOUTH TANK FARM
- ⑤ HAZARDOUS WASTE STORAGE TANKS
- ⑥ LIQUID BLENDING
- ⑦ BOILER

- ⑧ OFFICE LOCKER
- ⑨ MAIN POWER SWITCH
- ⑩ DRUM STORAGE - EMPTY DRUMS
- ⑪ DUST PLANT # 1
- ⑫ DUST PLANT # 2

- ⑬ AIR COMPRESSOR
- ⑭ POWER SWITCH
- ⑮ STORAGE
- ⑯ OLD WAREHOUSE
- ⑰ NEW WAREHOUSE

- ⑱ LIQUID BLENDING
- ⑲ NORTH TANK FARM
- ⑳ HAZARDOUS WASTE DRUM STORAGE
- ㉑ MAIN OFFICE
- ㉒ HIS-DEL WAREHOUSE
- ㉓ OIL HOUSE

- GATES - DOORS
- TELEPHONES
- FIRE HOSE
- FIRE EXTINGUISHERS
- POWER SWITCH
- GAS VALVE
- DRAIN SEWAGE
- SODA ASH
- DIKES
- RECOVERY DRUMS
- EMERGENCY BELL

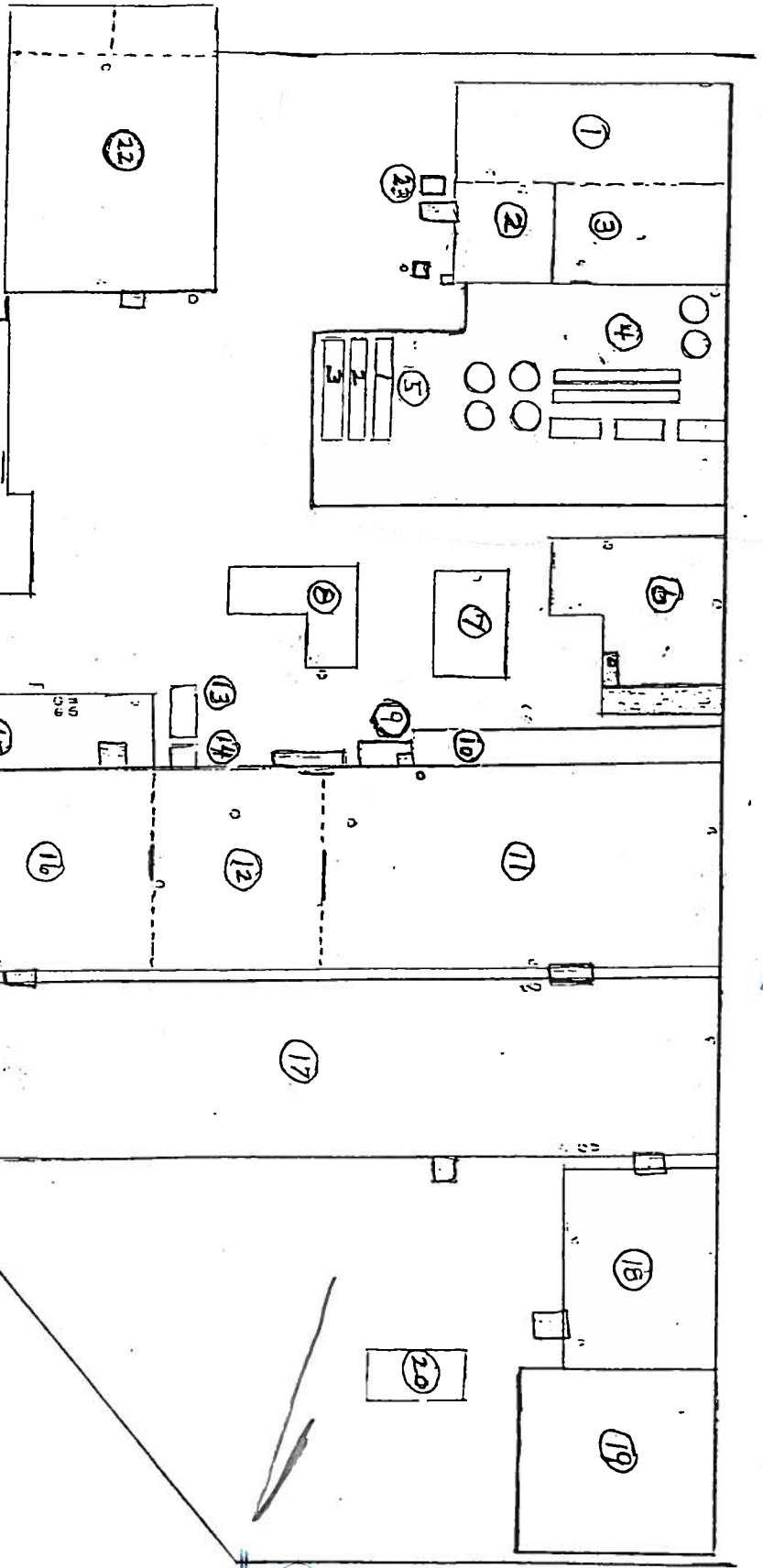

① pkcs



State of Mississippi Water Pollution Control PERMIT

TO OPERATE A WASTEWATER DISPOSAL SYSTEM WITH NO DISCHARGE

THIS CERTIFIES THAT

Red Panther Chemical Company
Clarksdale, Mississippi

has been granted permission to operate a wastewater disposal system in accordance with the limitations and conditions set forth in this permit. This permit is issued in accordance with the provisions of the Mississippi Water Pollution Control Law (Section 49-17-1 et seq., Mississippi Code of 1972), and the regulations and standards adopted and promulgated thereunder.

MISSISSIPPI POLLUTION CONTROL PERMIT BOARD

A handwritten signature in cursive script, reading "Charles Chisolm", is written over a horizontal line.

DIRECTOR, BUREAU OF POLLUTION CONTROL
MISSISSIPPI DEPARTMENT OF NATURAL RESOURCES

Issued: August 1, 1984

Permit No. 84-005

PART I

A. MANAGEMENT REQUIREMENTS AND RESPONSIBILITIES

1. No Discharge of Wastewater to Surface Water

The discharge of any wastewater from this facility to the waters of the State of Mississippi shall constitute a violation of this permit, except as provided in Section A.4 of this permit, or as authorized under separate permit pursuant to Section 402 of the Federal Water Pollution Control Act.

2. Change in Wastewater Source

Any anticipated facility expansions, production increases, or process modifications which will result in new, different, or increased wastewater flows, must be reported to the Mississippi Pollution Control Permit Board. Following such notice, if the Permit Board determines that such change will violate any condition of this permit, it may require the submittal of a new application, or it may modify this permit accordingly.

3. Facilities Operation

The permittee shall at all times maintain in good working order and operate as efficiently as possible all treatment or control facilities or systems installed or used by the permittee to achieve compliance with the terms and conditions of this permit.

4. Bypassing

Any diversion from or bypass of wastewater collection and treatment or control facilities is prohibited, except (i) where unavoidable to prevent loss of life or severe property damage, or (ii) where excessive storm drainage or runoff would damage any facilities necessary for compliance with the effluent limitations and prohibitions of this permit. The permittee shall notify the Mississippi Pollution Control Permit Board in writing of each such diversion or bypass in advance where practicable but in any case, within 72 hours of the diversion or bypass, and shall submit to the Permit Board a plan to prevent recurrence of the diversion or bypass within thirty (30) days of the incident.

5. Removed Substances

Solids, sludges, filter backwash, or other residuals removed in the course of treatment or control of wastewaters shall be disposed of in a manner such as to prevent such materials from entering State waters and in a manner consistent with the Mississippi Solid Waste Disposal Act and the Federal Resource Conservation and Recovery Act.

6. Power Failures

In order to maintain compliance with the conditions and prohibitions of this permit, the permittee shall either:

- a. Provide an alternative power source to operate the wastewater control facilities;
or, if such alternative power source is not in existence, and no date for its implementation appears in this permit,
- b. Halt, reduce, or otherwise control production and/or all wastewater flows upon reduction, loss, or failure of the primary source of power to the wastewater control facilities.

B. MONITORING, REPORTING, AND RECORD KEEPING

1. Routine Reporting

Such test results, reports, or other data as the Mississippi Pollution Control Permit Board may determine to be necessary shall be submitted on a regular basis to the following address:

**MISSISSIPPI DEPARTMENT OF NATURAL RESOURCES
BUREAU OF POLLUTION CONTROL
P. O. Box 10385
Jackson, Mississippi 39209**

2. Test Procedures

Test procedures for the analysis of pollutants shall conform to regulations published pursuant to Section 304 (h) of the Federal Water Pollution Control Act, as amended.

3. Representative Sampling

Samples and measurements taken as required herein shall be representative of the volume and nature of the monitored wastewater.

4. Recording of Results

- a. The exact place, date, and time of sampling;
- b. The dates the analyses were performed;
- c. The person(s) who performed the analyses;
- d. The analytical techniques or methods used; and
- e. The results of all required analyses.

5. Records Retention

- (a) All records and information resulting from the monitoring activities required by this permit (including all records of analyses performed; calibration and maintenance of instrumentation; and recordings from continuous monitoring instrumentation) shall be retained for a minimum of three (3) years, or longer if requested by the Permit Board.
- (b) The permittee shall furnish to the Permit Board, upon request, copies of records required to be kept by this permit.

6. Noncompliance Reporting

This permittee shall report any instances of noncompliance orally to the Director, or his representative, within 24 hours of becoming aware of the circumstances. A written report shall also be provided within five (5) days of such time, and shall contain the following information:

- (a) A description of the noncompliance and its cause, if known.
- (b) The period of noncompliance, including exact dates and times; or if not corrected, the anticipated time the noncompliance is expected to continue, and steps being taken to reduce, eliminate, and prevent recurrence.

7. Right of Entry

The permittee shall allow the Mississippi Pollution Control Permit Board and/or its authorized representation of credentials:

- (a) To enter upon the permittee's premises where a wastewater source is located or in which records are required to be kept under the terms and conditions of this permit; and
- (b) At reasonable times to have access to and copy any records required to be kept under the terms and conditions of this permit; to inspect any monitoring equipment or monitoring method required in this permit; and to sample any wastewater generated at this facility.

8. Transfer of Ownership or Control

This permit is not transferable to any person except after proper notice. In the event of any change in control or ownership of facilities, the permittee shall notify the Mississippi Pollution Control Permit Board at least thirty (30) days in advance of the proposed transfer date. The notice should include a written agreement between the existing and new permittees containing a specific date for the transfer of permit responsibility, coverage, and liability.

9. Availability of Records

Except for data determined to be confidential under the Mississippi Air and Water Pollution Control Law, all reports prepared in accordance with the terms of this permit shall be available for public inspection at the offices of the Mississippi Bureau of Pollution Control.

10. Permit Modification

- (a) The permittee shall furnish to the Permit Board within a reasonable time any relevant information which the Permit Board may request to determine whether cause exists for modifying, revoking and reissuing, or terminating the permit, or to determine compliance with the permit.
- (b) Upon sufficient cause this permit may be modified, revoked, reissued, or terminated during its term.
- (c) The filing of a request by the permittee for a permit modification, or a notification of planned changes or anticipated noncompliance, does not stay any permit condition.

11. Property Rights

The issuance of this permit does not convey any property rights in either real or personal property, or any exclusive privileges, nor does it authorize any injury to private property or any invasion of personal rights, nor any infringement of Federal, State, or local laws or regulations.

12. Oil and Hazardous Substance Liability

Nothing in this permit shall be construed to preclude the institution of any legal action or relieve the permittee from any responsibilities, liabilities, or penalties to which the permittee is or may be subject to under Section 311 of the Federal Water Pollution Control Act or the applicable provisions under Mississippi Law pertaining to the transportation, storage, treatment, or spillage of oil or hazardous substances.

13. Severability

The provisions of this permit are severable, and if any provision of this permit, or the application of any provision of this permit to any circumstances, is held invalid, the application of such provision to other circumstances, and the remainder of this permit shall not be affected thereby.

14. CLOSURE REQUIREMENTS

Should the permittee decide to permanently close and abandon the premises upon which it operates, it shall so notify the Permit Board no later than 90 days prior to doing so. Accompanying this notification shall be a closure plan which describes how and when all manufactured products, by-products, raw materials, stored chemicals, and solid and liquid wastes will be removed from the premises such that they will present no potential environmental hazard to the area. Abandonment of the site without providing proper notification as required herein, or without completing all aspects of the closure plan, will constitute a violation of this permit and may result in penalties of up to \$25,000.

PART II

Other Requirements

1. There shall be no discharge of contaminated runoff from the facility.
2. All dikes around tanks should be properly maintained to prevent spills from leaving the confined area.