

7 039 567 840

US Postal Service

**Receipt for Certified Mail**

No Insurance Coverage Provided.

Do not use for International Mail (See reverse)

Sent to <i>Mr. Caley Claiborne</i>	
Street & Number <i>216 McPherson Drive</i>	
Post Office, State, & ZIP Code <i>Crystal Springs MS 39057</i>	
Postage	\$
Certified Fee	
Special Delivery Fee	
Restricted Delivery Fee	
Return Receipt Showing to Whom & Date Delivered	
Return Receipt Showing to Whom, Date, & Addressee's Address	
<b>TOTAL Postage &amp; Fees</b>	<b>\$</b>
Postmark or Date	

PS Form 3800, April 1995

Stick postage stamps to article to cover First-Class postage, certified mail fee, and charges for any selected optional services (See front).

1. If you want this receipt postmarked, stick the gummed stub to the right of the return address leaving the receipt attached, and present the article at a post office service window or hand it to your rural carrier (*no extra charge*).
2. If you do not want this receipt postmarked, stick the gummed stub to the right of the return address of the article, date, detach, and retain the receipt, and mail the article.
3. If you want a return receipt, write the certified mail number and your name and address on a return receipt card, Form 3811, and attach it to the front of the article by means of the gummed ends if space permits. Otherwise, affix to back of article. Endorse front of article **RETURN RECEIPT REQUESTED** adjacent to the number.
4. If you want delivery restricted to the addressee, or to an authorized agent of the addressee, endorse **RESTRICTED DELIVERY** on the front of the article.
5. Enter fees for the services requested in the appropriate spaces on the front of this receipt. If return receipt is requested, check the applicable blocks in item 1 of Form 3811.
6. Save this receipt and present it if you make an inquiry.

102595-97-B-0145

UNITED STATES POSTAL SERVICE

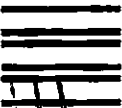

First-Class Mail  
Postage & Fees Paid  
USPS  
Permit No. G-10

● Print your name, address, and ZIP Code in this box ●

MS Department of Environmental Quality  
Office of Pollution Control  
P. O. Box 10385  
Jackson, MS 39289-0385

*Attn: Tony Russell*

Is your RETURN ADDRESS completed on the reverse side?

**SENDER:**

- Complete items 1 and/or 2 for additional services.
- Complete items 3, 4a, and 4b.
- Print your name and address on the reverse of this form so that we can return this card to you.
- Attach this form to the front of the mailpiece, or on the back if space does not permit.
- Write "Return Receipt Requested" on the mailpiece below the article number.
- The Return Receipt will show to whom the article was delivered and the date delivered.

I also wish to receive the following services (for an extra charge):

- 1.  Addressee's Address
- 2.  Restricted Delivery

**3. Article Addressed to:**

Mr. Caley Claiborne  
216 McPherson Drive  
Crystal Springs, Ms. 39079

**4a. Article Number**

2 039 567840

**4b. Service Type**

- Registered
- Certified
- Express Mail
- Insured
- Return Receipt for Merchandise
- COD

**7. Date of Delivery**

3-22-02

**5. Received By: (Print Name)**

Caley Claiborne

**6. Signature (Addressee or Agent)**

*Caley Claiborne*

**8. Addressee's Address (Only if requested and fee is paid)**

Thank you for using Return Receipt Service.



STATE OF MISSISSIPPI  
DAVID RONALD MUSGROVE, GOVERNOR  
MISSISSIPPI DEPARTMENT OF ENVIRONMENTAL QUALITY  
CHARLES H. CHISOLM, EXECUTIVE DIRECTOR

FILE COPY

March 21, 2002

**CERTIFIED LETTER NO. Z 039 567 840 RETURN RECEIPT REQUESTED**

Mr. Caley Claiborne  
216 McPherson Drive  
Crystal Springs, MS 39059

RE: 216 McPherson Drive  
Crystal Springs, Copiah County, Mississippi

Dear Mr. Claiborne:

The Uncontrolled Sites Section of the Mississippi Department of Environmental Quality (MDEQ) has completed a review of the *Final Report*, dated November 15, 2000, prepared by First Environment, Inc. for the above referenced property. The MDEQ requires no further action at this site at this time.

If cleanup standards change or additional data becomes available for the site, then MDEQ will notify the appropriate parties of the need for any additional investigation(s) or remedial action(s). These actions will be consistent with our need to protect human health, welfare, and/or the environment.

If you have any questions, concerning this matter, please contact me at (601) 961-5318.

Sincerely,

Tony Russell, Chief  
Uncontrolled Sites Branch

Enclosure

K:\Shared\UCSS\Gretchen Zmitrovich\Kuhlman Electric\Off-site\Kuhlman Electric-216 McPherson Dr (Claiborne) SNFA\_3-21-02.doc

**FILE COPY**

**KUHLMAN ELECTRIC  
101 KUHLMAN DRIVE  
CRYSTAL SPRINGS  
MISSISSIPPI**

**FINAL REPORT**

**PREPARED BY:  
Michael Caples, Esq.**

**NOVEMBER 15, 2000**

**FIRST  
ENVIRONMENT**

November 15, 2000

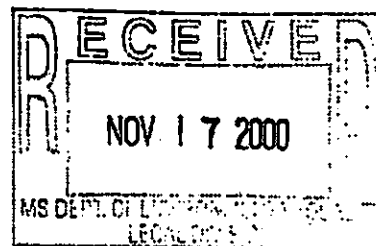

Al Thomas  
Kuhlman Electric  
101 Kuhlman Drive  
Crystal Springs, MS 39059

Scott Schang  
Latham & Watkins  
1001 Pennsylvania Avenue, NW  
Washington, DC 20004

Dear Al and Scott,

Please find below a description of the work performed by First Environment, Inc. and its subcontractors in association with the discovery of polychlorinated biphenyls (PCBs) at the Kuhlman Electric plant in Crystal Springs, Mississippi. This report only deals with the decontamination of equipment and the removal of soil from off-site areas.

#### DECONTAMINATION OF EQUIPMENT

On May 3, 2000, Kuhlman Electric hired First Environment, Inc. to decontaminate earth-moving equipment contaminated during the expansion project. Through the entire month of May, additional items were discovered that needed decontaminating, a detailed list of all items decontaminated by First Environment can be found in Table 1.

Decontamination of the equipment followed the double wash/rinse procedures set forth in 40 C.F.R. 761 Subpart S. First, remove and capture the dry solids by mechanical force (i.e. the use of hammers and scrappers). Second, cover the entire surface with an industrial strength detergent and wash with a steam power washer. Third, capture the rinse water for further treatment. Fourth, repeat. Fifth, verify by confirmation sampling. Finally, remove the equipment from the plant site.

Initial decontamination of equipment began on May 11, 2000 and was completed on May 26, 2000. First Environment, Inc. decontaminated some 17 vehicles. In addition, some other items were cleaned for precautionary reasons, and these items were not included in the report. All confirmation samples taken for each of the 17 pieces of equipment came back as non-detectable. Therefore, no further action is required for the decontamination work.

#### OFF-SITE PROPERTY

During the equipment decontamination, First Environment learned that employees had removed soil and gravel from the plant location. Our investigation uncovered five off-site areas where potentially contaminated material had been removed from the plant location. They are listed below:

1. AKT gravel pit two soil piles on side of road.
2. Alean Meyers Property
3. J. C. Lomax Property
4. Caley Claiborne Property
5. Dwight Holiday Property

On May 16 and 17, 2000 First Environment conducted an emergency removal of PCB contaminated material at five off-site locations. The contaminated material remained in piles or areas that were easily identified by sight. Therefore, in order to expedite the emergency removal of material an extensive soil sampling program was not warranted. Instead, a buffer zone of one to three feet beyond the lateral and vertical extent of the contaminated soil was excavated for each location. Confirmation samples were taken within and outside the excavated area to assure that all contaminated soil was removed from the property. The removed soil was placed in water-tight containers and returned to the Kuhlman property where it awaits final disposal.

#### AKT GRAVEL PIT TWO SOIL PILES

On May 16, 2000, First Environment conducted an emergency removal action of two soil piles located at the AKT Gravel pit. The soil was removed from the Kuhlman property by Vaughan Construction and placed at the gravel pit. Immediately upon discovering the soil piles, First Environment covered the piles with plastic to prevent any run off. Because the piles remained in tact, they were easily removed with a backhoe front-end loader. A buffer zone around the piles of approximately two feet was excavated to assure the removal of all contaminated material. Samples taken after the removal confirmed that the remaining soil was below the action level of 1 ppm. See Exhibit #1 and Table #2 for sample location and results.



### ALLEAN MEYERS PROPERTY

On May 16, 2000 First Environment conducted an emergency removal action of approximately a five-gallon bucket of soil removed from the Kuhlman property at Ms. Allean Meyers property. Meyers's son, an employee of Kuhlman removed a five gallon bucket of soil from the Kuhlman property and placed it in a hole near her house. The hole was clearly defined and the soil was removed with a shovel and placed into a container and returned to the Kuhlman property. The hole was backfilled with clean dirt and no confirmation samples were taken.

### J. C. LOMAX PROPERTY

On May 16, 2000 First Environment conducted an emergency removal action of approximately seven cubic yards of soil removed from the Kuhlman property by Mr. Lomax. The soil was dumped in a pile in Mr. Lomax's pasture where it had remained undisturbed. Upon discovering the pile, First Environment covered the soil with plastic.

Excavation of the soil consisted of using a rubber-tire backhoe to remove the soil pile. In addition, a buffer zone of approximately two feet around and one foot below the pile was removed. Samples taken after the removal confirmed that the remaining soil was clear of any PCB material. See Exhibit #2 and Table #3 for sample location and results.

### CALEY CLAIBORNE PROPERTY

On May 16, 2000 First Environment learned that a composite sample taken from the driveway of Caley Claiborne at 216 McPherson Drive showed the presence of 1644 ppm of PCB - Aroclor 1268. Upon notification of the test results, Kuhlman contacted the Mississippi Department of Environmental Quality, EPA superfund hotline and Region IV TSCA group of the potential release. First Environment proposed to Jerry Banks of MDEQ that an emergency removal action occur as soon as possible.

On May 17, 2000 First Environment conducted an emergency removal of PCB material at the Claiborne residence. Mr. Claiborne removed soil from the Kuhlman site to fill in a pothole in his driveway. Mr. Claiborne clearly identified the area where the soil was placed and one could clearly see the outline of the pothole. See Exhibit #3 for pothole location and sample location.

Excavation of the area involved using a rubber-tire backhoe to remove the soil within the pothole. In addition, a buffer zone of approximately 3 to 5 feet was created around the pothole and approximately 1 to 1.5 feet below the pothole was excavated. The soil was removed from the property and stored at the Kuhlman plant site awaiting final disposal. Samples collected after the removal confirmed that the remaining soil contained no PCB material. See Exhibit # 4 and Table #4 for sample location and results. The area was backfilled with clean dirt and the driveway was paved with asphalt.

#### DWIGHT HOILDAY PROPERTY AND RESIDENCE

On May 17, 2000 First Environment conducted an emergency removal of PCB material at the Holiday residence. Mr. Holiday removed soil from the Kuhlman plant site to fill in two holes in his backyard, (pool and garden). Samples taken before excavation detected the presence of PCB at 183 ppm and 1.9 ppm respectfully. See Exhibit #6

Excavation was conducted with hand shovels and a front-end loader bobcat. The removed material was placed in a container and returned to the Kuhlman property. Both areas were clearly defined by the fresh dirt and lack of grass. Therefore, a buffer zone of approximately two feet outside the dirt area and one foot below the area was removed. Samples taken after the removal confirmed that the remaining soil was below 0.1 ppm of PCB. See Exhibit #5 and Table #5 for sample location and test results.

On May 18, 2000 First Environment learned that Mr. Holiday had washed his truck used to haul the contaminated soil out in his front yard. Samples from the front yard showed no presence of PCB material and no further action was taken. In addition, Mr. Holiday became concern of possible contamination within his house due to the presence of the soil in the backyard. Wipe samples from the floor and carpet inside the house showed no detection of PCB material. See Exhibit #6 for sample location.

To date, First Environment, has cleanup some 17 vehicles and 5 off-site areas. All confirmation samples have been below action limits. Therefore, no further action remains.

If you have any questions, please do not hesitate to contact me at 957-8967.

Sincerely,

FIRST ENVIRONMENT, INC.



Michael Caples, Esq.  
Regional Office Manager

MC/vg  
Enclosure

cc: U.S. Environment Protection Agency  
Mississippi Department of Environmental Quality

Project Name Kulman Project No. KUHL.M.001  
 Location Claiborne House Page \_\_\_\_\_ of \_\_\_\_\_  
 Subject Fill Area And Sample Location By JM Date 5/17/90  
 Ck \_\_\_\_\_ Date \_\_\_\_\_

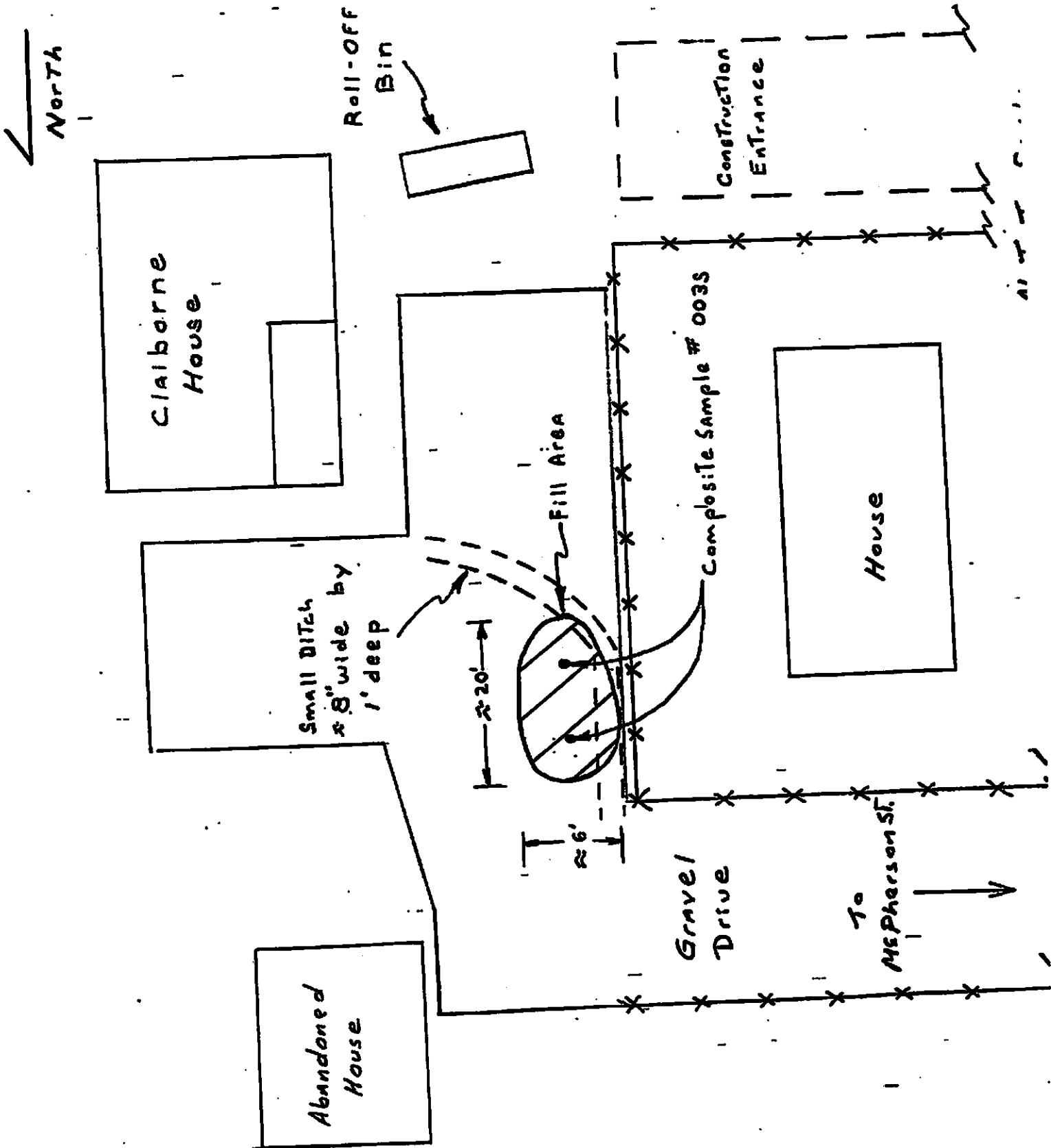

Exhibit #3

**TABLE # 4**  
**CONFIRMATION SAMPLES CLAIBORN PROPERTY**

SAMPLE NUMBER	SAMPLE LOCATION	RESULTS in ppm
Claiborn -1	North East Corner	<0.1
Claiborn -2	East Wall	<0.1
Claiborn -3	South East Corner	<0.1
Claiborn -4	North Wall 2' out	<0.1
Claiborn -5	South Wall 2' out	<0.1
Claiborn -6	North Center	<0.1
Claiborn -7	South Center	<0.1
Claiborn -8	North West Corner	<0.1
Claiborn -9	West Wall	<0.1
Claiborn -10	South West Corner	<0.1
Claiborn -11	North West Wall 2' out	<0.1
Claiborn -12	West Wall 2' out	<0.1

Project Name K. L. Luman Project No. KUHL M.001  
 Location Claiborne House Page \_\_\_\_\_ of \_\_\_\_\_  
 Subject Remediation Area By JM Date 5/17/00  
 Ck \_\_\_\_\_ Date \_\_\_\_\_

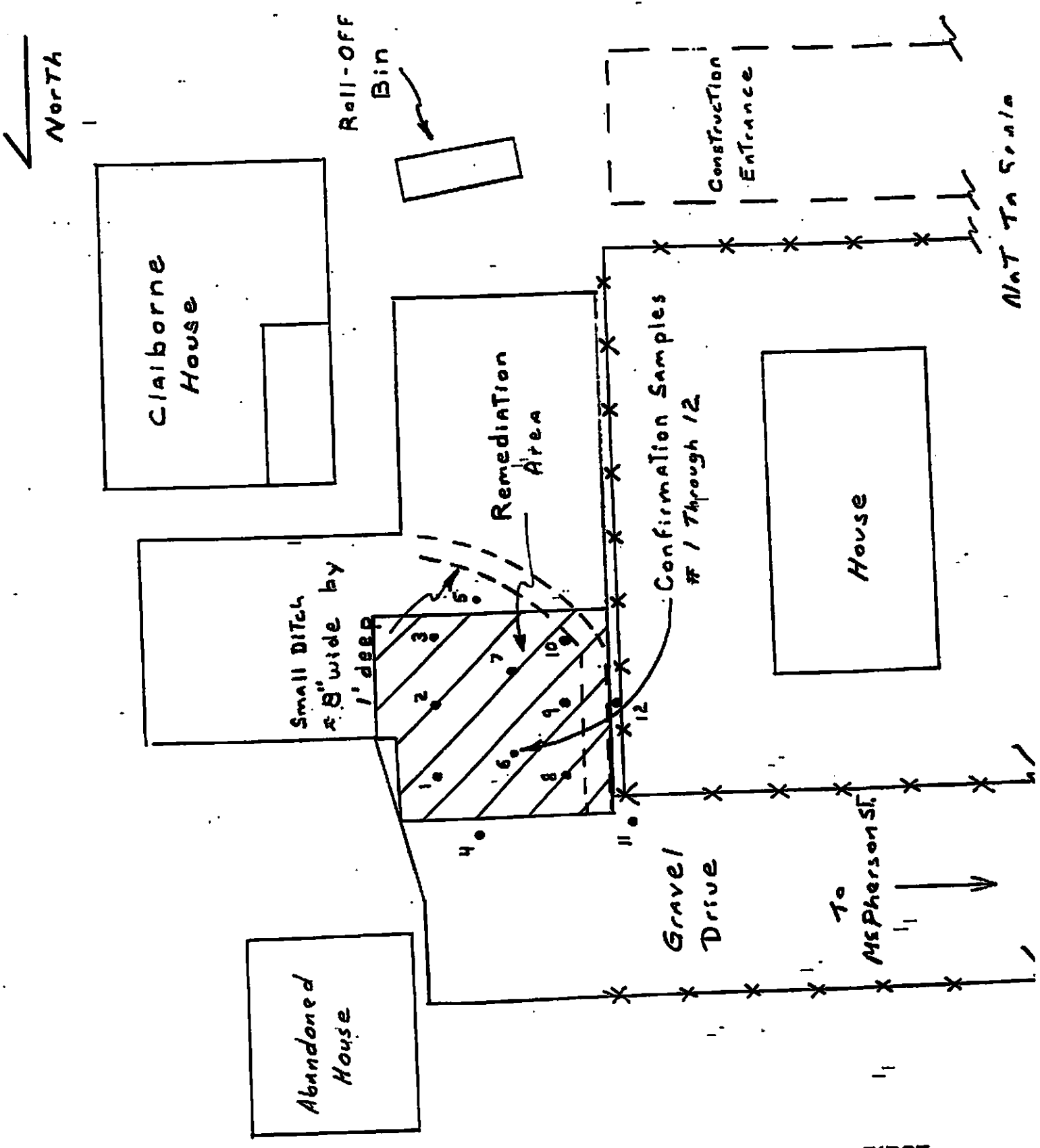

Exhibit #4

216  
McPherson



STATE OF MISSISSIPPI  
HALEY BARBOUR  
GOVERNOR  
MISSISSIPPI DEPARTMENT OF ENVIRONMENTAL QUALITY  
CHARLES H. CHISOLM, EXECUTIVE DIRECTOR

**MEMORANDUM**

**TO:** Kuhlman Electric Site File  
Crystal Springs, MS  
**FROM:** Tony Russell *TJR*  
**DATE:** July 28, 2005  
**SUBJECT:** Moses Stovall, Willie Hackett & ML Berry Meeting

I met with these three men on July 20, 2005 at Moses Stovall house – 413 McPherson Street – to listen to concerns they had regarding soil contamination. Moses Stovall cell number is 601-497-7062.

**Concern 1:** Directly across McPherson Street from 413 McPherson Street is a burial site used 30 to 40 years ago for disposal. The area is an old gravel pit used by the City, KEC and locals for dumping. They are concerned that waste from the KEC facility was disposed in the old gravel pit. There are no noticeable features to identify the area as a landfill or an old gravel pit. According to the three men the pit was approximately 60 to 70 feet deep. A black guy from KEC plant hauled the waste to the old pit. I asked for the name of this person and was told they would get his name and call me. Pictures were taken of this area.

**Concern 2:** The porch of the house at 413 McPherson Street was constructed of soil from the KEC facility. I explained to Mr. Stovall that even if it was true, there is no exposure as the sides are made of brick with a concrete top for the porch floor.

**Concern 3:** M.L. Berry ex-wife (Nell Berry – 601.892.1694) lives at 137 Austin Circle. He worked for KEC and used to get PCB oil on his clothes. His ex-wife is handicapped and he believes it is a result of her washing his clothes. Mr. Berry wants his ex-wife house tested for PCBs.

**Concern 4:** Kaley Claiborne property – soil from the KEC facility was dumped in their back yard back in 2000 about the time the contamination was located at the KEC facility. KEC had people go get the soil from Claiborne's yard and were very quite about the situation. I told them that I would check but I believed that this is one of the properties that were cleaned up back in 2000 after DEQ was notified of the contamination. I would check and verify this property had been cleaned up and if it was then confirmation samples were collected to verify all the contaminated soil was removed. They were concerned that the contaminated soil was washed onto other properties and into the nearby ditch by rain.

**Concern 5:** Nutt and Associates (Plaintiff law firm) told them that several other properties (305 & 308 McPherson Street) on McPherson were highly contaminated. I told them this was new to us as we had written a letter to the Nutt firm requiring them to submit names and locations of all known contaminated areas to MDEQ back in December/January 2005. I also told them that unless someone physically took contaminated soil and dumped it at these addresses, then they should not be contaminated because of where they are located.

**Concern 6:** Mr. Berry mentioned that the oil cars that contained the PCB oil would sit on the railroad spur until unloaded. I told them that unless the tankers were leaking, there should not be a problem.

**Concern 7:** The week of July 4<sup>th</sup> some employees at the KEC facility heard that drums were discovered in the building expansion excavation. They did say it was "hearsay". I spoke with consultants working on the project and they indicated that no drums were observed during any of the excavation work.



**FILE COPY**

**KUHLMAN ELECTRIC  
101 KUHLMAN DRIVE  
CRYSTAL SPRINGS  
MISSISSIPPI**

**FINAL REPORT**

**PREPARED BY:  
Michael Caples, Esq.**

**NOVEMBER 15, 2000**

**FIRST  
ENVIRONMENT**

November 15, 2000

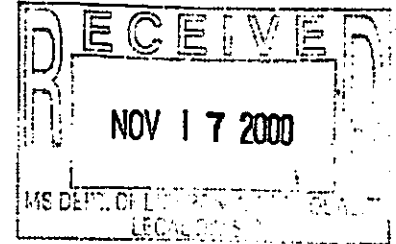

Al Thomas  
Kuhlman Electric  
101 Kuhlman Drive  
Crystal Springs, MS 39059

Scott Schang  
Latham & Watkins  
1001 Pennsylvania Avenue, NW  
Washington, DC 20004

Dear Al and Scott,

Please find below a description of the work performed by First Environment, Inc. and its subcontractors in association with the discovery of polychlorinated biphenyls (PCBs) at the Kuhlman Electric plant in Crystal Springs, Mississippi. This report only deals with the decontamination of equipment and the removal of soil from off-site areas.

#### DECONTAMINATION OF EQUIPMENT

On May 3, 2000, Kuhlman Electric hired First Environment, Inc. to decontaminate earth-moving equipment contaminated during the expansion project. Through the entire month of May, additional items were discovered that needed decontaminating, a detailed list of all items decontaminated by First Environment can be found in Table 1.

Decontamination of the equipment followed the double wash/rinse procedures set forth in 40 C.F.R. 761 Subpart S. First, remove and capture the dry solids by mechanical force (i.e. the use of hammers and scrappers). Second, cover the entire surface with an industrial strength detergent and wash with a steam power washer. Third, capture the rinse water for further treatment. Fourth, repeat. Fifth, verify by confirmation sampling. Finally, remove the equipment from the plant site.

Initial decontamination of equipment began on May 11, 2000 and was completed on May 26, 2000. First Environment, Inc. decontaminated some 17 vehicles. In addition, some other items were cleaned for precautionary reasons, and these items were not included in the report. All confirmation samples taken for each of the 17 pieces of equipment came back as non-detectable. Therefore, no further action is required for the decontamination work.

#### OFF-SITE PROPERTY

During the equipment decontamination, First Environment learned that employees had removed soil and gravel from the plant location. Our investigation uncovered five off-site areas where potentially contaminated material had been removed from the plant location. They are listed below:

1. AKT gravel pit two soil piles on side of road.
2. Allean Meyers Property
3. J. C. Lomax Property
4. Caley Claiborne Property
5. Dwight Holiday Property

On May 16 and 17, 2000 First Environment conducted an emergency removal of PCB contaminated material at five off-site locations. The contaminated material remained in piles or areas that were easily identified by sight. Therefore, in order to expedite the emergency removal of material an extensive soil sampling program was not warranted. Instead, a buffer zone of one to three feet beyond the lateral and vertical extent of the contaminated soil was excavated for each location. Confirmation samples were taken within and outside the excavated area to assure that all contaminated soil was removed from the property. The removed soil was placed in water-tight containers and returned to the Kuhlman property where it awaits final disposal.

#### AKT GRAVEL PIT TWO SOIL PILES

On May 16, 2000, First Environment conducted an emergency removal action of two soil piles located at the AKT Gravel pit. The soil was removed from the Kuhlman property by Vaughan Construction and placed at the gravel pit. Immediately upon discovering the soil piles, First Environment covered the piles with plastic to prevent any run off. Because the piles remained in tact, they were easily removed with a backhoe front-end loader. A buffer zone around the piles of approximately two feet was excavated to assure the removal of all contaminated material. Samples taken after the removal confirmed that the remaining soil was below the action level of 1 ppm. See Exhibit #1 and Table #2 for sample location and results.

### ALLEAN MEYERS PROPERTY

On May 16, 2000 First Environment conducted an emergency removal action of approximately a five-gallon bucket of soil removed from the Kuhlman property at Ms. Allean Meyers property. Meyers's son, an employee of Kuhlman removed a five gallon bucket of soil from the Kuhlman property and placed it in a hole near her house. The hole was clearly defined and the soil was removed with a shovel and placed into a container and returned to the Kuhlman property. The hole was backfilled with clean dirt and no confirmation samples were taken.

### J. C. LOMAX PROPERTY

On May 16, 2000 First Environment conducted an emergency removal action of approximately seven cubic yards of soil removed from the Kuhlman property by Mr. Lomax. The soil was dumped in a pile in Mr. Lomax's pasture where it had remained undisturbed. Upon discovering the pile, First Environment covered the soil with plastic.

Excavation of the soil consisted of using a rubber-tire backhoe to remove the soil pile. In addition, a buffer zone of approximately two feet around and one foot below the pile was removed. Samples taken after the removal confirmed that the remaining soil was clear of any PCB material. See Exhibit #2 and Table #3 for sample location and results.

### CALEY CLAIBORNE PROPERTY

On May 16, 2000 First Environment learned that a composite sample taken from the driveway of Caley Claiborne at 216 McPherson Drive showed the presence of 1644 ppm of PCB - Aroclor 1268. Upon notification of the test results, Kuhlman contacted the Mississippi Department of Environmental Quality, EPA superfund hotline and Region IV TSCA group of the potential release. First Environment proposed to Jerry Banks of MDEQ that an emergency removal action occur as soon as possible.

On May 17, 2000 First Environment conducted an emergency removal of PCB material at the Claiborne residence. Mr. Claiborne removed soil from the Kuhlman site to fill in a pothole in his driveway. Mr. Claiborne clearly identified the area where the soil was placed and one could clearly see the outline of the pothole. See Exhibit #3 for pothole location and sample location.

Excavation of the area involved using a rubber-tire backhoe to remove the soil within the pothole. In addition, a buffer zone of approximately 3 to 5 feet was created around the pothole and approximately 1 to 1.5 feet below the pothole was excavated. The soil was removed from the property and stored at the Kuhlman plant site awaiting final disposal. Samples collected after the removal confirmed that the remaining soil contained no PCB material. See Exhibit # 4 and Table #4 for sample location and results. The area was backfilled with clean dirt and the driveway was paved with asphalt.

#### DWIGHT HOILDAY PROPERTY AND RESIDENCE

On May 17, 2000 First Environment conducted an emergency removal of PCB material at the Holiday residence. Mr. Holiday removed soil from the Kuhlman plant site to fill in two holes in his backyard, (pool and garden). Samples taken before excavation detected the presence of PCB at 183 ppm and 1.9 ppm respectfully. See Exhibit #6

Excavation was conducted with hand shovels and a front-end loader bobcat. The removed material was placed in a container and returned to the Kuhlman property. Both areas were clearly defined by the fresh dirt and lack of grass. Therefore, a buffer zone of approximately two feet outside the dirt area and one foot below the area was removed. Samples taken after the removal confirmed that the remaining soil was below 0.1 ppm of PCB. See Exhibit #5 and Table #5 for sample location and test results.

On May 18, 2000 First Environment learned that Mr. Holiday had washed his truck used to haul the contaminated soil out in his front yard. Samples from the front yard showed no presence of PCB material and no further action was taken. In addition, Mr. Holiday became concern of possible contamination within his house due to the presence of the soil in the backyard. Wipe samples from the floor and carpet inside the house showed no detection of PCB material. See Exhibit #6 for sample location.

To date, First Environment, has cleanup some 17 vehicles and 5 off-site areas. All confirmation samples have been below action limits. Therefore, no further action remains.

If you have any questions, please do not hesitate to contact me at 957-8967.

Sincerely,

FIRST ENVIRONMENT, INC.



Michael Caples, Esq.  
Regional Office Manager

MC/vg  
Enclosure

cc: U.S. Environment Protection Agency  
Mississippi Department of Environmental Quality

move the soil  
6 feet was  
no hole  
ed at the  
the removal  
Exhibit #4  
filled with clea

**TABLE 1**  
**Equipment Decon List**  
**Kuhlman Electric Project**

Equipment	Results of Confirmation Samples
Mack Truck owned by Mohammed Talle	ND
Mack Truck owned by Perry Wilson	ND
Ford Truck owned by Willie Wilcher	ND
Mack Truck #16 owned by Vaughan Construction	ND
Mack Truck #5 owned by Vaughan Construction	ND
Ford Pickup owned by Caley Claiborne	ND
Chevy Truck owned by Dwight Holiday	ND
Ford Truck owned by J.C. Lomax	ND
Kubota Backhoe BT 900 owned by HY-Teck Sprinkler	ND
Ford Trencher C-3663-6 owned by Ritter Electric	ND
John Deere 310D backhoe owned by Ritter Electric	ND
Air Compressor ACXAS90JD owned by Ritter Electric	ND
John Deere 310D backhoe owned by Fountain Construction	ND
White Dump Truck owned by Ritter Electric	ND
Komatsu Track Hoe owned by Vaughan Construction	ND
Bulldozer owned by Vaughan Construction	ND
Bulldozer owned by AKT gravel	ND

Project Name Kuhlman  
Location AKI Gravel Co.  
Subject Remediation Area + Sample Locations

Project No. KUHLM.001  
Page 1 of 1  
By JM Date 5/17/00  
Ck \_\_\_\_\_ Date \_\_\_\_\_

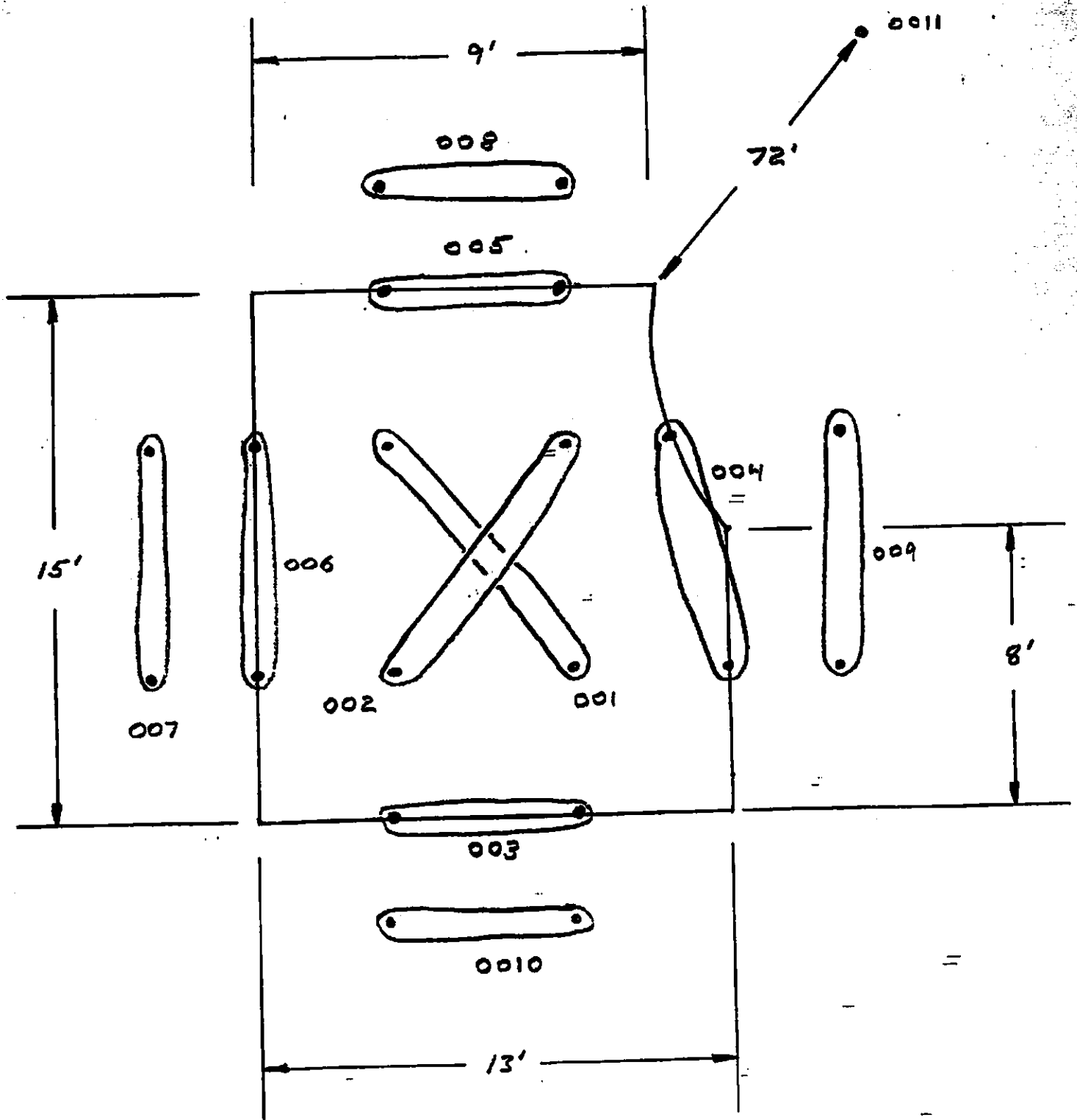

Exhibit # 1

FIRST ENVIRONMENT

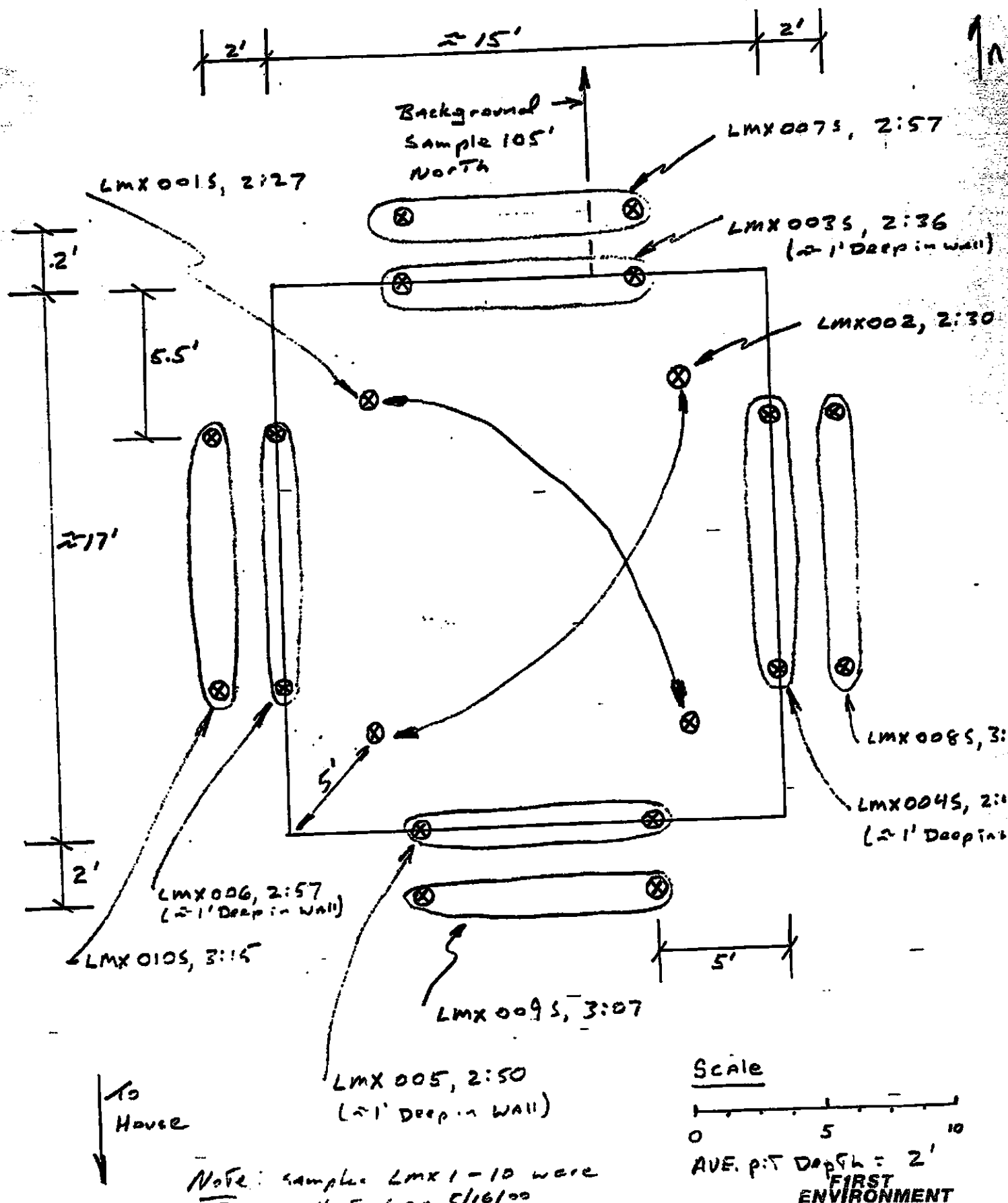

**TABLE # 2**  
**CONFIRMATION SAMPLES AKT GRAVEL PIT**

SAMPLE NUMBER	SAMPLE LOCATION	RESULTS in ppm
gp-001s	gravel pit – SE & NW pit	0.8
gp-002s	gravel pit – SW & NE pit	0.6
gp-003s	gravel pit – North pit	0.3
gp-004s	gravel pit – West pit	0.4
gp-005s	gravel pit – South pit	<0.1
gp-006s	gravel pit – East pit	<0.1
gp-007s	gravel pit – East wall 2' out	<0.1
gp-008s	gravel pit – South wall 2' out	<0.1
gp-009s	gravel pit – West wall 2' out	<0.1
gp-010s	gravel pit – North wall 2' out	<0.1
gp-011s	Background 72' SW	<0.1

Project Name KUHIMAS Soil  
 Location LOMAX House  
 Subject Post Soil Removal Soil Samples

Project No. KUHIM.001  
 Page \_\_\_\_\_ of \_\_\_\_\_  
 By JM Date 5/16/00  
 Ck \_\_\_\_\_ Date \_\_\_\_\_



Note: samples LMX1-10 were collected on 5/16/00  
 LMX011 was collected on 5/17/00

**TABLE #3**  
**CONFIRMATION SAMPLES LOMAX PROPERTY**

SAMPLE NUMBER	SAMPLE LOCATION	RESULTS in ppm FS in ppt
Lmx-001s	NW & SE pit	<0.1
Lmx-002s	NE & SW pit	<0.1
Lmx-003s	North wall	<0.1
Lmx-004s	East wall	<0.1
Lmx-005s	South wall	<0.1
Lmx-006s	West wall	<0.1
Lmx-007s	North wall 2' out	<0.1
Lmx-008s	East wall 2' out	<0.1
Lmx-009s	South wall 2' out	<0.1
Lmx-010s	West wall 2' out	<0.1
Lmx-011s	Background	<0.1

Project Name Kuhlman  
Location Claiborne House  
Subject Fill Area And Sample Location

Project No. KUHLM.001  
Page \_\_\_\_\_ of \_\_\_\_\_  
By JM Date 5/17/90  
Ck \_\_\_\_\_ Date \_\_\_\_\_

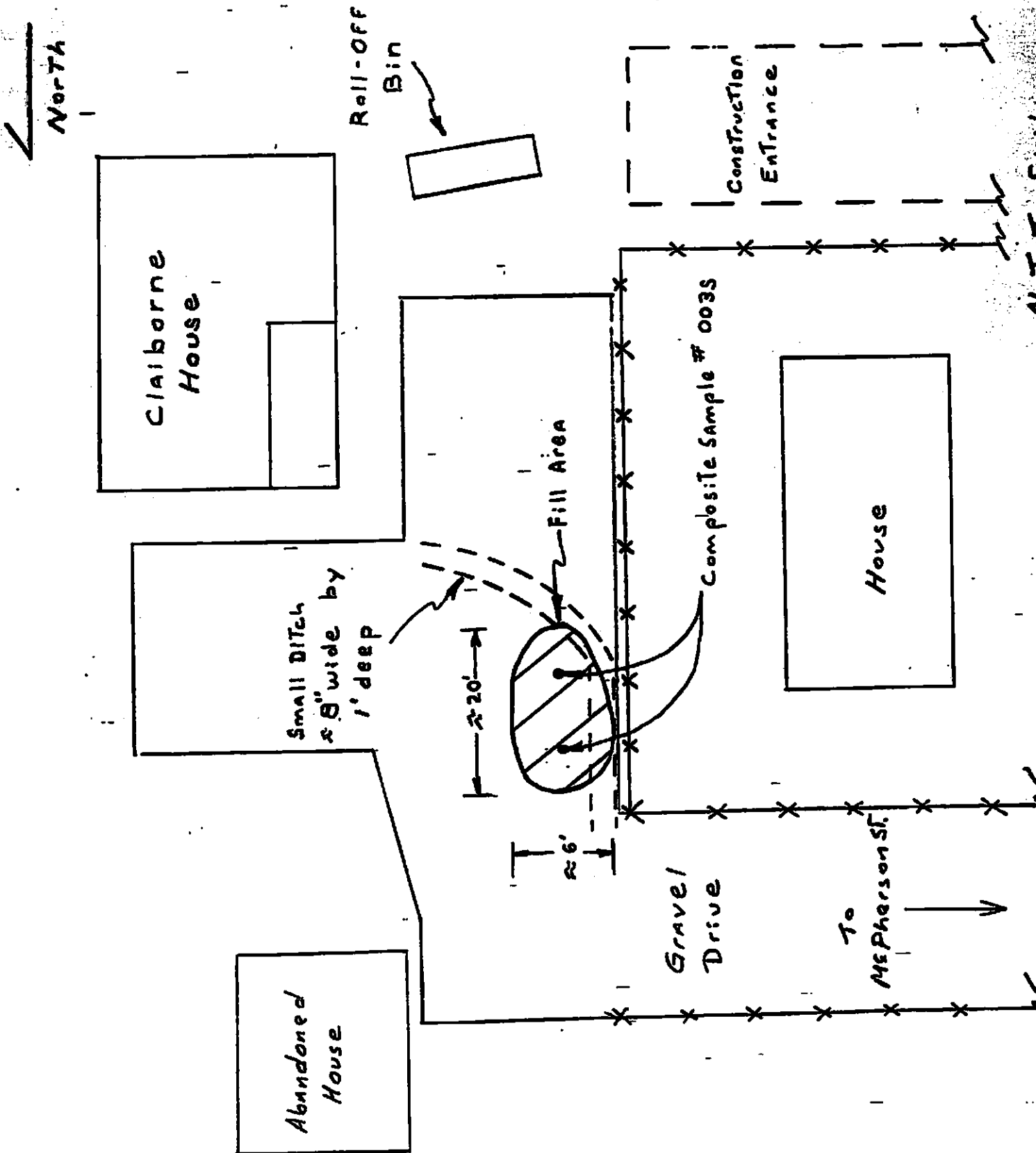

Exhibit #3

**TABLE # 4**  
**CONFIRMATION SAMPLES CLAIBORN PROPERTY**

SAMPLE NUMBER	SAMPLE LOCATION	RESULTS In ppm
Claiborn -1	North East Corner	<0.1
Claiborn -2	East Wall	<0.1
Claiborn -3	South East Corner	<0.1
Claiborn -4	North Wall 2' out	<0.1
Claiborn -5	South Wall 2' out	<0.1
Claiborn -6	North Center	<0.1
Claiborn -7	South Center	<0.1
Claiborn -8	North West Corner	<0.1
Claiborn -9	West Wall	<0.1
Claiborn -10	South West Corner	<0.1
Claiborn -11	North West Wall 2' out	<0.1
Claiborn -12	West Wall 2' out	<0.1

Project Name Kuhlman  
Location Claiborne House  
Subject Remediation Area

Project No. KUHL.M.001  
Page \_\_\_\_\_ of \_\_\_\_\_  
By JM Date 5/17/90  
Ck \_\_\_\_\_ Date \_\_\_\_\_

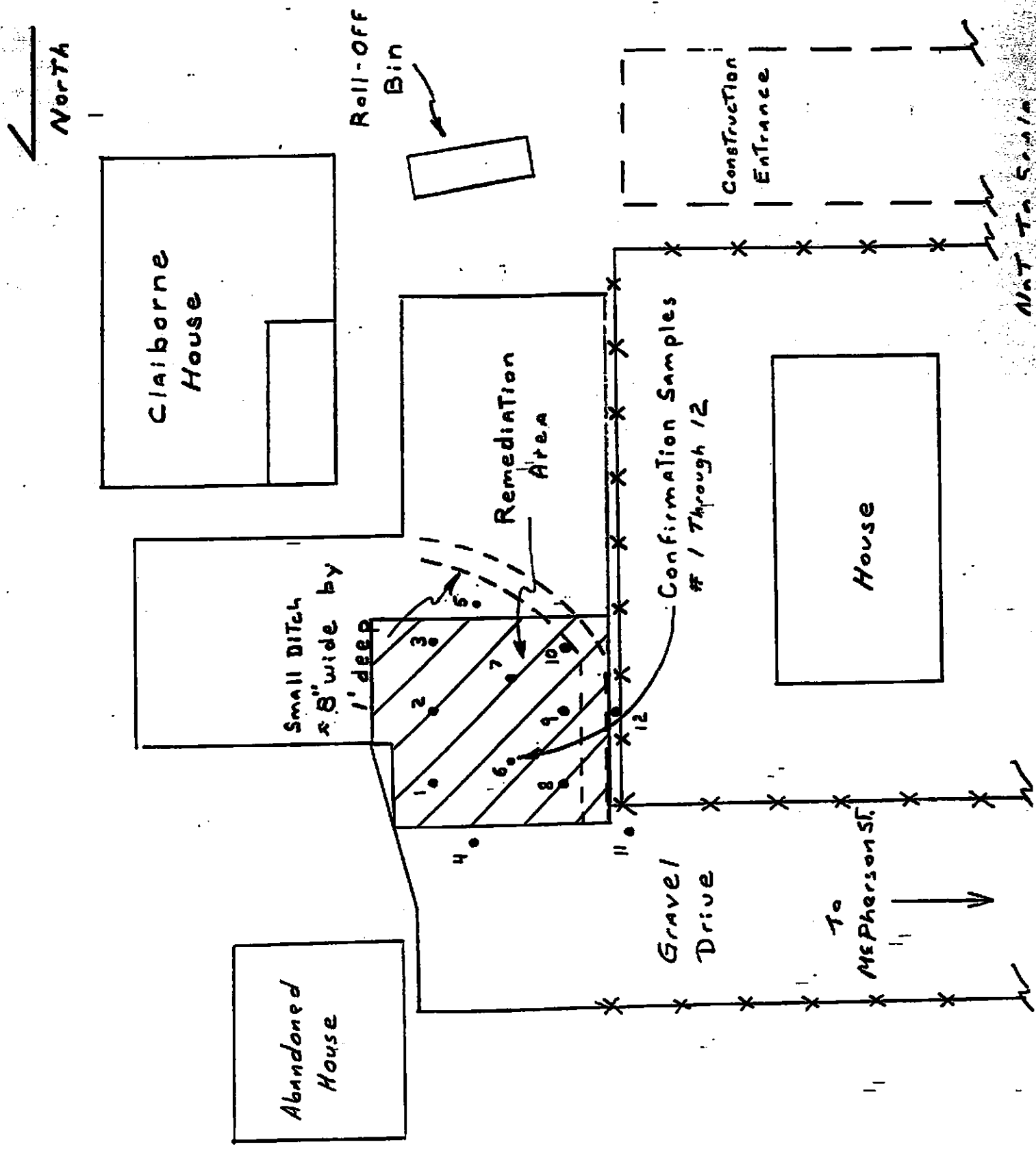

Exhibit #4

**TABLE # 5  
CONFIRMATION RESULTS HOLIDAY RESIDENCE**

<b>Sample Number</b>	<b>Sample Location</b>	<b>Result in ppm</b>
2ful001s	Garden – SE & NE Corners	<0.1
2ful002s	Garden – SW & NE Corners	<0.1
2ful003s	Garden- East Wall	<0.1
2ful004s	Garden- North Wall	<0.1
2ful005s	Garden- West Wall	<0.1
2ful006s	Garden- South Wall	<0.1
2ful007s	Garden- East Wall 2' out	<0.1
2ful008s	Garden- North Wall 2' out	<0.1
2ful009s	Garden- West Wall 2' out	<0.1
2ful010s	Garden- South Wall 2' out	<0.1
2ful011s	Background	<0.1
2ful012s	Strip NE of Garden	<0.1
2ful013s	Pool - SE & NW Corners	<0.1
2ful014s	Pool – SW & NE Corners	<0.1
2ful015s	Pool – East Wall	<0.1
2ful016s	Pool – North Wall	<0.1
2ful017s	Pool – West Wall	<0.1
2ful018s	Pool – South Wall	<0.1
2ful019s	Pool – East Wall 2' out	<0.1
2ful020s	Pool – North Wall 2' out	<0.1
2ful021s	Pool – West Wall 2' out	<0.1
2ful022s	Pool – South Wall 2' out	<0.1

Project Name Kuhlman Soil

Project No. KUHLM.001

Location Dwight Holiday House

Page \_\_\_\_\_ of \_\_\_\_\_

Subject Remediation Area and Sample Locations

By \_\_\_\_\_ Date \_\_\_\_\_

303 Fulgham Ave

Ck \_\_\_\_\_ Date \_\_\_\_\_

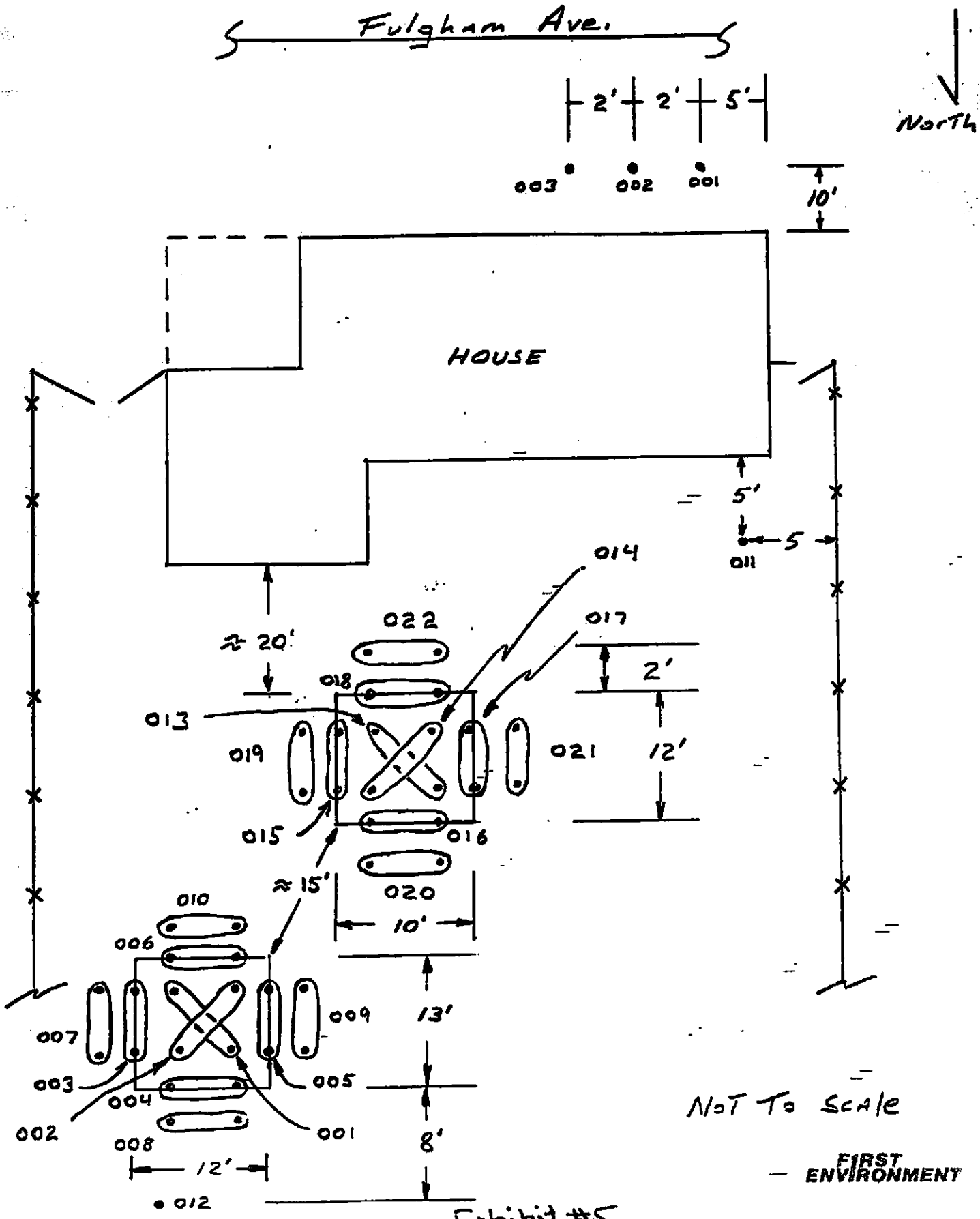



owner: Dwight Holiday  
 303 Fulgham Ave.  
 Phone: \_\_\_\_\_

FENCE

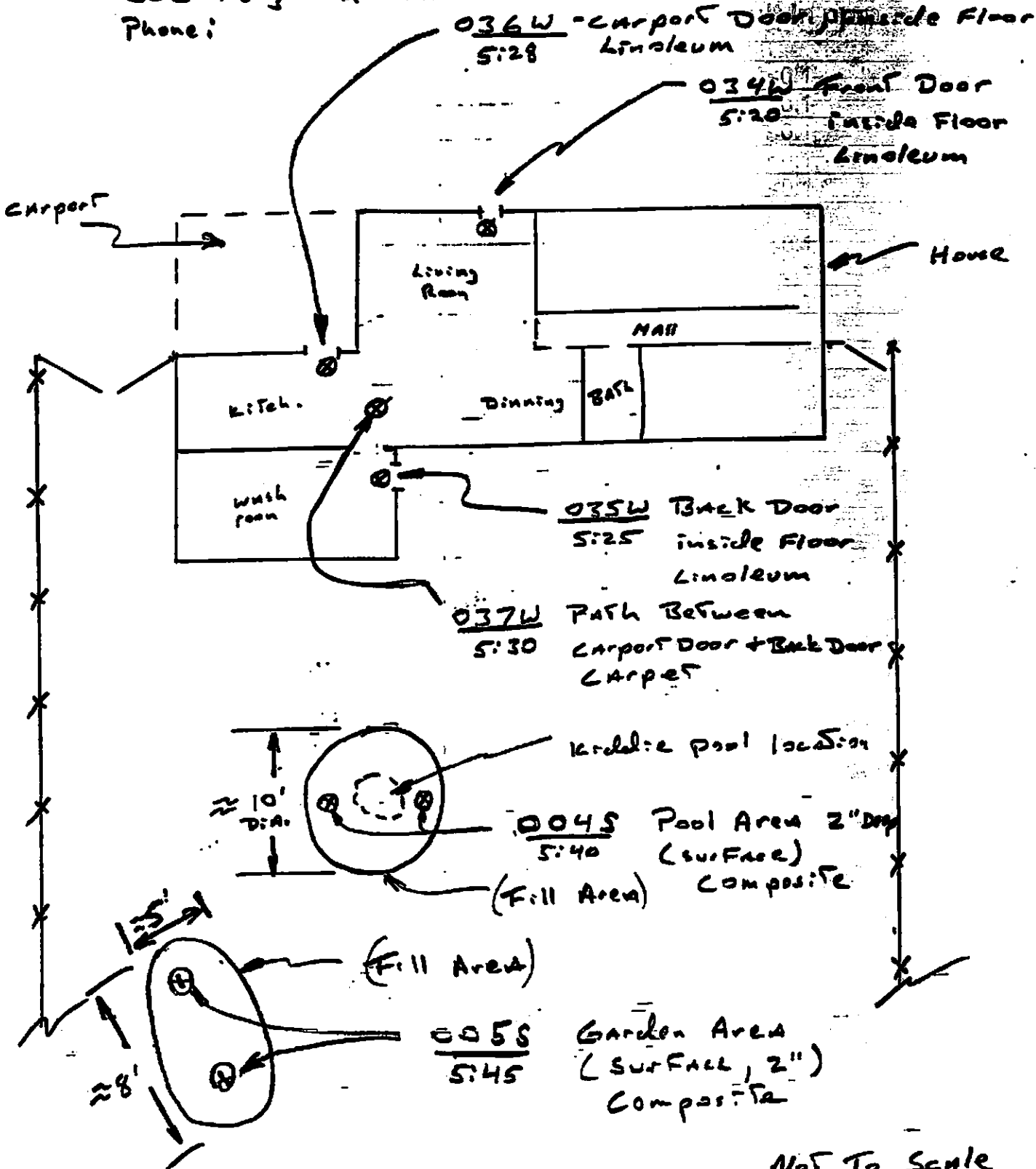

NOT TO SCALE  
**FIRST ENVIRONMENT**

**LAB RESULTS OF ALL TESTING**

**Attached is a listing of all laboratory results including Wipe samples.**

Date	Sample ID	Lab ID #	Matrix	Location	Conc, ppm
5/11/2000	034w	48663	wipe	303 fulghan-front door floor-inside	ND
5/11/2000	035w	48664	wipe	303 fulghan back door floor inside	ND
5/11/2000	036w	48665	wipe	303 fulghan carport door floor inside	ND
5/11/2000	037w	48666	wipe	303 fulghan path between back & carport door	ND
5/11/2000	038w	48667	wipe	pick up truck-tag # sy9258-front center bed	ND
5/11/2000	039w	48668	wipe	pick up truck-tag # sy9258-rear center bed	ND
5/11/2000	040w	48669	wipe	pick up truck-tag#sy9258-tailgate handle	ND
5/11/2000	041w	48670	wipe	pick up truck-tag#sy9258-driver side door handle	ND
5/11/2000	042w	48671	wipe	pick up truck-tag#sy9258-passenger side door handle	ND
5/11/2000	043w	48672	wipe	pick up truck-tag#sy9258-steering wheel	ND
5/11/2000	044w	48673	wipe	pick up truck-tag#sy9258-gear shift knob and turn signal	ND
5/11/2000	045w	48674	wipe	pick up truck-tag#sy9258-driver side arm rest	ND
5/11/2000	046w	48675	wipe	pick up truck-tag#sy9258-gas and clutch pedal	ND
5/11/2000	047w	48676	wipe	pick up truck-tag#sy9258-floor board driver side	ND
5/11/2000	048w	48677	wipe	pick up truck-tag#sy9258-floor mat driver side	ND
5/11/2000	023w	48678	wipe	pick up truck-tag#sy7716-rear center of bed	ND
5/11/2000	024w	48679	wipe	pick up truck-tag#sy7716-front center of bed	ND
5/11/2000	025w	48680	wipe	pick up truck-tag#sy7716-tool box rear side	ND
5/11/2000	026w	48681	wipe	pick up truck-tag#sy7716-tall gate handle	ND
5/11/2000	027w	48682	wipe	pick up truck-tag#sy7716-driver side arm rest	ND
5/11/2000	028w	48683	wipe	pick up truck-tag#sy7716-driver side door handle	ND
5/11/2000	029w	48684	wipe	pick up truck-tag#sy7716-brake & gas pedal	ND
5/11/2000	030w	48685	wipe	pick up truck-tag#sy7716-steering wheel	ND
5/11/2000	031w	48686	wipe	pick up truck-tag#sy7716-gear shift & blinker	ND
5/11/2000	032w	48687	wipe	pick up truck-tag#sy7716-driver side floor board	ND
5/11/2000	033w	48688	wipe	pick up truck-tag#sy7716-passenger side door handle	ND
5/11/2000	001s	48689	soil	pick up bed -tag sy7716	583
5/11/2000	002s	48690	soil	pickup bed tag sy9258	ND
5/11/2000	003s	48691	soil	216 McPherson -Driveway	1644
5/11/2000	004s	48692	soil	303 Fulghan-Pool area	183
5/11/2000	005s	48693	soil	303 Fulghan - garden area	1.9
5/11/2000	001w	48840	wipe	213 Powell St.-corner bookshelf-left side	ND
5/11/2000	002w	48841	wipe	213 Powell St.-corner bookshelf-right side	ND
5/11/2000	003w	48842	wipe	213 Powell St.-corner bookshelf-bottom	ND

5/11/2000	005w	48844	wipe	213 Powell St.-book shelf right side	ND
5/11/2000	006w	48845	wipe	213 Powell St.-book shelf bottom	ND
5/11/2000	007w	48846	wipe	213 Powell St.-bookshelf back	ND
5/11/2000	008w	48847	wipe	213 Powell St.-bookshelf - shelf	ND
5/11/2000	009w	48848	wipe	213 Powell St.-corner bookshelf -shelf	ND
5/11/2000	010w	48849	wipe	213 Powell St.-desk hutch-bottom	ND
5/11/2000	011w	48850	wipe	213 Powell St.-desk hutch-left side	ND
5/11/2000	012w	48851	wipe	213 Powell St.-desk hutch-right side	ND
5/11/2000	013w	48852	wipe	213 Powell St.-desk hutch-shelf	ND
5/11/2000	014w	48853	wipe	213 Powell St.-desk hutch-back	ND
5/11/2000	015w	48854	wipe	213 Powell St.-desk stool- top	ND
5/11/2000	016w	48855	wipe	213 Powell St.-desk stool- bpttom legs	ND
5/11/2000	017w	48856	wipe	213 Powell St.-desk stool- side	ND
5/11/2000	018w	48857	wipe	213 Powell St.-desk top	ND
5/11/2000	019w	48858	wipe	213 Powell St.-desk left side	ND
5/11/2000	020w	48859	wipe	213 Powell St.-desk right side	ND
5/11/2000	021w	48860	wipe	213 Powell St.-desk bottom	ND
5/11/2000	022w	48861	wipe	213 Powell St.-desk front	ND
5/1/2000	ful303-001	48697	soil	front yard wash area -fulgham 303	4.49
5/12/2000	27-001	48826	wipe	dump truck #27 tag # a15158-gas & brake pedal	ND
5/12/2000	27-002	48827	wipe	dump truck #27 tag # a15158-gear shift & turn signal	ND
5/12/2000	27-003	48828	wipe	dump truck #27 tag # a15158-steering wheel	ND
5/12/2000	27-004	48829	wipe	dump truck #27 tag # a15158-driver side floor board	ND
5/12/2000	27-005	48830	wipe	dump truck #27 tag # a15158-passenger side door handle	ND
5/12/2000	27-006	48831	wipe	dump truck #27 tag # a15158-front center of bed	ND
5/12/2000	27-007	48832	wipe	dump truck #27 tag # a15158-passenger side inner bed wall	ND
5/12/2000	27-008	48833	wipe	dump truck #27 tag # a15158-rear center of bed	ND
5/12/2000	27-009	48834	wipe	dump truck #27 tag # a15158-passenger side inner tailgate	ND
5/12/2000	27-010	48835	wipe	dump truck #27 tag # a15158-bed lip	ND
5/12/2000	27-011	48836	wipe	dump truck #27 tag # a15158-driver side inner tailgate	ND
5/12/2000	27-012	48837	wipe	dump truck #27 tag # a15158-driver side inner bed wall	ND
5/12/2000	27-013	48838	wipe	dump truck #27 tag # a15158-driver side inner door handle	ND
5/12/2000	27-014	48839	wipe	dump truck #27 tag # a15158-driver side door handle	ND
5/13/2000	56-001	48862	wipe	dump truck#56 steering wheel	ND
5/13/2000	56-002	48863	wipe	dump truck#56 gas & brake pedal	ND
5/13/2000	56-003	48864	wipe	dump truck#56 turn signal & gear shift	ND
5/13/2000	56-004	48865	wipe	dump truck#56 driver side door handle	ND

5/13/2000	56-006	48867	wipe	dump truck#56 passenger side bed wall	ND
5/13/2000	56-007	48868	wipe	dump truck#56 rear center of bed	ND
5/13/2000	56-008	48869	wipe	dump truck#56 duplicate	ND
5/13/2000	56-009	48870	wipe	dump truck#56 bed lip	ND
5/13/2000	56-010	48871	wipe	dump truck#56 passenger side inner tail gate	ND
5/13/2000	56-011	48872	wipe	dump truck#56 driver side inner tail gate	ND
5/13/2000	56-012	48873	wipe	dump truck#56 driver side bed wall	ND
5/13/2000	56-013	48874	wipe	dump truck#56 driver side inner door handle	ND
5/13/2000	56-014	48875	wipe	dump truck#56 passenger side door handle	ND
5/13/2000	56-015	48876	wipe	dump truck#56 driver side floor board	ND
5/13/2000	56-016	48877	wipe	dump truck#56 driver side bed mat	ND
5/13/2000	56-017	48878	wipe	dump truck#56 passenger side bed mat	ND
5/13/2000	lmx-001	48879	wipe	lomag dump truck-tag# f16-536-brake & gas pedal	ND
5/13/2000	lmx-002	48880	wipe	lomag dump truck-tag# f16-536-turn signal & gear shift	ND
5/13/2000	lmx-003	48881	wipe	lomag dump truck-tag# f16-536-steering wheel	ND
5/13/2000	lmx-004	48882	wipe	lomag dump truck-tag# f16-536-passenger side door handle	ND
5/13/2000	lmx-005	48883	wipe	lomag dump truck-tag# f16-536-front center of bed	ND
5/13/2000	lmx-006	48884	wipe	lomag dump truck-tag# f16-536-passenger side bedwall	ND
5/13/2000	lmx-007	48885	wipe	lomag dump truck-tag# f16-536-rear center of wall	ND
5/13/2000	lmx-008	48886	wipe	lomag dump truck-tag# f16-536-duplicate	ND
5/13/2000	lmx-009	48887	wipe	lomag dump truck-tag# f16-536-bed lip	ND
5/13/2000	lmx-010	48888	wipe	lomag dump truck-tag# f16-536-passenger side inner tail gate	ND
5/13/2000	lmx-011	48889	wipe	lomag dump truck-tag# f16-536-driver side inner tailgate	ND
5/13/2000	lmx-012	48890	wipe	lomag dump truck-tag# f16-536-driver side bed wall	ND
5/13/2000	lmx-013	48891	wipe	lomag dump truck-tag# f16-536-driver side inner door handle	ND
5/13/2000	lmx-014	48892	wipe	lomag dump truck-tag# f16-536-driver side door handle	ND
5/13/2000	lmx-015	48893	wipe	lomag dump truck-tag# f16-536-driver side floor board	ND
5/13/2000	lmx-016	48894	wipe	lomag dump truck-tag# f16-536-passenger side bed rail	ND
5/13/2000	lmx-017	48895	wipe	lomag dump truck-tag# f16-536-driver side bed rail	ND
5/13/2000	684-001	48896	wipe	dump truck#684-brake & gas pedal	ND
5/13/2000	684-002	48897	wipe	dump truck#684-turn signal & gear shift	ND
5/13/2000	684-003	48898	wipe	dump truck#684-driver side floor board	ND
5/13/2000	684-004	48899	wipe	dump truck#684-steering wheel	ND
5/13/2000	684-005	48900	wipe	dump truck#684-passenger side door handle	ND
5/13/2000	684-006	48901	wipe	dump truck#684-front center of bed	ND
5/13/2000	684-007	48902	wipe	dump truck#684-passenger side bed wall	ND
5/13/2000	684-008	48903	wipe	dump truck#684-passenger side bed rail	ND
5/13/2000	684-009	48904	wipe	dump truck#684-rear center of bed	ND

5/13/2000	684-010	48905	wipe	dump truck#684-duplicate	ND
5/13/2000	684-011	48906	wipe	dump truck#684-passenger side inner tail gate	ND
5/13/2000	684-012	48907	wipe	dump truck#684-bed lip	ND
5/13/2000	684-013	48908	wipe	dump truck#684-driver side inner tail gate	ND
5/13/2000	684-014	48909.1	wipe	dump truck#684-driver side bed rail	ND
5/13/2000	684-015	48910.1	wipe	dump truck#684-driver side bed wall	ND
5/13/2000	684-016	48911.1	wipe	dump truck#684-Driver side inner door handles	ND
5/13/2000	684-017	48912.1	wipe	dump truck#684-driver side door handles	ND
5/13/2000	874-001	49042	wipe	dump truck#874-gas & brake pedal	ND
5/13/2000	874-002	49043	wipe	dump truck#874-gear shift & turn signal	ND
5/13/2000	874-003	49044	wipe	dump truck#874-driver side floor board	ND
5/13/2000	874-004	49045	wipe	dump truck#874-steering wheel	ND
5/13/2000	874-005	49046	wipe	dump truck#874-passenger side door handle	ND
5/13/2000	874-006	49047	wipe	dump truck#874-front center of bed	ND
5/13/2000	874-007	49048	wipe	dump truck#874-passenger side bed wall	ND
5/13/2000	874-008	49049	wipe	dump truck#874-read center of bed	ND
5/13/2000	874-009	49050	wipe	dump truck#874-duplicate	ND
5/13/2000	874-010	49051	wipe	dump truck#874-passenger side inner tail gate	ND
5/13/2000	874-011	49052	wipe	dump truck#874-bed lip	ND
5/13/2000	874-012	49053	wipe	dump truck#874-driver side inner tailgate	ND
5/13/2000	874-013	49054	wipe	dump truck#874-driver side bed wall	ND
5/13/2000	874-014	49055	wipe	dump truck#874-driver side inner door handle	ND
5/13/2000	874-015	49056	wipe	dump truck#874-driver side door handle	ND
5/13/2000	874-016	49057	wipe	dump truck#874-passenger side bed rail	ND
5/13/2000	874-017	49058	wipe	dump truck#874-driver side bed rail	ND
5/17/2000	2ful001s	49059	soil	303 fulghan garden- se & nw corners	<0.1
5/17/2000	2ful002s	49060	soil	303 fulghan garden sw&ne corners	<0.1
5/17/2000	2ful003s	49061	soil	303 fulghan garden-east wall	<0.1
5/17/2000	2ful004s	49062	soil	303 fulghan garden-north wall	<0.1
5/17/2000	2ful005s	49063	soil	303 fulghan garden-west wall	<0.1
5/17/2000	2ful006s	49064	soil	303 fulghan-garden-south wall	<0.1
5/17/2000	2ful007s	49065	soil	303 fulghan-garden east wall 2' out	<0.1
5/17/2000	2ful008s	49066	soil	303 fulghan-garden north wall 2' out	<0.1
5/17/2000	2ful009s	49067	soil	303 fulghan-garden west wall 2' out	<0.1
5/17/2000	2ful010s	49068	soil	303 fulghan-garden south wall 2' out	<0.1
5/17/2000	2ful011s	49069	soil	303 fulghan-background	<0.1
5/17/2000	2ful012s	49070	soil	303 fulghan-strip ne of garden	<0.1
				303 fulghan-nonnl se & nw corners	<0.1

5/17/2000	2ful014s	49072	soil	303 fulghan-pool sw & ne corners	<0.1
5/17/2000	2ful015s	49073	soil	303 fulghan-pool-east wall	<0.1
5/17/2000	lhx-001s	49074	soil	nw & se pit	<0.1
5/17/2000	lhx-002s	49075	soil	ne & sw pit	<0.1
5/17/2000	lhx-003s	49076	soil	North wall	<0.1
5/17/2000	lhx-004s	49077	soil	East Wall	<0.1
5/17/2000	lhx-005s	49078	soil	South Wall	<0.1
5/17/2000	lhx-006s	49079	soil	West Wall	<0.1
5/17/2000	lhx-007s	49080	soil	Northwall 2ft Out	<0.1
5/17/2000	lhx-008s	49081	soil	East Wall 2 ft Out	<0.1
5/17/2000	lhx-009s	49082	soil	South Wall 2 ft. Out	<0.1
5/17/2000	lhx-010s	49083	soil	West Wall 2 ft. Out	<0.1
5/17/2000	lhx-011s	49084	soil	Back Ground	0.8
5/17/2000	gp-001s	49090	soil	Gravel Pit- SE & NW pit	0.6
5/17/2000	gp-002s	49091	soil	Gravel Pit- SW & NE pit	0.3
5/17/2000	gp-003s	49092	soil	Gravel Pit- NORTH pit	0.4
5/17/2000	gp-004s	49093	soil	Gravel Pit- WEST pit	<0.1
5/17/2000	gp-005s	49094	soil	Gravel Pit- SOUTH pit	<0.1
5/17/2000	gp-006s	49095	soil	Gravel Pit- EAST pit	<0.1
5/17/2000	gp-007s	49096	soil	Gravel Pit- EAST WALL 2 FT. OUT	<0.1
5/17/2000	gp-008s	49097	soil	Gravel Pit- SOUTH WALL 2 FT. OUT	<0.1
5/17/2000	gp-009s	49098	soil	Gravel Pit- WEST WALL 2 FT. OUT	<0.1
5/17/2000	gp-0010s	49099	soil	Gravel Pit- NORTH WALL 2 FT. OUT	<0.1
5/17/2000	gp-0011s	49100	soil	BACKGROUND 72' SW	<0.1
5/17/2000	2ful016s	49101	soil	303 fulghan-pool north wall	<0.1
5/17/2000	2ful017s	49102	soil	303 fulghan-pool west wall	<0.1
5/17/2000	2ful018s	49103	soil	303 fulghan-pool south wall	<0.1
5/17/2000	2ful019s	49104	soil	303 fulghan-pool east wall 2' out	<0.1
5/17/2000	2ful020s	49105	soil	303 fulghan-pool north wall 2' out	<0.1
5/17/2000	2ful021s	49106	soil	303 fulghan-pool west wall 2' out	<0.1
5/17/2000	2ful022s	49107	soil	303 fulghan-pool south wall 2' out	ND
5/17/2000	156-001	49085	wipe	Mr. Prine Pickup tag SZZVS6-front center of bed	ND
5/17/2000	156-002	49086	wipe	Mr. Prine Pickup tag SZZVS6-passenger side wall	ND
5/17/2000	156-003	49087	wipe	Mr. Prine Pickup tag SZZVS6-rear center of bed	ND
5/17/2000	156-004	49088	wipe	Mr. Prine Pickup tag SZZVS6-tail gate center	ND
5/17/2000	156-005	49089	wipe	Mr. Prine Pickup tag SZZVS6-driver side wall	ND
5/17/2000	vau-001	49108	wipe	AC-001 compressor-front	ND
5/17/2000				AC-001 compressor-left side of compressor	ND

5/19/2000	vau-003	49110	wipe	AC-001 compressor-rear	ND
5/19/2000	vau-004	49111	wipe	AC-001 compressor-right fender	ND
5/19/2000	vau-005	49112	wipe	AC-001 compressor-tool box	ND
5/19/2000	vau-006	49113	wipe	Tractor TH001-left side of trench hoe	ND
5/19/2000	vau-007	49114	wipe	Tractor TH001-right side of trench hoe	ND
5/19/2000	vau-008	49115	wipe	Tractor TH001-steering wheel	ND
5/19/2000	vau-009	49116	wipe	Tractor TH001-left fender	ND
5/19/2000	vau-010	49117	wipe	Tractor TH001-break & gas pedal	ND
5/19/2000	vau-011	49118	wipe	Tractor TH001-left side of front grader	ND
5/23/2000	front yard 1	49119	wipe	303 fulghan-front yard 1	<0.1
5/23/2000	front yard 2	49120	wipe	303 fulghan-front yard 2	<0.1
5/23/2000	front yard 3	49121	wipe	303 fulghan-front yard 3	<0.1
5/18/2000	Claiborn-1	49122	soil	Claiborn Res-Driveway	<0.1
5/18/2000	Claiborn-2	49123	soil	Claiborn Res-Driveway	<0.1
5/18/2000	Claiborn-3	49124	soil	Claiborn Res-Driveway	<0.1
5/18/2000	Claiborn-1	49125	soil	Claiborn Clearnace	<0.1
5/18/2000	Claiborn-2	49126	soil	Claiborn Clearnace	<0.1
5/18/2000	Claiborn-3	49127	soil	Claiborn Clearnace	<0.1
5/18/2000	Claiborn-4	49128	soil	Claiborn Clearnace	<0.1
5/18/2000	Claiborn-5	49129	soil	Claiborn Clearnace	<0.1
5/18/2000	Claiborn-6	49130	soil	Claiborn Clearnace	<0.1
5/18/2000	Claiborn-7	49131	soil	Claiborn Clearnace	<0.1
5/18/2000	Claiborn-8	49132	soil	Claiborn Clearnace	<0.1
5/18/2000	Claiborn-9	49133	soil	Claiborn Clearnace	<0.1
5/18/2000	Claiborn-10	49134	soil	Claiborn Clearnace	<0.1
5/18/2000	Claiborn-11	49135	soil	Claiborn Clearnace	<0.1
5/18/2000	Claiborn-12	49136	soil	Claiborn Clearnace	<0.1
5/23/2000	lue Tractor	49144	wipe	Blue Tractor1	<0.1
5/23/2000	lue Tractor	49145	wipe	Blue Tractor 2	<0.1
5/23/2000	lue Tractor	49146	wipe	Blue Tractor3	<0.1
5/23/2000	lue Tractor	49147	wipe	Blue Tractor4	<0.1
5/23/2000	lue Tractor	49148	wipe	Blue Tractor 5	<0.1
5/23/2000	lue Tractor	49149	wipe	Blue Tractor 6	<0.1
5/23/2000	lue Tractor	49150	wipe	Blue Tractor 7	<0.1
5/23/2000	Bull Dozer 1	49151	wipe	Bull Dozer 1	4.3
5/23/2000	Bull Dozer 2	49152	wipe	Bull Dozer 2	6.1
5/24/2000	AC201	49153	wipe	Air Compressor right front panel	ND
				Air Compressor right back panel	ND



5/24/2000	AC 203	49155	wipe	Air Compressor hammer	ND
5/24/2000	AC 204	49156	wipe	Air Compressor front tongue	ND
5/24/2000	AC205	49157	wipe	Air Compressor left panel	ND
5/24/2000	AC206	49158	wipe	Air Compressor r. rear panel	ND
5/24/2000	KT-1	49159	wipe	Kubota tractor right inside bucket	ND
5/24/2000	KT2	49160	wipe	Kubota tractor left inside bucket	ND
5/24/2000	KT3	49161	wipe	Kubota right front tire	ND
5/24/2000	KT4	49162	wipe	Kubota left front tire	ND
5/24/2000	KT5	49163	wipe	Kubota right foot step	ND
5/24/2000	KT6	49164	wipe	Kubota cab floor	ND
5/24/2000	KT7	49165	wipe	Kubota steering wheel	ND
5/24/2000	KT8	49166	wipe	Kubota brake pedal	ND
5/24/2000	KT9	49167	wipe	Kubota right arm brace pad	ND
5/24/2000	KT10	49168	wipe	Kubota left brace arm pad	ND
5/24/2000	KT11	49169	wipe	Kubota inside rear bucket	ND
5/24/2000	KT12	49170	wipe	Kubota outside rear bucket teeth	0.5
5/24/2000	KT 13	49171	wipe	Kubota bottom outside rear bucket	ND
5/24/2000	KT14	49172	wipe	Kubota arm rest right	ND
5/24/2000	KT15	49173	wipe	Kubota arm rest left	ND
5/24/2000	n/a	49174	n/a	no sample collected	na
5/24/2000	007	49175	wipe	wt. Pump truck-front center of bed	ND
5/24/2000	008	49176	wipe	wt. Pump truck-passenger side wall	ND
5/24/2000	009	49177	wipe	wt. Pump truck-rear center of bed	ND
5/24/2000	010	49178	wipe	wt. Pump truck-passenger side tailgate	ND
5/24/2000	011	49179	wipe	wt. Pump truck tailgate lip	ND
5/24/2000	012	49180	wipe	wt. Pump truck driver side tailgate	ND
5/24/2000	013	49181	wipe	wt. Pump truck driver side wall	ND
5/24/2000	014	49182	wipe	wt. Pump truck passenger side door handle	ND
5/24/2000	015	49183	wipe	wt. Pump truck driver side rail	ND
5/24/2000	016	49184	wipe	wt. Pump truck passenger side wall	ND
5/24/2000	017	49185	wipe	wt. Pump truck driver side door handle	ND
5/24/2000	T01	49186	wipe	Track Hoe-front inside right bucket	ND
5/24/2000	T02	49187	wipe	Track Hoe -front inside left front bucket	ND
5/24/2000	T03	49188	wipe	Track Hoe-right front tire	0.3
5/24/2000	T04	49189	wipe	Track Hoe-right foot step	ND
5/24/2000	T05	49190	wipe	Track Hoe Steering wheel	ND
5/24/2000	T06	49191	wipe	Track Hoe-floor	ND

Track Hoe Brake pad

5/24/2000	T08	49193	wipe	Track Hoe right arm rest	ND
5/24/2000	T09	49194	wipe	Track Hoe right bracing arm pad	ND
5/24/2000	T10	49195	wipe	Track Hoe inside rear Bucket	ND
5/24/2000	T11	49196	wipe	Track Hoe left inside Bucket	ND
5/24/2000	T13	49197	wipe	Track Hoe Outside Bucket	ND
5/24/2000	T14	49198	wipe	Track Hoe left Brace arm pad	ND
5/24/2000	T15	49199	wipe	Track Hoe foot step	ND
5/24/2000	BH01	49200	wipe	Back Hoe right inside front bucket	ND
5/24/2000	BH02	49201	wipe	Back Hoe left inside front bucket	ND
5/24/2000	BH03	49202	wipe	Back Hoe right outside front bucket	ND
5/24/2000	BH04	49203	wipe	Back Hoe left outside front bucket	ND
5/24/2000	BH05	49204	wipe	Back Hoe right front tire	ND
5/24/2000	BH06	49205	wipe	Back Hoe left tire	ND
5/24/2000	BH07	49206	wipe	Back Hoe stirring wheel	ND
5/24/2000	BH08	49207	wipe	Back Hoe brake pedal	ND
5/24/2000	BH09	49208	wipe	Back Hoe right arm rest	ND
5/24/2000	BH10	49209	wipe	Back Hoe floor	ND
5/24/2000	BH11	49210	wipe	Back Hoe left bracing arm pad	ND
5/24/2000	BH12	49211	wipe	Back Hoe right bracing arm pad	ND
5/24/2000	BH13	49212	wipe	Back Hoe inside rear bucket	ND
5/24/2000	BH14	49213	wipe	Back Hoe outside teeth rear bucket	ND
5/24/2000	BH16	49214	wipe	Back Hoe outside rear bucket bottom	ND
5/24/2000	BD001	49215	wipe	Bulldozer front left blade	ND
5/24/2000	BD002	49216	wipe	Bulldozer front middle blade	ND
5/24/2000	BD003	49217	wipe	Bulldozer front right blade	ND
5/24/2000	BD004	49218	wipe	Bulldozer right brake paddle	ND
5/24/2000	BD005	49219	wipe	Bulldozer left brake paddle	ND
5/24/2000	BD006	49220	wipe	Bulldozer floor	ND
5/24/2000	BD007	49221	wipe	Bulldozer seat	ND
5/24/2000	BD008	49222	wipe	Bulldozer right arm rest	ND
5/24/2000	BD009	49223	wipe	Bulldozer left arm rest	ND
5/24/2000	BD010	49224	wipe	Bulldozer outer skin right side	ND
5/24/2000	BD011	49225	wipe	Bulldozer right outside track	ND
5/24/2000	BD012	49226	wipe	Bulldozer right outside track	ND
5/24/2000	BD013	49227	wipe	Bulldozer right outside track	ND
5/24/2000	BD014	49228	wipe	Bulldozer right outside track	ND
5/24/2000	BD015	49229	wipe	Bulldozer right inside track	ND
				12 months middle front skin plate	ND

5/24/2000	KOM047	49231	wipe	Komsuto right front skin plate	ND
5/24/2000	KOM048	49232	wipe	Komsuto left front skin plate	ND
5/24/2000	KOM049	49233	wipe	Komsuto left back skin plate	ND
5/24/2000	KOM050	49234	wipe	Komsuto right back skin plate	ND
5/24/2000	KOM031	49235	wipe	Komsuto right outside track	ND
5/24/2000	KOM032	49236	wipe	Komsuto right outside track	ND
5/24/2000	KOM033	49237	wipe	Komsuto right outside track	ND
5/24/2000	KOM034	49238	wipe	Komsuto right outside track	ND
5/24/2000	KOM035	49239	wipe	Komsuto right outside track	ND
5/24/2000	KOM036	49240	wipe	Komsuto right inside track	ND
5/24/2000	KOM037	49241	wipe	Komsuto right inside track	ND
5/24/2000	KOM038	49242	wipe	Komsuto right inside track	ND
5/24/2000	KOM039	49243	wipe	Komsuto right inside track	ND
5/24/2000	KOM040	49244	wipe	Komsuto right inside track	ND
5/24/2000	KOM041	49245	wipe	Komsuto right middle track	ND
5/24/2000	KOM042	49246	wipe	Komsuto right middle track	ND
5/24/2000	KOM043	49247	wipe	Komsuto right middle track	ND
5/24/2000	KOM044	49248	wipe	Komsuto right middle track	ND
5/24/2000	KOM045	49249	wipe	Komsuto right middle track	ND
5/24/2000	KOM016	49250	wipe	Komsuto left inside track	ND
5/24/2000	KOM017	49251	wipe	Komsuto left inside track	ND
5/24/2000	KOM018	49252	wipe	Komsuto left inside track	ND
5/24/2000	KOM019	49253	wipe	Komsuto left inside track	ND
5/24/2000	KOM020	49254	wipe	Komsuto left inside track	ND
5/24/2000	KOM021	49255	wipe	Komsuto left middle track	ND
5/24/2000	KOM022	49256	wipe	Komsuto left middle track	ND
5/24/2000	KOM023	49257	wipe	Komsuto left middle track	ND
5/24/2000	KOM024	49258	wipe	Komsuto left middle track	ND
5/24/2000	KOM025	49259	wipe	Komsuto left middle track	ND
5/24/2000	KOM026	49260	wipe	Komsuto floor	ND
5/24/2000	KOM027	49261	wipe	Komsuto right foot paddle	ND
5/24/2000	KOM028	49262	wipe	Komsuto left foot paddle	ND
5/24/2000	KOM029	49263	wipe	Komsuto right stick	ND
5/24/2000	KOM030	49264	wipe	Komsuto seat	ND
5/24/2000	KOM001	49265	wipe	Komsuto inside left bucket	ND
5/24/2000	KOM002	49266	wipe	Komsuto inside left wall bucket	ND
5/24/2000	KOM003	49267	wipe	Komsuto inside right wall bucket	ND
				Komsuto inside right bucket	ND

5/24/2000	KOM005	49269	wipe	Komsuto teeth bucket	ND
5/24/2000	KOM006	49270	wipe	Komsuto outside right bucket	ND
5/24/2000	KOM007	49271	wipe	Komsuto outside mid back bucket	ND
5/24/2000	KOM008	49272	wipe	Komsuto outside left bucket	ND
5/24/2000	KOM009	49273	wipe	Komsuto joint of bucket	ND
5/24/2000	KOM010	49274	wipe	Komsuto outside joint	ND
5/24/2000	KOM011	49275	wipe	Komsuto left outside track	ND
5/24/2000	KOM012	49276	wipe	Komsuto left outside track	ND
5/24/2000	KOM013	49277	wipe	Komsuto left outside track	ND
5/24/2000	KOM014	49278	wipe	Komsuto left outside track	ND
5/24/2000	KOM015	49279	wipe	Komsuto left outside track	ND
5/24/2000	BD031	49280	wipe	Bull Dozer-left middle track	ND
5/24/2000	BD032	49281	wipe	Bull Dozer-left middle track	ND
5/24/2000	BD033	49282	wipe	Bull Dozer-left middle track	ND
5/24/2000	BD034	49283	wipe	Bull Dozer-left middle track	ND
5/24/2000	BD035	49284	wipe	Bull Dozer- left back skin	ND
5/24/2000	BD036	49285	wipe	Bull Dozer- right back skin	ND
5/24/2000	BD016	49286	wipe	Bull Dozer- right inside Track	ND
5/24/2000	BD017	49287	wipe	Bull Dozer- right inside Track	ND
5/24/2000	BD018	49288	wipe	Bull Dozer- right inside Track	ND
5/24/2000	BD019	49289	wipe	Bull Dozer-right middle track	ND
5/24/2000	BD020	49290	wipe	Bull Dozer-right middle track	ND
5/24/2000	BD021	49291	wipe	Bull Dozer-right middle track	ND
5/24/2000	BD022	49292	wipe	Bull Dozer-right middle track	ND
5/24/2000	BD023	49293	wipe	Bull Dozer-left outside track	ND
5/24/2000	BD024	49294	wipe	Bull Dozer-left outside track	ND
5/24/2000	BD025	49295	wipe	Bull Dozer-left outside track	ND
5/24/2000	BD026	49296	wipe	Bull Dozer-left outside track	ND
5/24/2000	BD027	49297	wipe	Bull Dozer-left outside track	ND
5/24/2000	BD028	49298	wipe	Bull Dozer-left inside track	ND
5/24/2000	BD029	49299	wipe	Bull Dozer-left inside track	ND
5/24/2000	BD030	49300	wipe	Bull Dozer-left inside track	ND



FILE COPY

Fax

**BorgWarner Inc.  
11955 East Nine Mile Road  
Warren, Michigan 48089**

FAX TRANSMITTAL INFORMATION	
<b>From: Anastasia Hamel</b>	<b>To: Gretchen Zmitrovich</b>
<b>Of: BorgWarner Inc.</b>	<b>Of: MDEQ</b>
<b>Phone: (810) 497-4503</b>	<b>Fax: 601-961-5300</b>
<b>Fax: (810) 497-4441</b>	<b>RE: USEPA Letter</b>
<p>Please deliver the attached to Gretchen Zmitrovitch.</p> <p>Thank you.</p>	
<p>This facsimile contains information which (a) may be legally privileged, proprietary in nature or otherwise protected by law from disclosure, and (b) is intended only for the use of the addressee(s) named above. If you are not the addressee or the person responsible for delivering this to the addressee(s), you are hereby notified that any disclosure, copying, distributing or use of this facsimile is prohibited and may constitute an invasion of the privacy of the addressee(s). If you have received this facsimile in error, please telephone us (collect) immediately so that we can arrange for the retrieval of the facsimile at no cost to you.</p>	
<b>Date: November 17, 2000</b>	<b>Number of page(s) in this fax including cover <u>5</u></b>

Original will be sent via: Mail <input checked="" type="checkbox"/> Overnight Courier <input type="checkbox"/> Will Not Be Sent <input type="checkbox"/>		
--	--	--

Chairman

# FIRST ENVIRONMENT

119 Marketridge Drive  
Suite D, Box 6  
Ridgeland, Mississippi 39157  
(601) 957-8987 • FAX (601) 956-2441

June 13, 2000

Al Thomas  
Kuhlman Electric  
101 Kuhlman Drive  
Crystal Springs, MS 39059

Dear Al,

Please find below a brief description of the work performed by First Environment, Inc. and its subcontractors in association with the discovery of polychlorinated biphenyls (PCBs) at the Kuhlman Electric plant in Crystal Springs, Mississippi. This report only deals with the decontamination of equipment and the removal of soil from off-site areas. A final report will be issued at the completion of all cleanup activities.

## DECONTAMINATION OF EQUIPMENT

On May 3, 2000, Kuhlman Electric hired First Environment, Inc. to decontaminate earth-moving equipment contaminated during the expansion project. Through the entire month of May, additional items were discovered that needed decontaminating, a detailed list of all items decontaminated by First Environment can be found in Table 1.

Decontamination of the equipment followed the double wash/rinse procedures set forth in 40 C.F.R. 761 Subpart S. First, remove and capture the dry solids by mechanical force (i.e. the use of hammers and scrappers). Second, cover the entire surface with an industrial strength detergent and wash with a steam power washer. Third, capture the rinse water for further treatment. Fourth, repeat. Fifth, verify by confirmation sampling. Finally, remove the equipment from the plant site.

Initial decontamination of equipment began on May 11, 2000 and was completed on May 26, 2000. First Environment, Inc. decontaminated some 17 vehicles. In addition, some other items were cleaned for precautionary reasons, and these items were not included in the report. All confirmation samples taken for each of the 17 pieces of equipment came back as non-detectable. Therefore, no further action is required for the decontamination work.

ORIGINAL DOCUMENT  
IN THIS CONDITION

### OFF-SITE PROPERTY

During the equipment decontamination, First Environment learned that employees had removed soil and gravel from the plant location. Our investigation uncovered five off-site areas where potentially contaminated material had been removed from the plant location. They are listed below:

1. AKT gravel pit two soil piles on side of road.
2. Allean Meyers Property
3. J. C. Lomax Property
4. Caley Claiborne Property
5. Dwight Holiday Property

### AKT GRAVEL PIT TWO SOIL PILES

On May 9, 2000, First Environment, Inc. discovered two piles of soil located along the road within the confines of the AKT gravel pit. Upon further investigation it was learned that the two soil piles came from the Kuhlman plant site. The piles were covered with plastic. On May 16, the two piles were removed from the AKT gravel pit by excavating an area approximately 2 feet outside the pile and 1 foot below the surface. The removed soil was placed into two dumpsters and returned to the Kuhlman site. No further action is required at this location.

### ALLEAN MEYERS PROPERTY

On May 10, 2000 First Environment, Inc. discovered that potentially contaminated soil had been used to fill in a hole at Mrs. Meyers property. The amount of soil removed to the Meyer property was estimated to be about a 5-gallon bucket of soil. Initial site visit found fresh dirt in a hole approximately 1.5 feet by 1.5 feet and approximately 6 inches deep. The hole was covered with plastic.

On May 16, the soil was removed by digging 1 foot outside the hole and 1 foot below the hole. The removed soil was returned in a dumpster to the Kuhlman site and the hole was filled with clean soil. No further action is required at this location.

### J. C. LOMAX PROPERTY

On May 10, 2000, First Environment, Inc. discovered that Mr. Lomax removed from the Kuhlman site approximately 5 to 10 yards of soils. Mr. Lomax placed the soil in a pile in his pasture. First Environment covered the soil pile with plastic.

On May 16, the soil was removed by digging an area 2 feet around and 1 foot below the pile. The removed soil was returned in dumpsters to the Kuhlman site. Samples taken after the removal, confirmed that no PCB containing material

remained in the hole and the hole was backfilled with clean soil. No further action is required at this location.

#### CALEY CALIBORNE PROPERTY

On May 10, 2000, First Environment, Inc. discovered that Mr. Calborne had used soil and gravel removed from the Kuhlman site to fill in holes in his driveway. A composite sample of soil in the driveway confirmed the presence of PCBs.

On May 16, Kuhlman notified the MDEQ, the EPA and Region 4 TSCA group of the discovery of the off-site area. Jerry Banks with the MDEQ approved the plan to remove the soil from the driveway.

On May 17, First Environment removed the PCB containing soil from the driveway. The soil was placed in dumpsters and returned to the Kuhlman site. Samples taken after the removal, confirmed that all the PCB containing soil had been removed from the driveway.

On May 18, the driveway was backfilled with clean soil and prepared for asphalt. No further action is required at this location.

#### DWIGHT HOILDAY PROPERTY AND RESIDENCE

On May 10, 2000, First Environment, Inc. discovered that Mr. Holiday had removed soil from the Kuhlman site and placed the soil in his back yard. During the initial visit to Mr. Holiday's home, he became concerned that the PCBs soil had been brought into his house. First Environment took samples from inside the house on the floors. The test result showed no traces of PCB material within the residence. However, samples from the soil did indicate the presence of PCB in the back yard.

On May 17, the soil was removed by excavating approximately 2 feet outside the area and 1 foot below the area. The soil was placed into dumpsters and returned to the Kuhlman site. Confirmation samples taken after the removal confirmed that all PCB containing material were removed from the backyard area.

On May 18, First Environment learned of possible contamination in the front yard at the Holiday property. However, samples from the front yard were no detect or below the cleanup requirements. Therefore, no further action is required at this location.

ORIGINAL DOCUMENT  
IN THIS CONDITION



To date, First Environment, has cleanup some 17 vehicles and 5 off-site areas. All confirmation samples have been below detection limits. Therefore, no further action remains.

If you have any questions, please do not hesitate to contact me at 957-8967.

Sincerely,

FIRST ENVIRONMENT, INC.



Michael Caples, Esq.  
Regional Office Manager

ORIGINAL DOCUMENT  
IN THIS CONDITION

**TABLE 1**  
**Equipment Decon List**  
**Kuhlman Electric Project**

Equipment	Results of Confirmation Samples
Mack Truck owned by Mohammed Talle	ND
Mack Truck owned by Perry Wilson	ND
Ford Truck owned by Willie Wilcher	ND
Mack Truck #16 owned by Vaughan Construction	ND
Mack Truck #5 owned by Vaughan Construction	ND
Ford Pickup owned by Caley Claiborne	ND
Chevy Truck owned by Dwight Holiday	ND
Ford Truck owned by J.C. Lomax	ND
Kubota Backhoe BT 900 owned by HY-Teck Sprinkler	ND
Ford Trencher C-3663-6 owned by Ritter Electric	ND
John Deere 310D backhoe owned by Ritter Electric	ND
Air Compressor ACXAS90JD owned by Ritter Electric	ND
John Deere 310D backhoe owned by Fountain Construction	ND
White Dump Truck owned by Ritter Electric	ND
Komatsu Track Hoe owned by Vaughan Construction	ND
Bulldozer owned by Vaughan Construction	ND
Bulldozer owned by AKT gravel	ND

**ORIGINAL DOCUMENT  
 IN THIS CONDITION**