



STATE OF MISSISSIPPI
HALEY BARBOUR
GOVERNOR
MISSISSIPPI DEPARTMENT OF ENVIRONMENTAL QUALITY
CHARLES H. CHISOLM, EXECUTIVE DIRECTOR

MEMORANDUM

Date: August 25, 2004
From: Louis Lavallee *lld*
Through: Chris Sanders *CS*
To: file
Subject: W. C. Fore Exempt "Sustainable" Pit, S 34, T6S, R12W, Harrison County

I visited subject site on Tuesday, August 24, 2004, about 12:00 p. m. The weather was hot and sunny. The gate off County Farm Road was locked and I walked into the site along the woods road shown on the attached Quad map. There was no vehicle entrance to the site off Robinson Road (see attached map). There had been no mining activity, though there were a few spots where it appeared a hole had been dug with a backhoe to investigate subsoil conditions. The proposed mine site was quite flat and the soil appeared sandy and well drained. It is possible that there would be no storm water discharges from the mine as indicated by the applicant.

See attached pictures.

W. C. Fore, Exempt "Sustainable" Pit, S34, T6S, R12W, Harrison County, 8/24/04; L: locked gate off County Farm Road; R: one of test pits dug on property.



View of proposed pit area at west boundary on woods road, looking east. Area is quite flat, and recently lumbered. No mining had begun.





WE NEED TO SCHEDULE AN INSPECTION. SHOULD COORDINATE WITH GEOLOGY. 9/28/04

Spoke w/ Mr. Th. ...
will be glad to ...
inspect. Since it is ...
attempt, they have ...
pre-arranged ...

STATE OF MISSISSIPPI
HALEY BARBOUR
GOVERNOR
MISSISSIPPI DEPARTMENT OF ENVIRONMENTAL QUALITY
CHARLES H. CHISOLM, EXECUTIVE DIRECTOR

August 13, 2004

Mr. W. C. Fore
W. C. Fore Trucking, Inc.
PO Box 3058
Gulfport, Mississippi 39505

Dear Mr. Fore:

Re: W. C. Fore Trucking, Inc.
Sustainable Pit, Harrison County
No Discharge Certification 06 24-117 Exempt

The information you have provided for the referenced facility indicates that there will be no storm water runoff to state waters. Only facilities with storm water discharges are required to have an NPDES permit. Therefore, storm water permitting is not needed for the above referenced facility as long as there is no discharge. If conditions change at this facility, permitting will be required.

We appreciate your attention to the storm water regulations. Please contact me at 601-961-5526 if you have any questions or if I may be of further assistance on this or any matter.

Sincerely,

Ross D. Williams, RPG
Solid Waste and Mining Branch, EPD

cc: Mr. Ken McCarley, RPG, MDEQ-Office of Geology
Mr. Chris Sanders, PE, MDEQ-OPC-ECED

MISSISSIPPI DEPARTMENT OF ENVIRONMENTAL QUALITY
 OFFICE OF GEOLOGY
 Mining and Reclamation Division
 P. O. Box 20307
 Jackson, Mississippi 39289-1307
 (601) 961-5515

*Harrison County # 117
 24-117*

NOTICE OF EXEMPT OPERATION

This form shall be filed with the Office of Geology, Mining and Reclamation Division. If more than 4 acres will be affected or site will be less than 1320 feet from another exempt or permitted operation, a Mining Permit Application form (MRD-3) must be filed. NOTE: Federal or other State agencies may also require permits before mining can be done on your site. This is your responsibility.

Name of applicant/operator: W. C. FORE TRUCKING, INC
 Mailing address: P.O. Box 3058
GULFPORT, MS 39505
 Telephone number: 228-863-1314

LOCATION SUSTAINABLE #

NE 1/4 of SW 1/4 Section 34 Township 6S Range 12W County HARRISON

Include a map or aerial photograph marked with site location upon submittal of this form.

Name of land owner: W. C. FORE TRUCKING INC
 Mailing address: P.O. Box 3058
GULFPORT MS 39505
 Telephone number: 228-863-1314

Date operation to begin 8-11-04 Date operation to end 4-1-05
 Material to be mined SAND Number of acres to be mined 4
 Number of acres to be affected by the entire operation (mine, roads, storage, etc.) _____
 Is operation closer than 1,320 feet to another mine? No X Yes _____

Applicant/
 Operator: W.C. Fore By W.C. Fore
 Signature

Date August 10 - 2004 Position PRESIDENT

For Office of Geology use only

Date 8-10-2004 By Stan Thieling
 ASST. Division Director
 Mining and Reclamation Division

UNITED STATES
DEPARTMENT OF COMMERCE
COAST AND GEODETIC SURVEY

13 2002

289

3145 II
(MC HENRY 1:62 500)

291

10' 12 W 10 MISS 53

293

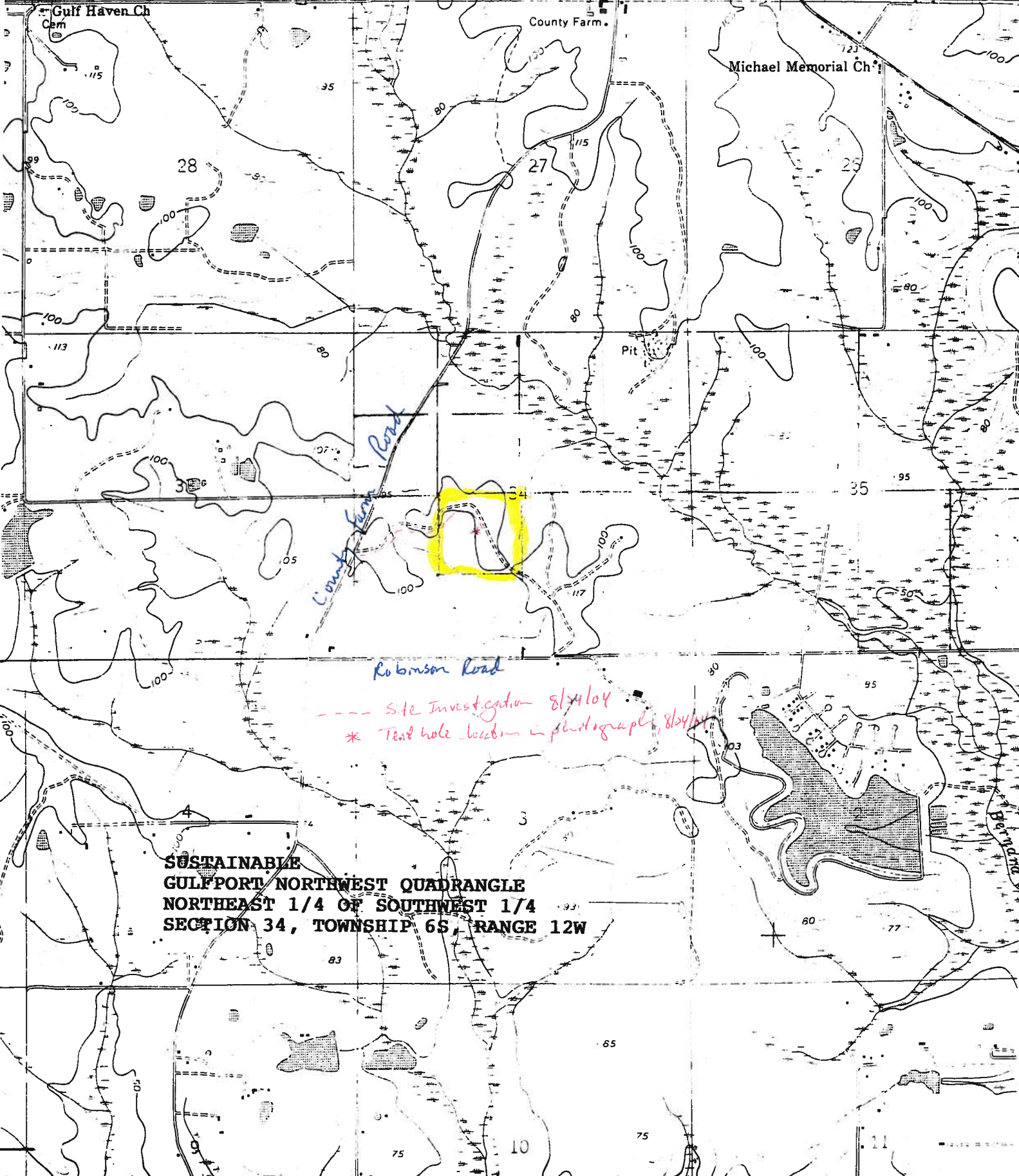

**SUSTAINABLE
GULFPORT NORTHWEST QUADRANGLE
NORTHEAST 1/4 OF SOUTHWEST 1/4
SECTION 34, TOWNSHIP 6S, RANGE 12W**



STATE OF MISSISSIPPI
HALEY BARBOUR
GOVERNOR
MISSISSIPPI DEPARTMENT OF ENVIRONMENTAL QUALITY
CHARLES H. CHISOLM, EXECUTIVE DIRECTOR

August 13, 2004

Mr. W. C. Fore
W. C. Fore Trucking, Inc.
PO Box 3058
Gulfport, Mississippi 39505

Dear Mr. Fore:

Re: W. C. Fore Trucking, Inc.
Sustainable Pit, Harrison County
No Discharge Certification

The information you have provided for the referenced facility indicates that there will be no storm water runoff to state waters. Only facilities with storm water discharges are required to have an NPDES permit. Therefore, storm water permitting is not needed for the above referenced facility as long as there is no discharge. If conditions change at this facility, permitting will be required.

We appreciate your attention to the storm water regulations. Please contact me at 601-961-5526 if you have any questions or if I may be of further assistance on this or any matter.

Sincerely,

A handwritten signature in black ink, appearing to read "Ross D. Williams".

Ross D. Williams, RPG
Solid Waste and Mining Branch, EPD

cc: Mr. Ken McCarley, RPG, MDEQ-Office of Geology
Mr. Chris Sanders, PE, MDEQ-OPC-ECED

AI # 19370
GMP 2 0040001



STATE OF MISSISSIPPI
DAVID RONALD MUSGROVE, GOVERNOR
MISSISSIPPI DEPARTMENT OF ENVIRONMENTAL QUALITY
CHARLES H. CHISOLM, EXECUTIVE DIRECTOR

**MINING NOTICE OF INTENT (MNOI)
FOR COVERAGE UNDER MINING STORM WATER
GENERAL NPDES PERMIT MSR32 1394
(Number to be assigned by State)**

File at least 30 days prior to the commencement of mining; 15 days if a Storm Water Pollution Prevention Plan (SWPPP) is already on file. Lateral expansion of an existing mine that has storm water permit coverage does not require submittal of a new MNOI; however, modification of the existing SWPPP to include the expansion is required. Also, according to 40 CFR 122.26 (b) (14) (iii), mining operations that do not discharge storm water contaminated by contact with any overburden, raw material, intermediate products, finished products, byproducts or waste products shall not be required to file a MNOI.

IS APPLICANT THE OPERATOR OR OWNER? (Circle one or both)

OPERATOR CONTACT PERSON: W.C. FORE
OPERATOR COMPANY NAME: W.C. FORE TRUCKING, INC.
OPERATOR STREET (P. O. BOX): P.O. BOX 3058
OPERATOR CITY: GUERTPORT STATE: _____ ZIP: 39505
OPERATOR TELEPHONE NUMBER (INCLUDE AREA CODE): (228) 863-1314

(List owner if different than operator)

OWNER CONTACT PERSON: BOB GAVIN / W.C. FORE
OWNER COMPANY: W.C. FORE TRUCKING, INC.
OWNER STREET (P. O. BOX): _____
OWNER CITY: _____ STATE: _____ ZIP: _____
OWNER TELEPHONE NUMBER (INCLUDE AREA CODE): _____

(Mine information)

NAME OF MINE: SUSTAINABLE
STREET ADDRESS OR NEAREST NAMED ROAD: COUNTY FARM ROAD
MINE LOCATION: CITY: N/A GUERTPORT COUNTY: HARRISON
39505

OFFICE OF POLLUTION CONTROL
POST OFFICE BOX 10365 - JACKSON, MISSISSIPPI 39289-0365 - TEL: (601) 961-5171 - FAX: (601) 354-6612 - www.deq.state.ms.us
AN EQUAL OPPORTUNITY EMPLOYER

(Mine information continued)

NE 1/4 OF SW 1/4 OF SECTION 34, TOWNSHIP 6 S, RANGE 12 W

ATTACH A USGS QUAD MAP OUTLINING MINE LOCATION (Maps can be obtained from the Mississippi Office of Geology. For information call 601-961-5523).

RECEIVING STREAM: NONE

STANDARD INDUSTRIAL CLASSIFICATION (SIC) CODE: 1412

MATERIAL TO BE MINED: SANDY CLAY

TOTAL ACREAGE (If modification, give original acreage, expanded acreage and total acreage): 4

DOES THIS MINE NEED A CORPS OF ENGINEERS WETLANDS (Sec. 404) PERMIT? NO

WILL HYDRAULIC DREDGING BE USED? (Y/N) NO WASHING OF SAND/GRAVEL? (Y/N) NO

LIST ANY: NPDES PERMIT NO. NONE STATE OPERATING PERMIT NO. NONE

GEOLOGY PERMIT APPLICATION NO. # 117 GEOLOGY PERMIT NO. 24-117

HAS A "NOTICE OF EXEMPT OPERATIONS" BEEN FILED WITH GEOLOGY? (Y/N) Y

A Geology "Notice of Exempt Operations" or "Notice of Intent to Mine Class I or Class II Materials" must be filed before coverage will be granted under the mining storm water NPDES permit. For information on Office of Geology requirements call 601-961-5515.

ESTIMATED START DATE: 8-11-04 END DATE: 4-01-05

ATTACH A STORM WATER POLLUTION PREVENTION PLAN (SEE PERMIT FOR REQUIREMENTS)

IDENTIFY THE ASSOCIATION OR GENERIC SWPPP PREVIOUSLY SUBMITTED:

NONE

I certify under penalty of law that this document and all attachments were prepared under my direction or supervision in accordance with a system designed to assure that qualified personnel properly gathered and evaluated the information submitted. Based on my inquiry of the person or persons who manage the system, or those persons directly responsible for gathering the information, the information submitted is, to the best of my knowledge and belief, true, accurate and complete. I am aware that there are significant penalties for submitting false information, including the possibility of fine and imprisonment for knowing violations.

Signature: W.C. Fore

Date Signed: 8-10-04

Printed Name: W.C. Fore

Title: [Signature]

This application shall be signed according to the General Permit, Part V.E., as follows:

- For a corporation, by a responsible corporate officer.
- For a partnership, by a general partner.
- For a sole proprietorship, by the proprietor.
- For a municipal, state or other public facility, by either a principal executive officer, the mayor, or ranking elected official.
- Daily Authorized Representative

02/20/03

W. C. FORE TRUCKING, INC.

P. O. Box 3058 • Gulfport, MS 39505 • (228) 883-1314 • fax (228) 884-0013

Via Facsimile
(601) 354-6612

August 10, 2004

Mississippi Department of Environmental Quality
Office of Pollution Control
Post Office Box 10385
Jackson, Mississippi 39289-6612

Attention: Mr. Michael Rousel

Reference: **Surface Mining Permit
Notice of Exempt Operation
Sustainable Pit
Section 34, Township 6 South,
Range 12 West
Harrison County, Mississippi**

Dear Mr. Rousel,

Attached for your review and approval is our Mining Notice of Intent for the above captioned mining application, four acres.

The surface mine shall be stripped of overburden and the topsoil segregated for use in plating the slopes of the pit for vegetation. The balance of the spoil material shall be used to construct earthen berms around the perimeter of the pit. The berms will be constructed so as to preclude storm water from entering the pit.

Construction and excavation of the pit will be in such a configuration with grade changes that only the incidental storm water and ground water will flow to a temporary sump at the lowest elevation in the pit. No storm water or ground water shall leave the surface mining pit. All storm water shall be contained within the pit.

If you have any questions at all, please do not hesitate to call our office.

Sincerely,



R. F. Gavin

encl: As-Noted

W. C. FORE TRUCKING, INC.

P. O. Box 3058 • Gulfport, MS 39505 • (228) 863-1314 • fax (228) 864-0013

Via Facsimile
(601) 354-6612

August 10, 2004

Mississippi Department of Environmental Quality
Office of Pollution Control
Post Office Box 10385
Jackson, Mississippi 39289-6612

Attention: Mr. Michael Rousel

Reference: **Surface Mining Permit
Notice of Exempt Operation
Sustainable Pit
Section 34, Township 6 South,
Range 12 West
Harrison County, Mississippi**

Dear Mr. Rousel,

Attached for your review and approval is our Mining Notice of Intent for the above captioned mining application, four acres.

The surface mine shall be stripped of overburden and the topsoil segregated for use in plating the slopes of the pit for vegetation. The balance of the spoil material shall be used to construct earthen berms around the perimeter of the pit. The berms will be constructed so as to preclude storm water from entering the pit.

Construction and excavation of the pit will be in such a configuration with grade changes that only the incidental storm water and ground water will flow to a temporary sump at the lowest elevation in the pit. No storm water or ground water shall leave the surface mining pit. All storm water shall be contained within the pit.

If you have any questions at all, please do not hesitate to call our office.

Sincerely,



R. F. Gavin

encl: As-Noted



STATE OF MISSISSIPPI
DAVID RONALD MUSCROVE, GOVERNOR
MISSISSIPPI DEPARTMENT OF ENVIRONMENTAL QUALITY
CHARLES H. CHISOLM, EXECUTIVE DIRECTOR

**MINING NOTICE OF INTENT (MNOI)
FOR COVERAGE UNDER MINING STORM WATER
GENERAL NPDES PERMIT MSR32 _____
(Number to be assigned by State)**

File at least 30 days prior to the commencement of mining; 15 days if a Storm Water Pollution Prevention Plan (SWPPP) is already on file. Lateral expansion of an existing mine that has storm water permit coverage does not require submittal of a new MNOI; however, modification of the existing SWPPP to include the expansion is required. Also, according to 40 CFR 122.26 (b) (14) (iii), mining operations that do not discharge storm water contaminated by contact with any overburden, raw material, intermediate products, finished products, byproducts or waste products shall not be required to file a MNOI.

IS APPLICANT THE OPERATOR OR OWNER? (Circle one or both)

OPERATOR CONTACT PERSON: W.C. FORE

OPERATOR COMPANY NAME: W.C. FORE TRUCKING, INC.

OPERATOR STREET (P. O. BOX): P.O. BOX 3058

OPERATOR CITY: _____ STATE: _____ ZIP: 39505

OPERATOR TELEPHONE NUMBER (INCLUDE AREA CODE): (228)

(List owner if different than operator)

OWNER CONTACT PERSON: BOB GAVIN / W.C. FORE

OWNER COMPANY: W.C. FORE TRUCKING, INC

OWNER STREET (P. O. BOX): _____

OWNER CITY: _____ STATE: _____ ZIP: _____

OWNER TELEPHONE NUMBER (INCLUDE AREA CODE): _____

(Mine information)

NAME OF MINE: SUSTAINABLE

STREET ADDRESS OR NEAREST NAMED ROAD: COUNTY FARM ROAD

MINE LOCATION: CITY: N/A COUNTY: HARRISON

OFFICE OF POLLUTION CONTROL
POST OFFICE BOX 10385 • JACKSON, MISSISSIPPI 39289-0385 • TEL: (601) 961-5171 • FAX: (601) 354-6612 • www.dsq.state.ms.us
AN EQUAL OPPORTUNITY EMPLOYER

UNITED STATES
DEPARTMENT OF COMMERCE
COAST AND GEODETIC SURVEY

289

3145 II
(MC HENRY 1.62 500)

291

10' 12 41 72 MISS 33

293

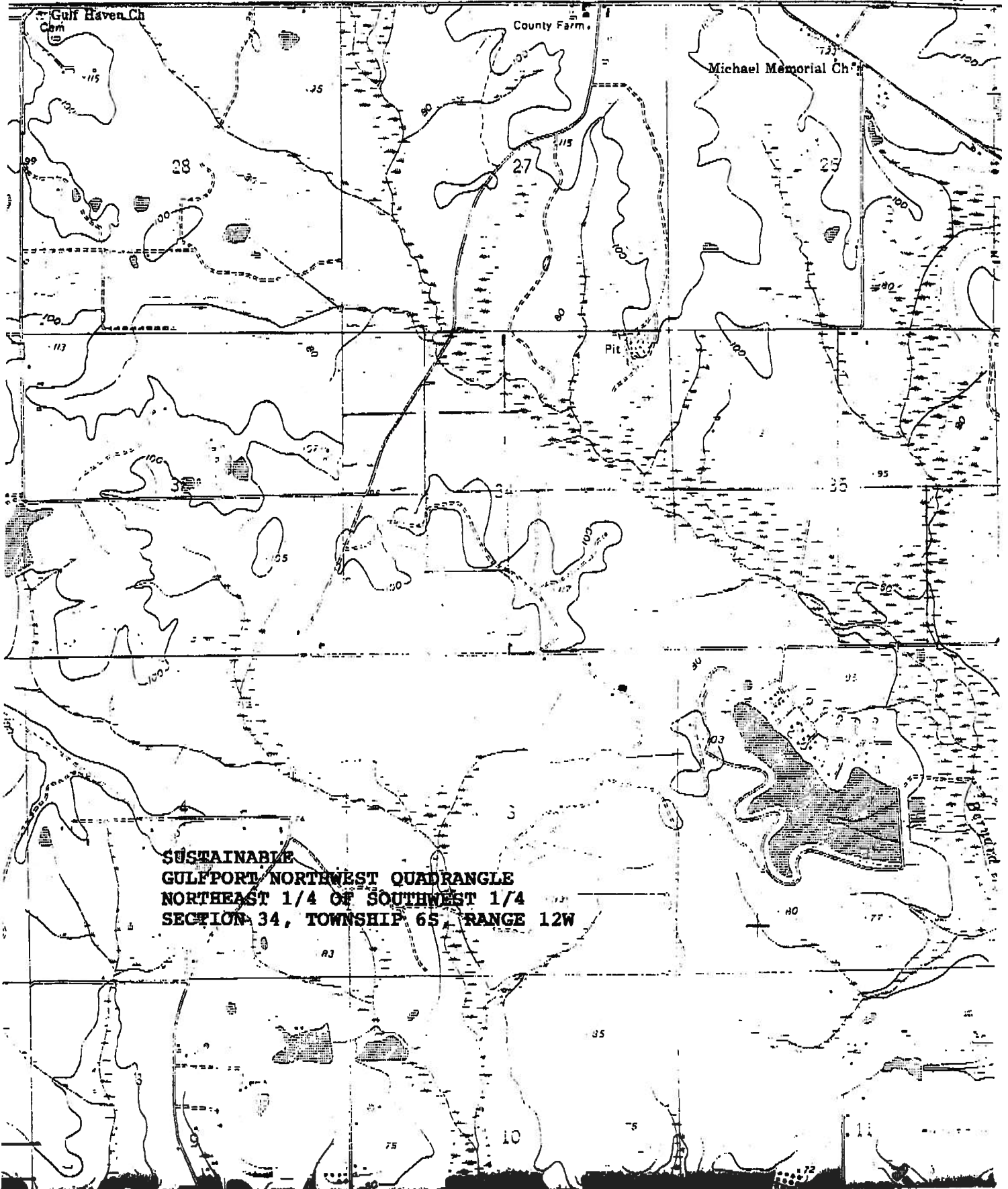

**SUSTAINABLE
GULFPORT NORTHWEST QUADRANGLE
NORTHEAST 1/4 OF SOUTHWEST 1/4
SECTION 34, TOWNSHIP 65, RANGE 12W**



enSearch

Department of Environmental Quality

W C Fore Trucking Inc, Sustainable Pit

AI General Information

AI ID	Branch	SIC	County	Basin	Start	End
19370	Mining and Solid Waste Management	NONE SELECTED	Harrison	NONE SELECTED	08/11/2004	

Physical and Mailing Address

Physical Address (Primary)	Mailing Address
County Farm Road Gulfport, MS 39505	PO Box 3058 Gulfport, MS 39505

Telecommunications

Type	Address or Phone
Work phone number	(228) 863-1314

Alternate / Historic AI Identifiers

Alt ID	Alt Name	Alt Type	Start Date	End Date
19370	W. C. Fore Trucking, Inc., Sustainable Pit	Official Site Name	08/11/2004	

Regulatory Programs

Program	SubProgram

Locational Data

Latitude	Longitude	Method	Datum	Section / Township / Range	Map It
----------	-----------	--------	-------	----------------------------	--------

Staff to AI Assignments

Name	Assignment
Warden, Billy	Permitting, Branch Manager
Williams, Ross	Permitting, Coverage Writer

Related People

Name	Relationship	Start Date	End Date
Fore, W.	Is Application Signatory for	08/11/2004	
Fore, W.	Is General Permit Contact For	08/11/2004	

Related Organizations

Name	Relationship	Start Date	End Date
------	--------------	------------	----------

Individual Permit Applications Current Status

Program	Permit Type	Permit Number	Status Date	Status Desc.
---------	-------------	---------------	-------------	--------------

General Permit Applications Current Status

Program	Permit Type	Permit Number	Status Date	Status Desc.
---------	-------------	---------------	-------------	--------------

Plans & Specs Applications Current Status

Program	Permit Type	Permit Number	Status Date	Status Desc.
---------	-------------	---------------	-------------	--------------

Letterbuilder Documents (Only locked documents shown.)

Gray Bar	Activity Type	Doc Title (click to view document)
----------	---------------	------------------------------------

Completed Tasks

Gray Bar	Activity Type	Task / Comments	Due	Completed	Assigned To
GNP20040001	NA-Mining	NOI Received	08/12/2004	08/11/2004	Cresap, Lucy

Show/Hide NonPrint Sections

Date/Time: 8/12/2004 8:16:29 AM

(Mine information continued)

NE 1/4 OF SW 1/4 OF SECTION 34, TOWNSHIP 6 S, RANGE 12 W

ATTACH A USGS QUAD MAP OUTLINING MINE LOCATION (Maps can be obtained from the Mississippi Office of Geology. For information call 601-961-5523).

RECEIVING STREAM: NONE

STANDARD INDUSTRIAL CLASSIFICATION (SIC) CODE: 1412

MATERIAL TO BE MINED: SANDY CLAY

TOTAL ACREAGE (If modification, give original acreage, expanded acreage and total acreage): 4

DOES THIS MINE NEED A CORPS OF ENGINEERS WETLANDS (Sec. 404) PERMIT? NO

WILL HYDRAULIC DREDGING BE USED? (Y/N) NO WASHING OF SAND/GRAVEL? (Y/N) NO

LIST ANY: NPDES PERMIT NO. NONE STATE OPERATING PERMIT NO. NONE

GEOLOGY PERMIT APPLICATION NO. # 117 GEOLOGY PERMIT NO. 24-117

HAS A "NOTICE OF EXEMPT OPERATIONS" BEEN FILED WITH GEOLOGY? (Y/N) Y

A Geology "Notice of Exempt Operations" or "Notice of Intent to Mine Class I or Class II Materials" must be filed before coverage will be granted under the mining storm water NPDES permit. For information on Office of Geology requirements call 601-961-5515.

ESTIMATED START DATE: 8-11-04 END DATE: 4-01-05

ATTACH A STORM WATER POLLUTION PREVENTION PLAN (SEE PERMIT FOR REQUIREMENTS)

IDENTIFY THE ASSOCIATION OR GENERIC SWPPP PREVIOUSLY SUBMITTED:

NONE

I certify under penalty of law that this document and all attachments were prepared under my direction or supervision in accordance with a system designed to assure that qualified personnel properly gathered and evaluated the information submitted. Based on my inquiry of the person or persons who manage the system, or those persons directly responsible for gathering the information, the information submitted is, to the best of my knowledge and belief, true, accurate and complete. I am aware that there are significant penalties for submitting false information, including the possibility of fine and imprisonment for knowing violations.

Signature: W.C. Fore

Date Signed: 8-10-04

Printed Name: W.C. Fore

Title: [Signature]

This application shall be signed according to the General Permit, Part V.E., as follows:

- For a corporation, by a responsible corporate officer.
- For a partnership, by a general partner.
- For a sole proprietorship, by the proprietor.
- For a municipal, state or other public facility, by either a principal executive officer, the mayor, or ranking elected official.
- Duty Authorized Representative.

02/20/03

MISSISSIPPI DEPARTMENT OF ENVIRONMENTAL QUALITY
 OFFICE OF GEOLOGY
 Mining and Reclamation Division
 P. O. Box 20307
 Jackson, Mississippi 39289-1307
 (601) 961-5515

Harrison County # 117
24-117

NOTICE OF EXEMPT OPERATION

This form shall be filed with the Office of Geology, Mining and Reclamation Division. If more than 4 acres will be affected or site will be less than 1320 feet from another exempt or permitted operation, a Mining Permit Application form (MRD-3) must be filed. NOTE: Federal or other State agencies may also require permits before mining can be done on your site. This is your responsibility.

Name of applicant/operator: W. C. FORE TRUCKING, INC
 Mailing address: P.O. Box 3058
GULFPORT, MS 39505
 Telephone number: 228-863-1314

LOCATION SUSTAINABLE #

NE 1/4 of SW 1/4 Section 34 Township 6 S Range 12 W County HARRISON

Include a map or aerial photograph marked with site location upon submittal of this form.

Name of land owner: W. C. FORE TRUCKING INC
 Mailing address: P.O. Box 3058
GULFPORT MS 39505
 Telephone number: 228-863-1314

Date operation to begin 8-11-04 Date operation to end 4-1-05
 Material to be mined SAND Number of acres to be mined 4
 Number of acres to be affected by the entire operation (mine, roads, storage, etc.) _____
 Is operation closer than 1,320 feet to another mine? No X Yes

Applicant/
 Operator: W.C. FORE By W.C. Fore
Signature

Date August 10 - 2004 Position PRESIDENT

For Office of Geology use only

Date _____ By _____
Division Director
Mining and Reclamation Division



FILE COPY

STATE OF MISSISSIPPI
HALEY BARBOUR
GOVERNOR
MISSISSIPPI DEPARTMENT OF ENVIRONMENTAL QUALITY
CHARLES H. CHISOLM, EXECUTIVE DIRECTOR

August 13, 2004

Mr. W. C. Fore
W. C. Fore Trucking, Inc.
PO Box 3058
Gulfport, Mississippi 39505

Dear Mr. Fore:

Re: W. C. Fore Trucking, Inc.
Sustainable Pit, Harrison County
No Discharge Certification

The information you have provided for the referenced facility indicates that there will be no storm water runoff to state waters. Only facilities with storm water discharges are required to have an NPDES permit. Therefore, storm water permitting is not needed for the above referenced facility as long as there is no discharge. If conditions change at this facility, permitting will be required.

We appreciate your attention to the storm water regulations. Please contact me at 601-961-5526 if you have any questions or if I may be of further assistance on this or any matter.

Sincerely,

A handwritten signature in blue ink, appearing to read "Ross D. Williams".

Ross D. Williams, RPG
Solid Waste and Mining Branch, EPD

cc: Mr. Ken McCarley, RPG, MDEQ-Office of Geology
Mr. Chris Sanders, PE, MDEQ-OPC-ECED