

W C Fore Trucking Inc, Grandfather Pat Mine

General Information

ID	Branch	SIC	County	Basin	Start	End
3888	Mining and Solid Waste Management	1442	Harrison	Coastal Streams	10/09/2000	

Address

Physical Address (Primary)	Mailing Address
Lattimer Road Gulfport, MS 39505	PO Box 3058 Gulfport, MS 39505

Telecommunications

Type	Address or Phone
Work phone number	(228) 863-1314

Alternate / Historic AI Identifiers

Alt ID	Alt Name	Alt Type	Start Date	End Date
MSR320294	W C Fore Trucking Inc	GP-Mining	10/12/2000	
3888	W C Fore Trucking Inc	Official Site Name	10/12/2000	

Regulatory Programs

Program	SubProgram
Water	No subprogram specified

Locational Data

Latitude	Longitude	Method	Datum	S / T / R	Map Links

Report Date: 2/14/2005 2:03:02 PM

W C Fore Trucking Inc, Grandfather Pat Mine

Staff to AI Assignments

Name	Assignment
Sanders, Chris	Compliance, Management
Lavallee, Louis	Compliance, Staff
Lavallee, Louis	Enforcement
Warden, Billy	Permitting, Branch Manager
Rockingham, Charity	Permitting, Coverage Writer
Sharp, Loyd	Regional Office, Management

Related People

Name	Relationship	Start Date	End Date
Fore, W.	Is Application Signatory for	02/07/2005	
Fore, W.	Is Contact For	01/01/1980	
Fore, W.	Is General Permit Contact For	02/07/2005	

Related Organizations

Name	Relationship	Start Date	End Date
------	--------------	------------	----------

Report Date: 2/14/2005 2:03:02 PM

MISSISSIPPI DEPARTMENT OF ENVIRONMENTAL QUALITY
OFFICE OF GEOLOGY - MINING AND RECLAMATION DIVISION

INSPECTION REPORT

W.C. Fore

Operator: Pat Fore Truck Lines, Inc. Copy to Operator: Yes

Application/Permit #: P95-082 Acres: 4 Inspection Type: Annual

Inspected By: Ron Porter Date: 08-11-2010

Location of Operation: SE 1/4 of NW 1/4 Section 21, Township 6 South, Range 13 West, Harrison County, Mississippi

Mining Status: Inactive "Wolf River North Mine" AI# 3888

Within Permit Limits? Yes

MSR 32 0294

Mining Without Permit? No

Mining Within 300 Feet of Occupied Dwelling? No

Mining Within 100 Feet of Right of Way? No

Identification Sign: Absent

Monitor or Location Marker: Absent

Water Control: Adequate

Sediment Pond: Adequate

Sediment Runoff: Not Excessive

Dam(s) to Pond(s) Present: Appear Adequate

RECLAMATION

Progress: Adequate Self reclamation every 1 to 3 years

Plan Filed: Natural Sand bar reclamation

Plan Implemented: same

Debris Disposal: Proper

Slopes: Natural Horizontal to Vertical

Slope Condition: Stable

Vegetative Cover: Very Poor

Comments: The operator must maintain a permit sign and marked boundaries until final bond release.

BR Status: \$2,000 Performance Bond No bond releases to date.

BR Recommendation:



1-



2- Looking downstream



3- Looking upstream

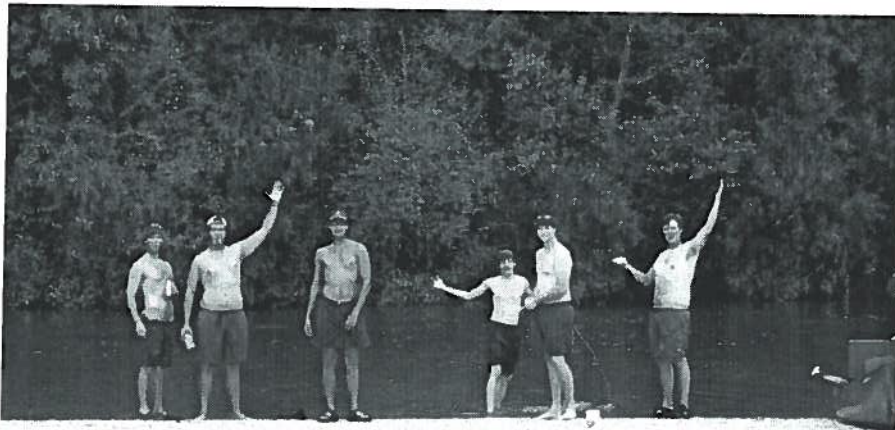

4- People enjoying the river and sand bars.



Storm Water Inspection

October 26, 2010











To: **Ethan Mayeu**
Office of Pollution Control
Compliance & Enforcement Division

From: **Ron Porter**
Office of Geology
Mining & Reclamation Division

Re: Pat Fore Truck Lines, Inc. P95-082 AI# 3888 4 Acres "Wolf River North Mine"
Harrison County

On August 11, 2010, I conducted a storm water inspection on the above referenced site. This site is permitted as a dry sand bar mine operation. No mining has occurred at this time. The sand bar is in its natural state. I did not see evidence of storm water concerns There are no facilities or debris disposal on this site.

**MISSISSIPPI DEPARTMENT OF ENVIRONMENTAL QUALITY
OFFICE OF GEOLOGY - MINING AND RECLAMATION DIVISION
INSPECTION REPORT**

Operator:	<u>W. C. Fore Trucking, Inc.</u>	Copy to Operator:	<u>Yes</u>
Application/Permit #:	<u>P88-027</u>	Acres: <u>38</u>	Inspection Type: <u>Annual</u>
Inspected By:	<u>Ron Porter</u>	Date:	<u>08-11-2010</u>
Location of Operation:	<u>NW 1/4 of SW 1/4 Section 1, Township 7 South, Range 11 West, Harrison County, Mississippi</u>		
Mining Status:	<u>Active</u>	<u>"Grandfather Pat Mine" AI# 3888</u>	
Within Permit Limits?	<u>Yes</u>		
Mining Without Permit?	<u>No</u>		
Mining Within 300 Feet of Occupied Dwelling?	<u>No</u>		
Mining Within 100 Feet of Right of Way?	<u>No</u>		
Identification Sign:	<u>Absent</u>		
Monitor or Location Marker:	<u>Absent</u>		
Water Control:	<u>Adequate</u>		
Sediment Pond:	<u>Adequate</u>		
Sediment Runoff:	<u>Not Excessive</u>		
Dam(s) to Pond(s) Present:	<u>Appear Adequate</u>		

RECLAMATION

Progress:	<u>Adequate</u>
Plan Filed:	<u>3 to 1 grassed slopes</u>
Plan Implemented:	<u>same</u>
Debris Disposal:	<u>Proper</u>
Slopes:	<u>3 Horizontal to 1 Vertical</u>
Slope Condition:	<u>Stable</u>
Vegetative Cover:	<u>Fair</u>

Comments: The operator is required to post & maintain a permit sign and boundary markers for the life of the permit, which is until final bond release. Please see that this is done in a timely manner.

Bond Status: Bond amount = \$25,000 No bond releases to date.



1- Looking north along Latimer Road. Note the location of the trees for reference. Only filling is occurring on this site, no mining.



Storm Water Inspection

October 27, 2010

To: **Ethan Mayeu**
Office of Pollution Control
Compliance & Enforcement Division

From: **Ron Porter**
Office of Geology
Mining & Reclamation Division

Re: W. C. Fore Trucking, Inc. P88-027 AI# 3888 38 Acres "Grandfather Pat Mine"
Harrison County

On August 11, 2010, I conducted a storm water inspection on the above referenced site. This site was mined for sand & clay. This site is inactive with regard to mining. The site appears almost level and has been filled. I did not see evidence of storm water concerns with this permit. There are no facilities or debris being disposed on this site.

**MISSISSIPPI DEPARTMENT OF ENVIRONMENTAL QUALITY
OFFICE OF GEOLOGY - MINING AND RECLAMATION DIVISION**

INSPECTION REPORT

Operator:	<u>W. C. Fore Trucking, Inc.</u>	Copy to Operator:	<u>Yes</u>
Application/Permit #:	<u>P88-027A</u>	Acres: <u>76</u>	Inspection Type: <u>Annual</u>
Inspected By:	<u>Ron Porter</u>	Date:	<u>08-12-2009</u>
Location of Operation:	<u>NW 1/4 of SW 1/4 Section 1, Township 7 South, Range 11 West, Harrison County, Mississippi</u>		
Mining Status:	<u>Active</u>	<u>"Grandfather Pat Mine" AI# 3888</u>	
Within Permit Limits?	<u>Yes</u>		
Mining Without Permit?	<u>No</u>		
Mining Within 300 Feet of Occupied Dwelling?	<u>No</u>		
Mining Within 100 Feet of Right of Way?	<u>No</u>	<u>MSR 320294</u>	
Identification Sign:	<u>Absent</u>	<u>Storm Water</u>	
Monitor or Location Marker:	<u>Absent</u>		
Water Control:	<u>Adequate</u>		
Sediment Pond:	<u>Adequate</u>		
Sediment Runoff:	<u>Not Excessive</u>		
Dam(s) to Pond(s) Present:	<u>Appear Adequate</u>		
RECLAMATION			
Progress:	<u>Adequate</u>		
Plan Filed:	<u>3 to 1 grassed slopes</u>		
Plan Implemented:	<u>same</u>		
Debris Disposal:	<u>Proper</u>		
Slopes:	<u>3 Horizontal to 1 Vertical</u>		
Slope Condition:	<u>Stable</u>		
Vegetative Cover:	<u>Fair</u>		
Comments:	The operator is required to post & maintain a permit sign and boundary markers for the life of the permit, which is until final bond release. Please see that this is done.		
BR Status:	Bond amount = \$25,000 No bond releases to date.		
BR Recommendation:			



1-



2- Port muck being deposited on site.



3- For reference of where I on the entrance/haul road. Looking west to the fence corner.



W.C. Fore Trucking P88-027A
76 acres in Harrison Co.
"Grandfather Pat Mine"
AI# 3888

OVERSIZED??

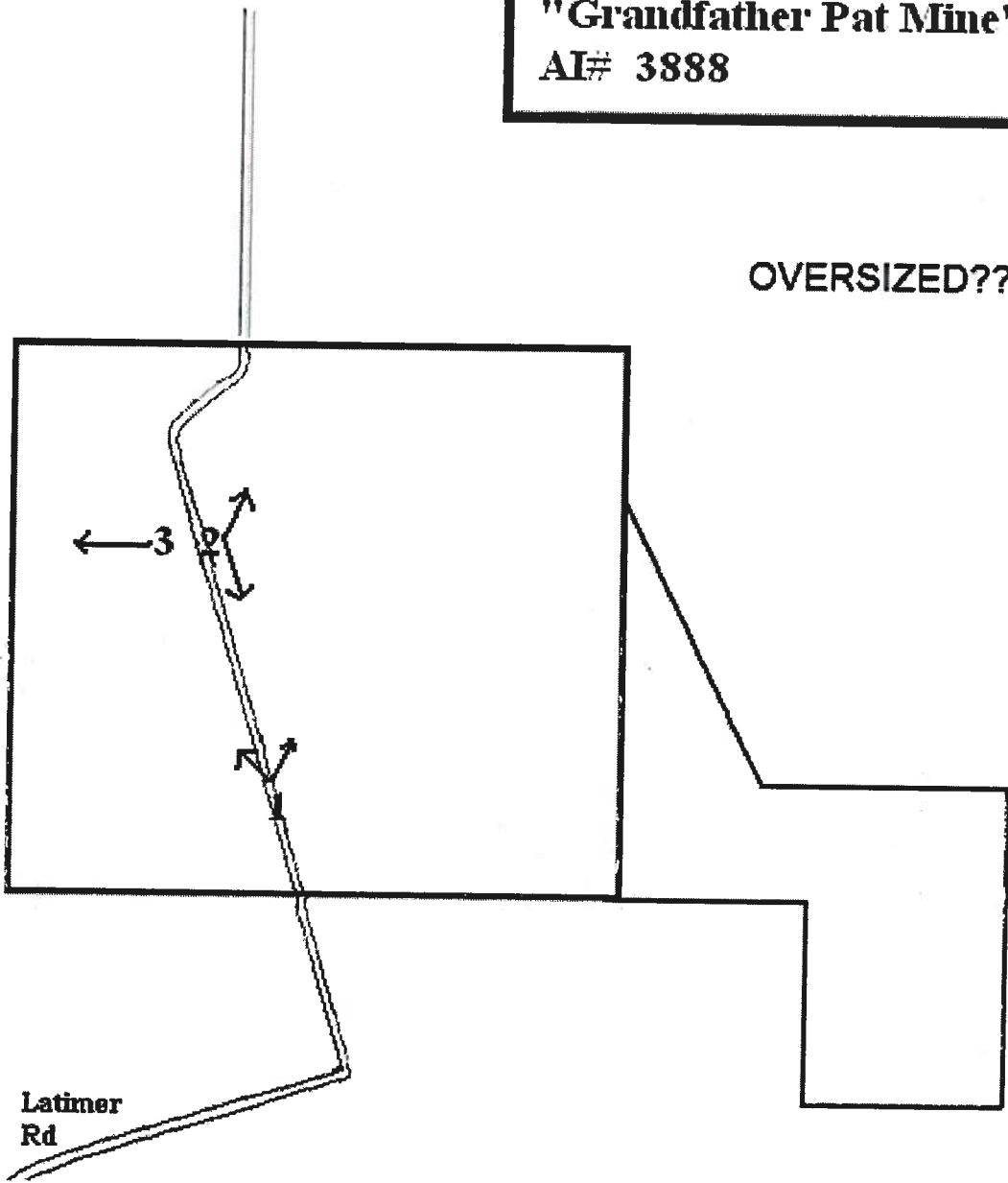

Storm Water Inspection

September 1, 2009

To: **Ethan Mayeu**
Office of Pollution Control
Compliance & Enforcement Division

From: **Ron Porter**
Office of Geology
Mining & Reclamation Division

Re: W. C. Fore Trucking, Inc. P88-027A AI# 3888 76 Acres "Grandfather Pat Mine"
Harrison County

On August 12, 2009, I conducted a storm water inspection on the above referenced site. This site was an open pit mined for sand and clay. This site is inactive with regard as to mining. The site the day of this inspection was being used for disposal of port muck. Apparently the operator got the contract on the port job. The muck appears to be spread out to dry. Storm water would drain across the site, to the east across vegetated areas. There does not appear to be any offsite sediment and erosion concerns with this site. There are no facilities located on the mine site. There is no debris being disposed on site.

**MISSISSIPPI DEPARTMENT OF ENVIRONMENTAL QUALITY
OFFICE OF GEOLOGY - MINING AND RECLAMATION DIVISION
INSPECTION REPORT**

Operator:	<u>Pat Fore Truck Lines, Inc.</u>	Copy to Operator:	<u>Yes</u>
Application/Permit #:	<u>P95-082</u>	Acres: <u>4</u>	Inspection Type: <u>Annual</u>
Inspected By:	<u>Ron Porter</u>	Date:	<u>08-12-2009</u>
Location of Operation:	<u>SE 1/4 of NW 1/4 Section 21, Township 6 South, Range 13 West, Harrison County, Mississippi</u>		
Mining Status:	<u>Inactive</u>	<u>"Wolf River North Mine" AI# 3888</u>	
Within Permit Limits?	<u>Yes</u>		
Mining Without Permit?	<u>No</u>		
Mining Within 300 Feet of Occupied Dwelling?	<u>No</u>		
Mining Within 100 Feet of Right of Way?	<u>No</u>		
Identification Sign:	<u>Absent</u>	<u>MSR 320294</u>	
Monitor or Location Marker:	<u>Absent</u>	<u>storm water</u>	
Water Control:	<u>Adequate</u>		
Sediment Pond:	<u>Adequate</u>		
Sediment Runoff:	<u>Not Excessive</u>		
Dam(s) to Pond(s) Present:	<u>Appear Adequate</u>		

RECLAMATION

Progress:	<u>Adequate</u>	<u>Self reclamation every 1 to 3 years</u>
Plan Filed:	<u>Natural Sand bar reclamation</u>	
Plan Implemented:	<u>same</u>	
Debris Disposal:	<u>Proper</u>	
Slopes:	<u>Natural Horizontal to Vertical</u>	
Slope Condition:	<u>Stable</u>	
Vegetative Cover:	<u>Very Poor</u>	

Comments: The operator must maintain a permit sign and marked boundaries until final bond release.

BR Status: \$2,000 Performance Bond No bond releases to date.

BR Recommendation:



1- Gate: Note Key to gate in envelope in field file. Call Stacey Ladner (cell) 228-363-0276 if cannot get in or to get another key. The lock is changed every 3 years. New lock and key as of 08-2009.



2- North site looking upstream. P95-082



3- North site looking downstream. P95-082

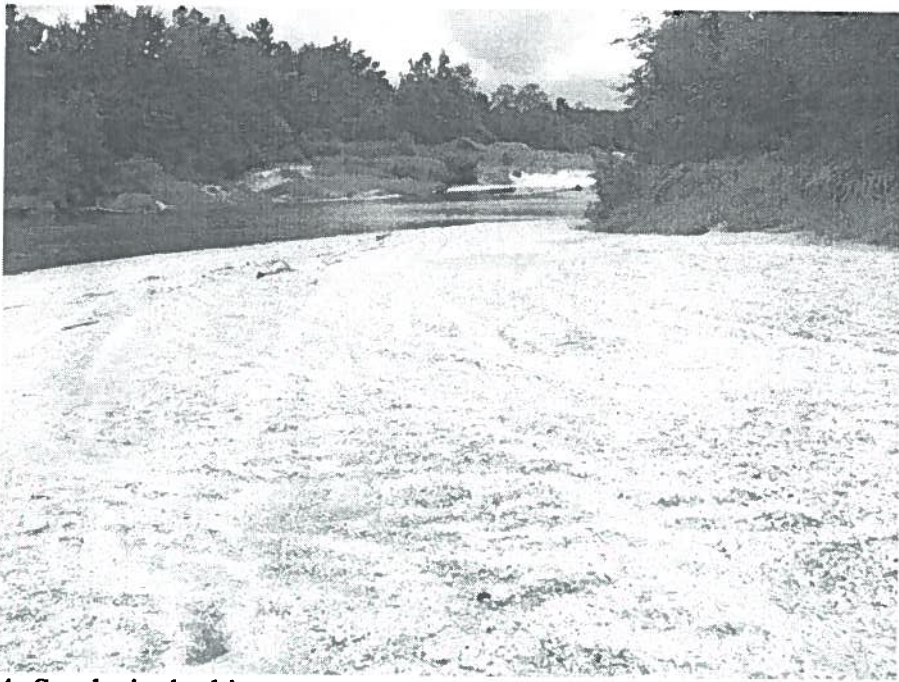

4- South site looking upstream. P95-083



5- South site looking downstream. P95-083

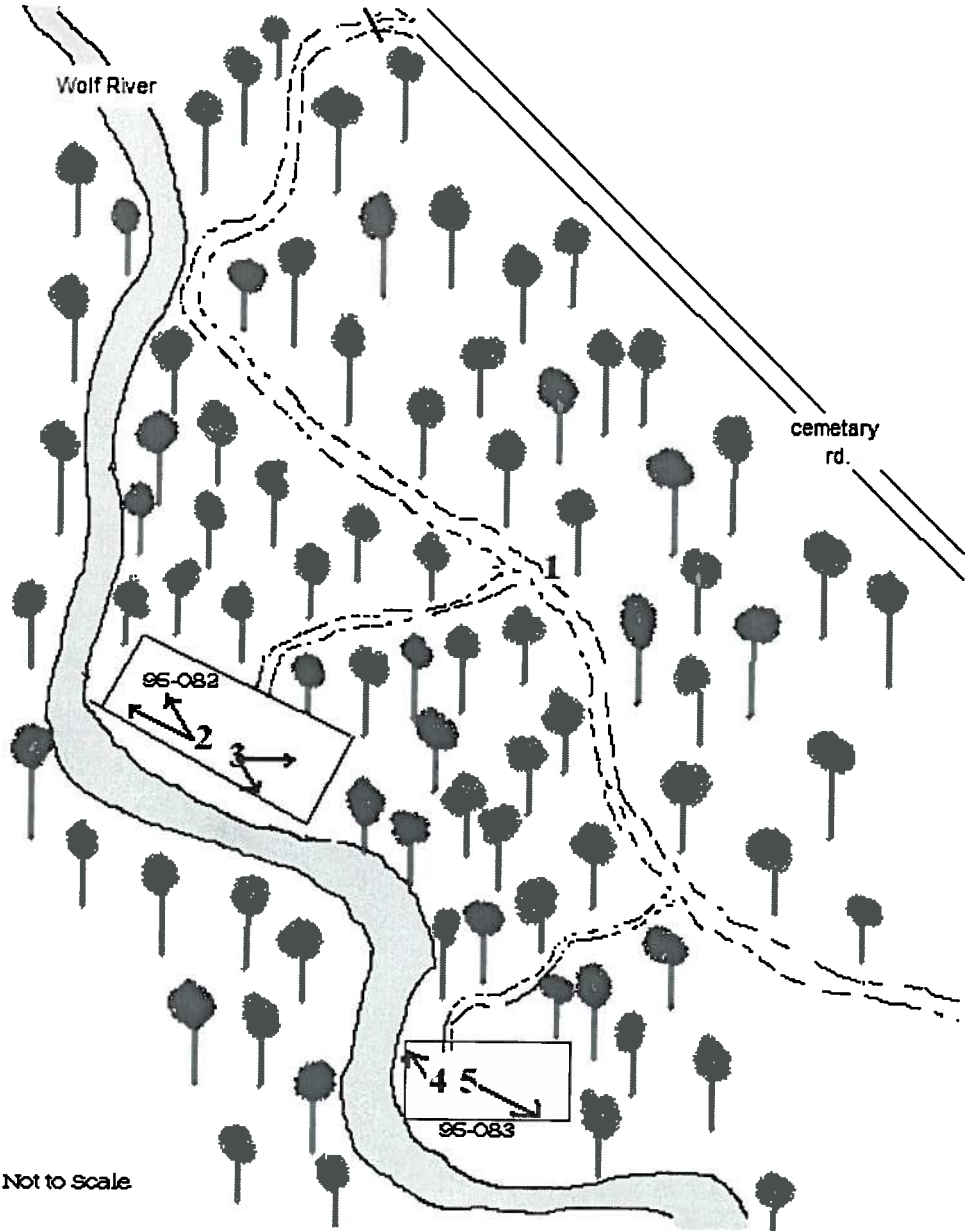

Pat Fore Truck Lines, Inc.
P95-082 & 95-083
Harrison Co.

Not to Scale

Storm Water Inspection

September 2, 2009

To: **Ethan Mayeu**
Office of Pollution Control
Compliance & Enforcement Division

From: **Ron Porter**
Office of Geology
Mining & Reclamation Division

Re: Pat Fore Trucking, Inc. P95-082 AI# 3888 4 Acres "Wolf River North Mine"
P95-083 AI# 5440 4 Acres "Wolf River South Mine"
Harrison County

On August 12, 2009, I conducted a storm water inspection on the above referenced sites. Both of these sites are sand bar mines on the Wolf River. These sites are to be mined in the dry, for sand and gravel. File review finds that neither of the sites have been mined and storm water flows appear to be in their natural state. There does not appear to be any offsite sediment and erosion concerns with these sites. There are no facilities or debris disposal located on the mine sites.

File.

MDEQ COMPLAINT INVESTIGATION REPORT

Complaint ID: 30294

Report Date: 03-Jul-09

Complaint Taken:

02-JUL-09

Investigator: Becky Comyns *BC*

County:

Harrison

Date Investigated: 02-JUL-09

Media:

Air

CONFIRMED COMPLAINT SITE

NAME:

SITE NAME: *W.C. Fore Trucking,*
ADDRESS LINE 1: *Grandfather Pt Mine*

ADDRESS LINE 2

CITY, STATE, ZIP:

TELECOM 1:

TELECOM 2:

AI ID: *3888*

RESPONSIBLE PARTY/CONTACT PERSON

NAME:

SITE NAME:

ADDRESS LINE 1:

ADDRESS LINE 2:

CITY, STATE, ZIP:

TELECOM 1:

TELECOM 2:

GPS DATA

LOCATION DESCRIPTION: No data for this complaint ID

LATITUDE: Null° Null' Null"

LATITUDE DD: Null

LONGITUDE: Null° Null' Null"

LONGITUDE DD: Null

SECTION/TOWNSHIP/RANGE: Null/Null/Null

QUARTER SECTION: Null/Null



MDEQ COMPLAINT INVESTIGATION REPORT

MARK ONE OF THE FOLLOWING:

<input type="checkbox"/>	-PHOTOS ATTACHED	<input checked="" type="checkbox"/>	-RESOLVED BY RO
<input type="checkbox"/>	-MAP ATTACHED	<input type="checkbox"/>	-ROUTE TO ECED FOR RESOLUTION
<input type="checkbox"/>	-OTHER ATTACHMENTS		

INVESTIGATION NOTES:

After receiving this complaint at 4:15pm, I called Mark Bridenbeck (228.518.0812) with the city of Gulfport, but only got his voicemail. I then called W.C. Fore's office in Gulfport (the owner of the disposal pit for the dredge spoils on Latimer Road) and spoke with Leslie MCGrew. She said that she would contact the necessary people immediately to go water the road. She also stated that the city had been letting them use a fire hydrant on Latimer Road to suppress the dust, and that she would see if that could be done again.

MDEQ CTS Online

Complaint ID: 30294

County: Harrison (SRO)

Complaint Date: 07/02/2009

Taken By: Becky Comyns (Field Services/South Regional Office)

Phone Number: 228.432.1056

Origin: Phone

Complaint Description:

Mr. Cockerham stated that trucks hauling dredge spoils from the Gulfport Harbor to the pit on Latimer Road are causing dust again. Refer to past complaints 29034,28937,30185,30187, and 30197.

Complaint Location:

Take Lorraine Road north to Dedeaux Road on the left. Latimer Road is on the right.

Complaint Generic Type:

Other

Complainant Information

Name: Douglas Cockerham

Address Line 1: 819 Latimer Road

Address Line 2:

City, State, Zip: Gulfport, MS

Telecom 1: 228.831.1577

Telecom 2:

Telecom 3:

Email:

Alleged Site Information

Site Name: Dirt pit at end of Latimer Road

Person Name: WC Fore

Entity Type: Owner

Address Line 1: 14270 Creosote Road

Address Line 2:

City, State, Zip: Gulfport, MS

Telecom 1: 228.863.1314

Telecom 2:

Telecom 3:

Email:

File

MDEQ COMPLAINT INVESTIGATION REPORT

Complaint ID: 30187

Report Date: 12-Jun-09

Complaint Taken: 11-JUN-09

Investigator: Becky Comyns *PC*

County: Harrison

Date Investigated: 12-JUN-09

Media: Air, Other / Unknown

CONFIRMED COMPLAINT SITE

NAME:

SITE NAME: *W.C. Fore Trucking
Grandfather Pat mine*

ADDRESS LINE 1:

ADDRESS LINE 2

CITY, STATE, ZIP:

TELECOM 1:

TELECOM 2:

AI ID: 3888

RESPONSIBLE PARTY/CONTACT PERSON

NAME:

SITE NAME:

ADDRESS LINE 1:

ADDRESS LINE 2:

CITY, STATE, ZIP:

TELECOM 1:

TELECOM 2:

GPS DATA

LOCATION DESCRIPTION: No data for this complaint ID

LATITUDE: Null° Null' Null"

LATITUDE DD: Null

LONGITUDE: Null° Null' Null"

LONGITUDE DD: Null

SECTION/TOWNSHIP/RANGE: Null/Null/Null

QUARTER SECTION: Null/Null

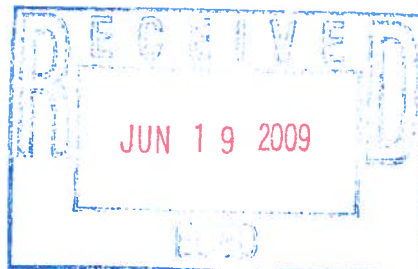

MDEQ COMPLAINT INVESTIGATION REPORT

MARK ONE OF THE FOLLOWING:	<input type="checkbox"/>	-PHOTOS ATTACHED	<input checked="" type="checkbox"/>	-RESOLVED BY RO
	<input type="checkbox"/>	-MAP ATTACHED	<input type="checkbox"/>	-ROUTE TO ECED FOR RESOLUTION
	<input type="checkbox"/>	-OTHER ATTACHMENTS		

INVESTIGATION NOTES:

Refer to Complaint # 29034 for same complaint about dusting from trucks carrying Gulfport Harbor dredge spoils to WC Fore pit on Latimer Road. On 6/12/2009 I called Mark Bridenbeck, environmental officer with the City of Gulfport, at 228.518.0812. He stated that he would talk to Mr. Fore about cleaning the trucks after dumping the material into the pit, since the clumps that fall off onto the road and then dry out are what apparently is causing most of the dust problem. He will also address the accumulated dust already on Latimer Road. I called Ms. Yeager back and relayed my findings - I also gave her Mark Bridenbeck's number in case the dust problem continues.

MDEQ CTS Online

Complaint ID: 30187

County: Harrison (SRO)

Complaint Date: 06/11/2009

Taken By: Becky Comyns (Field Services/South Regional Office)

Phone Number: 228.432.1056

Origin: Phone

Complaint Description:

Ms. Yeager stated the same dusty conditions on Latimer Road as Mr. Allen in Complaint #30185. The dust is coming from trucks hauling Gulfport Harbor dredge spoils into the pit on Latimer Road.

Complaint Location:

From I-10, take Cowan Lorraine exit and go north. Turn left onto Dedeaux Road, and then right onto Latimer.

Complaint Generic Type:

Other

Complainant Information

Name: Linda Yeager

Address Line 1: 6 Leander St.

Address Line 2:

City, State, Zip: Gulfport, MS 39503

Telecom 1: 228.539.2354

Telecom 2:

Telecom 3:

Email:

Alleged Site Information

Site Name: Pit at north end of Latimer Road

Person Name: WC Fore

Entity Type: Owner

Address Line 1: Latimer Road

Address Line 2:

City, State, Zip: Gulfport, MS 39503

Telecom 1: 228.863.1314

Telecom 2:

Telecom 3:

Email:

MDEQ COMPLAINT INVESTIGATION REPORT

Complaint ID: 29034

Report Date: 15-Oct-08

Complaint Taken: 22-SEP-08

Investigator: Nick Gatian

County: Harrison

Date Investigated: 26-SEP-08

Media: Other / Unknown

CONFIRMED COMPLAINT SITE

NAME: Lamont Ladner
SITE NAME: W. C. Fore Trucking
ADDRESS LINE 1:
ADDRESS LINE 2:
CITY, STATE, ZIP: Gulfport, MS
TELECOM 1: 228-863-1314
TELECOM 2: 228-297-1317
AI ID:

RESPONSIBLE PARTY/CONTACT PERSON

NAME:
SITE NAME:
ADDRESS LINE 1:
ADDRESS LINE 2:
CITY, STATE, ZIP:
TELECOM 1:
TELECOM 2:

GPS DATA

LOCATION DESCRIPTION:

LATITUDE: 30° 26' 11.5"
LATITUDE DD: 030.436403
LONGITUDE: -88° 58' 19.3"
LONGITUDE DD: -088.971953
SECTION/TOWNSHIP/RANGE: //
QUARTER SECTION: /

MDEQ COMPLAINT INVESTIGATION REPORT

MARK ONE OF THE FOLLOWING:	X	-PHOTOS ATTACHED		-RESOLVED BY RO
		-MAP ATTACHED		-ROUTE TO ECED FOR RESOLUTION
		-OTHER ATTACHMENTS		

INVESTIGATION NOTES:

Routed to Mark Bridenbeck (228-518-0812), City of Gulfport, 9/22/2008. He is sending a crew to the area to sweep the street. Also contacted Lamont Ladner with W.C. Fore which is the company doing the dredge/hauling work to advise them to better secure their vehicles.

9/26/2008 - Mr. Ladner advised they checked all the trucks and fixed the tail gates on the ones leaking. Have also send street sweeper to clean up.

10/2/2008 - Received another call from Mr. Cockerham about continuing dust problem. Called Mr. Bridenbeck who reported his investigation revealed that the harbor spoils were apparently being disposed of at another location and this issue was caused by an operating dirt pit.

10/3/2008 - Nick Gatian spoke with Harrison Co. Development Commission and confirmed that dredge spoils wer NOT going to the site identified in the COE permit and DEQ water quality certification. Diane Gledhill responded to the site on Latimer Road and found that the harbor dredge spoils were bleng dumped at this site. She also visited the harbor and observed the loading of the dump trailers. While prcaution was being taken not to spill material on the outside of the trucks during loading, the material is very liquid and no efforts are made to inspect the truck for spillage or leaking. Also there is no cleaning of the back of the trucks after dumping which allows material to drip onto roadway.

Spoke with the contractor, Mr. W.C. Fore, who has provided documentation of the approval of the site for spoil disposal. I advised Mr. Fore to take reasonable precautions to minimize dripping of material on the roadways and to address the issue when it does. He advised that they were taking precautions and had done some road sweeping.

MDEQ CTS

v2.09.04.02

BONJOUR BECKY COMYNS!

[HOME](#) [ADMIN](#) [NEW](#) [REPORTS](#) [MY CTS](#) [SIGNOUT](#)[Get ID](#)**COMPLAINT ID: 29034****Complaint Date:** 09/22/2008**County:** Harrison (SRO)**Office:** Pollution Control

Complaint Call Report

Complaint Call Information**Anonymous:** No**Complaint Caller**

Person Name: Douglas Cockerham
Address Line 1: Latimer Road
Address Line 2:
City, State, Zip: Gulfport, MS
Telecom 1: 228-831-1577
Telecom 2:
Telecom 3:
Email:

Alleged Complaint Site

Site Name: Latimer Road
Person Name:
Address Line 1:
Address Line 2:
City, State, Zip: Gulfport, MS
Telecom 1:
Telecom 2:
Telecom 3:
Email:

Complaint Type: Stormwater Runoff, Other

Complaint Description: Trucks are dripping dredge spoils on the road from the Gulfport Yacht Club project. Causing bad dust problems in the neighborhood. Mr. Cockerham is concerned that the spoils are too "toxic" to put in Ms Sound but are being spilled on the street.

Complaint Site Directions: Latimer Road north off Dedeaux. Latimer Road is Half way between Three Rivers and Lorraine road intersections.

Taken By: Nick Gatian (Field Services/South Regional Office)

Phone: 228-432-1056 x107

Complaint Origin: Phone

Complaint Investigation Information

Complaint Status: Closed / Resolved

Task Log

Task Description	Assigned To	Due	Completed	Comments
Assign Complaint Investigator	Gatian, Nick	09/22/2008	09/22/2008	
Investigate Complaint	Gatian, Nick	09/25/2008	09/26/2008	
RO Report Routed to Main Office	Gatian, Nick	09/25/2008	09/26/2008	
Assign Resolution Staff	Parrish, Ann	10/21/2008	10/21/2008	
Follow-up Scheduled	Gatian, Nick	10/03/2008	10/03/2008	Follow up report sent to Main Office 10/15/2008
Close/Resolve Complaint	Lavallee, Louis	10/23/2008	10/23/2008	No further action. Recent rain has resolved the dust problem.

Complaint Investigator: Gatian, Nick

Complaint Media: Other / Unknown

Complaint Class: Stormwater - MS4

Complaint Class Notes:

Complaint Basin:

Complaint Investigation Notes: Routed to Mark Bridenbeck (228-518-0812), City of Gulfport, 9/22/2008. He is sending a crew to the area to sweep the street. Also contacted Lamont Ladner with W.C. Fore which is the company doing the dredge/hauling work to advise them to better secure their vehicles. 9/26/2008 - Mr. Ladner advised they checked all the trucks and fixed the tail gates on the ones leaking. Have also send street sweeper to clean up. 10/2/2008 - Received another call from Mr. Cockerham about continuing dust problem. Called Mr. Bridenbeck who reported his investigation

revealed that the harbor spoils were apparently being disposed of at another location and this issue was caused by an operating dirt pit. 10/3/2008 - Nick Gatian spoke with Harrison Co. Development Commission and confirmed that dredge spoils were NOT going to the site identified in the COE permit and DEQ water quality certification. Diane Gledhill responded to the site on Latimer Road and found that the harbor dredge spoils were being dumped at this site. She also visited the harbor and observed the loading of the dump trailers. While precaution was being taken not to spill material on the outside of the trucks during loading, the material is very liquid and no efforts are made to inspect the truck for spillage or leaking. Also there is no cleaning of the back of the trucks after dumping which allows material to drip onto roadway. Spoke with the contractor, Mr. W.C. Fore, who has provided documentation of the approval of the site for spoil disposal. I advised Mr. Fore to take reasonable precautions to minimize dripping of material on the roadways and to address the issue when it does. He advised that they were taking precautions and had done some road sweeping.

Assigned Staff: Lavallee, Louis

Complaint Resolution: 10/23/08- I called the complainant, Douglas Cockerham at 228-831-1577. Mr. Cockerham said that last night's rain had resolved the dust problem for now. He said the City swept the street last week but that only aggravated the dust. He would like them to water the street during dry weather. He said he spoke to the trucking company and the drivers have been very careful through the residential area. He appreciated our office looking into it. The problem has been the dust. Mr. Cockerham said the number of trucks traveling the road had greatly declined in the past few days. I spoke with Ethan Mayeu who noted that we did not have jurisdiction over the dredge operation and disposal of the spoils, nor over the dust on the road. From a previous complaint several years ago, the dust on Latimer Road at that time was due mainly to trucks tracking dust out of the disposal area after unloading the dredge spoils.

Complaint Entities

Confirmed Complaint Site

Site Name: W. C. Fore Trucking

Person Name: Lamont Ladner

Entity Type:

Address Line 1:

Address Line 2:

City, State, Zip: Gulfport , MS

Telecom 1: 228-863-1314

Telecom 2: 228-297-1317

Telecom 3:

Email:

enSite AI ID:

enSite Person ID:

Permit Number(s):

Complaint GPS Location

Location ID: 1 [Map It]

Latitude: 030.436403

Longitude: -088.971953

Coord System: Unknown

Coord Org: GPS Code (Psuedo Range) Standard Position (SA Off)

Point Desc:

File Attachments

Name	Type	User Added	Date Added
REPORT_29034_09-26-2008.doc	Investigation Report	Nick Gatian	09/26/2008
REPORT_29034_10-15-2008.doc	Investigation Report	Nick Gatian	10/15/2008
29034pic1.doc	Other	Diane Gledhill	10/22/2008
29034pic2.doc	Other	Diane Gledhill	10/22/2008

Fish Kill

Fish Kill Information

Other

Complaints To Watch: Add / Remove

Related Complaints: 28937.

File

MDEQ COMPLAINT INVESTIGATION REPORT

Complaint ID: 30185

Report Date: 12-Jun-09

Complaint Taken: 11-JUN-09

Investigator: Becky Comyns *pc*

County: Harrison

Date Investigated: 12-JUN-09

Media: Air, Other / Unknown

CONFIRMED COMPLAINT SITE

RESPONSIBLE PARTY/CONTACT PERSON

NAME:

NAME:

SITE NAME:

SITE NAME: *W.C. Fore Trucking, Grandfather
Pot Mine*

ADDRESS LINE 1:

ADDRESS LINE 1:

ADDRESS LINE 2:

ADDRESS LINE 2:

CITY, STATE, ZIP:

CITY, STATE, ZIP:

TELECOM 1:

TELECOM 1:

TELECOM 2:

TELECOM 2:

AI ID:

AI: 3888

GPS DATA

LOCATION DESCRIPTION: No data for this complaint ID

LATITUDE: Null° Null' Null"

LATITUDE DD: Null

LONGITUDE: Null° Null' Null"

LONGITUDE DD: Null

SECTION/TOWNSHIP/RANGE: Null/Null/Null

QUARTER SECTION: Null/Null

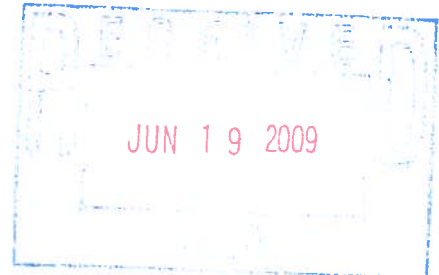

MDEQ COMPLAINT INVESTIGATION REPORT

MARK ONE OF THE FOLLOWING:	<input type="checkbox"/>	-PHOTOS ATTACHED	<input checked="" type="checkbox"/>	-RESOLVED BY RO
	<input type="checkbox"/>	-MAP ATTACHED	<input type="checkbox"/>	-ROUTE TO ECED FOR RESOLUTION
	<input type="checkbox"/>	-OTHER ATTACHMENTS		

INVESTIGATION NOTES:

Refer to Complaint # 29034 for same complaint about dusting from trucks carrying Gulfport Harbor dredge spoils to WC Fore pit on Latimer Road.

On 6/12/2009 I called Mark Bridenbeck, environmental officer with the City of Gulfport, at 228.518.0812. He stated that he would talk to Mr. Fore about cleaning the trucks after dumping the material into the pit, since the clumps that fall off onto the road and then dry out are what apparently is causing most of the dust problem. He will also address the accumulated dust already on Latimer Road.

MDEQ CTS Online

Complaint ID: 30185

County: Harrison (SRO)

Complaint Date: 06/11/2009

Taken By: Becky Comyns (Field Services/South Regional Office)

Phone Number: 228.432.1056

Origin: Phone

Complaint Description:

Mr. Allen stated that Mr. Fore has been hauling truckloads of dredge material from the Gulfport harbor down Latimer Road and then dumping it in the pit. The dust from the trucks has been terrible, and this has been going on at different times for months.

Complaint Location:

From I-10, take the Cowan-Lorraine exit and go north. Take a left on Dedeaux Road, and then a right onto Latimer Road. Go all the way to the end.

Complaint Generic Type:

Other

Complainant Information

Name: John Allen

Address Line 1: 11102 Latimer Road

Address Line 2:

City, State, Zip: Gulfport, MS 39503

Telecom 1: 228.832.6816

Telecom 2:

Telecom 3:

Email:

Alleged Site Information

Site Name: Pit at north end of Latimer Road

Person Name: Mr. Fore

Entity Type: Owner

Address Line 1: Latimer Road

Address Line 2:

City, State, Zip: Gulfport, MS 39503

Telecom 1:

Telecom 2:

Telecom 3:

Email:

File

MDEQ COMPLAINT INVESTIGATION REPORT

Complaint ID: 30192

Report Date: 12-Jun-09

Complaint Taken: 12-JUN-09

Investigator: Becky Comyns *ee*

County: Harrison

Date Investigated: 12-JUN-09

Media: Air, Other / Unknown

CONFIRMED COMPLAINT SITE

NAME:

SITE NAME:

ADDRESS LINE 1:

ADDRESS LINE 2:

CITY, STATE, ZIP:

TELECOM 1:

TELECOM 2:

AI ID:

RESPONSIBLE PARTY/CONTACT PERSON

NAME:

SITE NAME: *W.C. Fore Trucking, Grandfather Pat mine*

ADDRESS LINE 1:

ADDRESS LINE 2:

CITY, STATE, ZIP:

TELECOM 1:

TELECOM 2:

AI : 3888

GPS DATA

LOCATION DESCRIPTION: No data for this complaint ID

LATITUDE: Null° Null' Null"

LATITUDE DD: Null

LONGITUDE: Null° Null' Null"

LONGITUDE DD: Null

SECTION/TOWNSHIP/RANGE: Null/Null/Null

QUARTER SECTION: Null/Null

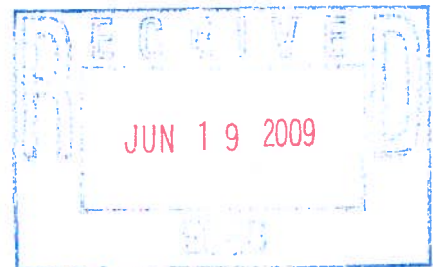

MDEQ COMPLAINT INVESTIGATION REPORT

MARK ONE OF THE FOLLOWING:

<input type="checkbox"/>	-PHOTOS ATTACHED	<input checked="" type="checkbox"/>	-RESOLVED BY RO
<input type="checkbox"/>	-MAP ATTACHED	<input type="checkbox"/>	-ROUTE TO ECED FOR RESOLUTION
<input type="checkbox"/>	-OTHER ATTACHMENTS		

INVESTIGATION NOTES:

Refer to Complaint # 29034, # 30185 and # 30187 for same complaint about dusting from trucks carrying Gulfport Harbor dredge spoils to WC Fore pit on Latimer Road. On 6/12/2009 I called Mark Bridenbeck, environmental officer with the City of Gulfport, at 228.518.0812. He stated that he would talk to Mr. Fore about cleaning the trucks after dumping the material into the pit, since the clumps that fall off onto the road and then dry out are what apparently is causing most of the dust problem. He will also address the accumulated dust already on Latimer Road. I told Ms. Tippetts this information- I also gave her Mark Bridenbeck's number in case the dust problem continues.

MDEQ CTS Online

Complaint ID: 30192

County: Harrison (SRO)

Complaint Date: 06/12/2009

Taken By: Becky Comyns (Field Services/South Regional Office)

Phone Number: 228.432.1056

Origin: Phone

Complaint Description:

Same dusting complaint as complaint #'s 30185 and 30187. Also see prior 2008 complaint, number 29034 Mrs. Tippetts's daughter and son-in-law, Mr. and Mrs. Russell Sonnier who live 11130 Latimer Road also wish to file a dusting complaint.

Complaint Location:

Latimer Road off Dedeaux Road.

Complaint Generic Type:

Other

Complainant Information

Name: Pat Tippetts

Address Line 1: 11120 Latimer Road

Address Line 2:

City, State, Zip: Gulfport, MS 39503

Telecom 1: 228.832.3893

Telecom 2:

Telecom 3:

Email:

Alleged Site Information

Site Name: Pit on north end of Latimer Road

Person Name: WC Fore

Entity Type: Owner

Address Line 1: Latimer Road

Address Line 2:

City, State, Zip: Gulfport, MS 39503

Telecom 1:

Telecom 2:

Telecom 3:

Email:

File

MDEQ COMPLAINT INVESTIGATION REPORT

Complaint ID:	30197		
Report Date:	12-Jun-09	Complaint Taken:	12-JUN-09
Investigator:	Becky Comyns <i>pc</i>	County:	Harrison
Date Investigated:	12-JUN-09	Media:	Air, Other / Unknown

CONFIRMED COMPLAINT SITE

NAME:
SITE NAME:
ADDRESS LINE 1:
ADDRESS LINE 2:
CITY, STATE, ZIP:
TELECOM 1:
TELECOM 2:
AI ID:

RESPONSIBLE PARTY/CONTACT PERSON

NAME:
SITE NAME: *W. C. Fore Trucking,
Grandfather Pit Mine*
ADDRESS LINE 1:
ADDRESS LINE 2:
CITY, STATE, ZIP:
TELECOM 1:
TELECOM 2:
AI: 3888

GPS DATA

LOCATION DESCRIPTION: No data for this complaint ID
LATITUDE: Null° Null' Null"
LATITUDE DD: Null
LONGITUDE: Null° Null' Null"
LONGITUDE DD: Null
SECTION/TOWNSHIP/RANGE: Null/Null/Null
QUARTER SECTION: Null/Null

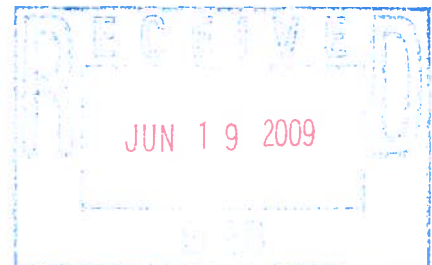

MDEQ COMPLAINT INVESTIGATION REPORT

MARK ONE OF THE FOLLOWING:

<input type="checkbox"/>	-PHOTOS ATTACHED	<input checked="" type="checkbox"/>	-RESOLVED BY RO
<input type="checkbox"/>	-MAP ATTACHED	<input type="checkbox"/>	-ROUTE TO ECED FOR RESOLUTION
<input type="checkbox"/>	-OTHER ATTACHMENTS		

INVESTIGATION NOTES:

I called Mark Bridenbeck with the City of Gulfport again after taking Mr. Cockerham's complaint. Mark said he had talked again with a woman at the WC Fore business office, who said their watering trucks were off on another large job. Mark told her that we have now received several complaints, and that watering was very necessary. He was going to suggest that they water the road earlier in the day to keep them from getting so dusty by late afternoon. He said he saw a watering hose at the disposal pit, but doubted that it could knock off heavy clumps of the dredge material from the trucks before they went back down Latimer Road (several of the complainants stated that the clumped material falls off onto the road after the trucks have emptied at the pit, and then is allowed to dry out and become airborne).

Right after Mr. Cockerham's call, I received one from Mr. Flowers, council elect for Harrison County Ward 6 (228.265.0806). He had also received complaints from his constituents along Latimer Road, and said he had called Mr. Fore's office also and asked that the road be watered more frequently.

MDEQ CTS Online

Complaint ID: 30197

County: Harrison (SRO)

Complaint Date: 06/12/2009

Taken By: Becky Comyns (Field Services/South Regional Office)

Phone Number: 228.432.1056

Origin: Phone

Complaint Description:

See complaints #29034,30185,30187, and 30192 - all pertain to dusting on Latimer Road from trucks hauling dredge spoils from the Gulfport Harbor. At 4:00pm Mr. Cockerham stated that the dust on Latimer Road was still very heavy and that he hadn't seen any watering activities. He is worried about children on road breathing the dust, especially since the material from the harbor may be toxic.

Complaint Location:

Cowan Lorraine Road north, take a left on Dedeaux Road, then a right onto Latimer Road.

Complaint Generic Type:

Other

Complainant Information

Name: Douglas Cockerham

Address Line 1: 819 Latimer Road

Address Line 2:

City, State, Zip: Gulfport, MS 39503

Telecom 1: 228.831.1577

Telecom 2:

Telecom 3:

Email:

Alleged Site Information

Site Name: Pit at north end of Latimer Road

Person Name: WC Fore

Entity Type:

Address Line 1: Latimer Road

Address Line 2:

City, State, Zip: Gulfport, MS 39503

Telecom 1:

Telecom 2:

Telecom 3:

Email:

MISSISSIPPI DEPARTMENT OF ENVIRONMENTAL QUALITY
OFFICE OF GEOLOGY - MINING AND RECLAMATION DIVISION

INSPECTION REPORT

Operator: W. C. Fore Trucking, Inc. Copy to Operator: Yes
Application/Permit #: P88-027A Acres: 76 Inspection Type: Annual
Inspected By: Ron Porter Date: 08-08-2008
Location of Operation: NW 1/4 of SW 1/4 Section 1, Township 7 South, Range 11 West, Harrison County, Mississippi
Mining Status: Inactive "Granthfather Pat" AI# 3888
Within Permit Limits? Yes MSR 32 0294
Mining Without Permit? No
Mining Within 300 Feet of Occupied Dwelling? No
Mining Within 100 Feet of Right of Way? No
Identification Sign: Absent
Monitor or Location Marker: Absent
Water Control: Adequate
Sediment Pond: Adequate
Sediment Runoff: Not Excessive
Dam(s) to Pond(s) Present: Appear Adequate

RECLAMATION

Progress: Adequate
Plan Filed: 3 to 1 grassed slope
Plan Implemented: same
Debris Disposal: Proper
Slopes: 3 Horizontal to 1 Vertical
Slope Condition: Stable
Vegetative Cover: Fair

Comments: The operator must post & maintain a permit sign and location markers along the permit boundary for the life of the permit, which is until final bond release. The operator shall maintain all best management practices (BMPs) as required in the NPDES Mining General Permit.

BR Status:

BR Recommendation:

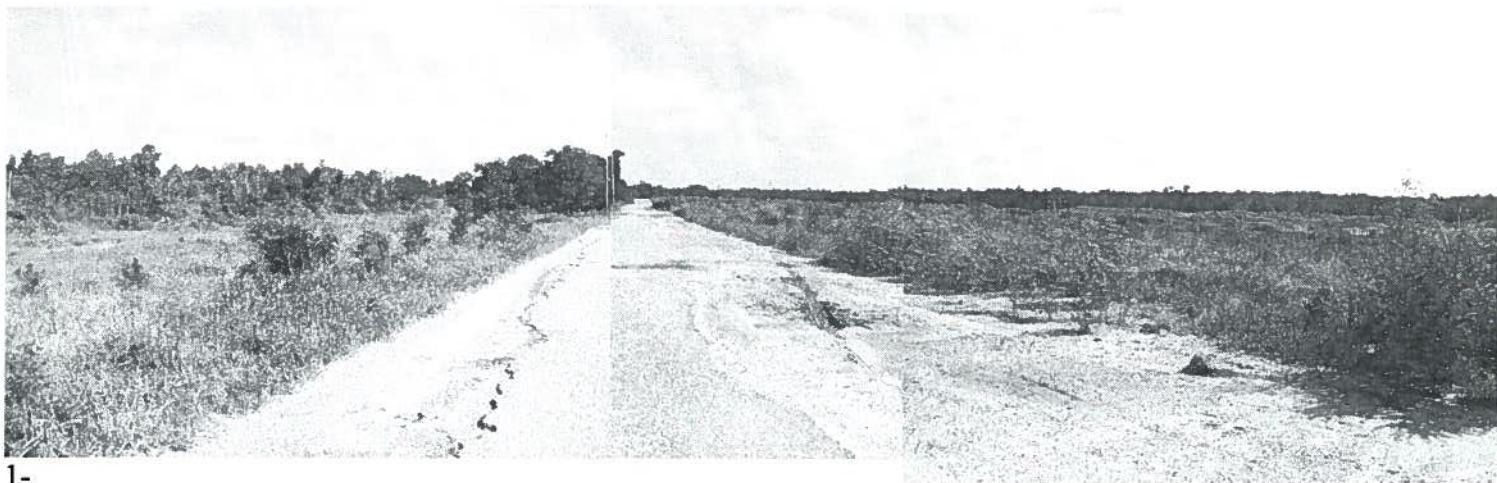

1-



Not to Scale

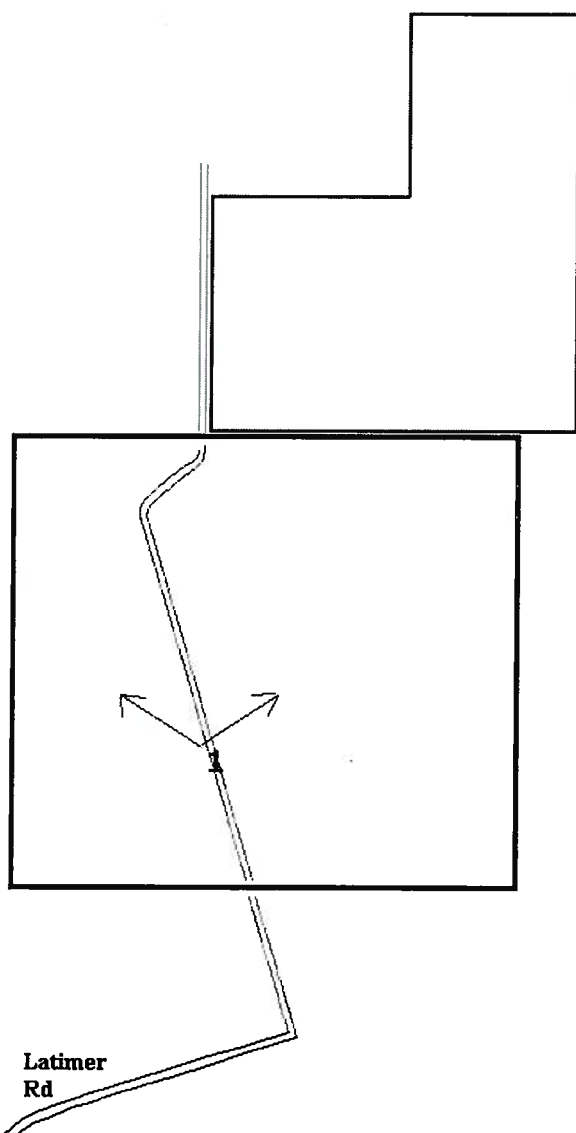

Storm Water Inspection

September 16, 2008

To: **Louis Lavallee**
Office of Pollution Control
Compliance & Enforcement Division

From: **Ron Porter**
Office of Geology
Mining & Reclamation Division

Re: W. C. Fore Trucking, Inc. P88-027A AI# 3888 76 Acres "Grandfather Pat" Harrison Co.

On August 8, 2008, I inspected the above referenced site. This site is currently inactive. Storm water appears to be contained on site. The site appears to have re-vegetated itself. There are no scales, plant, or office located on site. There is no debris disposal at this site.

STORM WATER INSPECTION

August 14, 2007

Chris Sanders OPC/ECED
Solid Waste and Mining

RE: Latimer Rd. Pit

On July 25, 2007 I inspected the Latimer Rd Pit (**W.C. Fore Trucking P88-027A**) in Harrison County. This is supposed to be a 76 acre open pit mine for sand and clay. All storm water appears to be contained on site within the pit area. Vegetation is fair south and very poor north. It does appear as if some storm debris was buried in this area within the last 2 years. There is no current debris disposal occurring. There is no office, etc. at this site.

James Matheny
Environmental Scientist
Mining and Reclamation Division
EXT 5527

Enclosure

MISSISSIPPI DEPARTMENT OF ENVIRONMENTAL QUALITY
 OFFICE OF GEOLOGY - MINING AND RECLAMATION DIVISION
 INSPECTION REPORT

Operator:	<u>W. C. Fore Trucking, Inc.</u>	Copy to Operator: <u>Yes</u>
Application/Permit #:	<u>P88-027A</u> Acres: <u>76</u>	Inspection Type: <u>Annual</u>
Inspected By:	<u>J. Matheny</u>	Date: <u>07-25-2007</u>
Location of Operation:	<u>NW 1/4 of SW 1/4 Section 1, Township 7 South, Range 11 West, Harrison County, Mississippi</u>	
Mining Status:	<u>Inactive</u>	
Within Permit Limits?	<u>No</u>	Acres Exceeding permit Limits: <u>0</u>
Mining Without Permit?	<u>No</u>	
Mining Within 300 Feet of Occupied Dwelling?	<u>No</u>	<u>AI 3888</u>
Mining Within 100 Feet of Right of Way?	<u>No</u>	<u>MSR 32-0294</u>
Identification Sign:	<u>Absent</u>	
Monitor or Location Marker:	<u>Absent</u>	
Water Control:	<u>Adequate</u>	
Sediment Pond:	<u>Adequate</u>	
Sediment Runoff:	<u>Not Excessive</u>	
Dam(s) to Pond(s) Present:	<u>Appear Adequate</u>	
RECLAMATION		
Progress:	<u>Inadequate</u>	<u>2002</u>
Plan Filed:	<u>3:1 slopes; grass</u>	
Plan Implemented:	<u>highwall west; poor vegetation</u>	
Debris Disposal:	<u>Proper</u>	
Slopes:	<u>vary Horizontal to Vertical</u>	
Slope Condition:	<u>Unstable</u>	
Vegetative Cover:	<u>Poor</u>	
Comments:	The operator appears to be mining outside of the permit boundaries to the north. This area must be permitted. The operator must maintain a permit sign and boundary markers until final bond release.	
BR Status:		
BR Recommendation:		



#1



#2

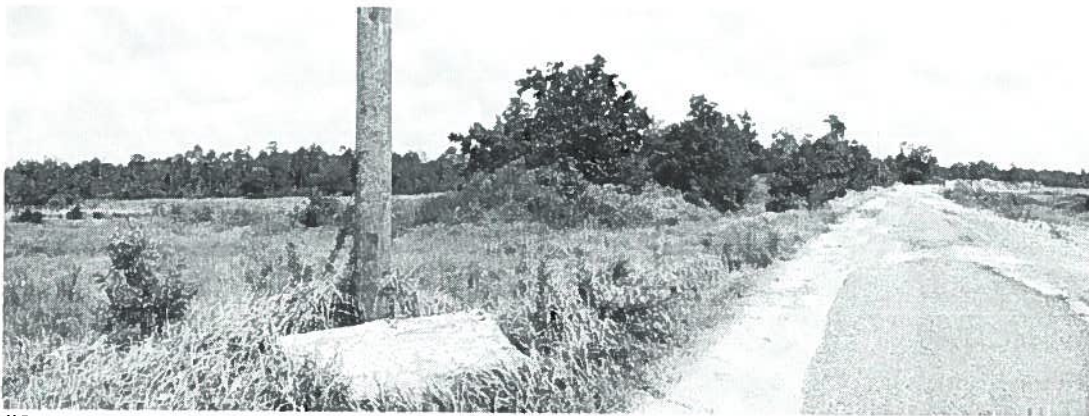

#3



#4



#5



#6



#7



#8



#9

W.C. Fore Trucking P88-027A

A072507JM

page 4 of 5



W.C. Fore Trucking P88-027A
76 acres in Harrison Co.
Annual Insp. 7/25/07
J.Matheny

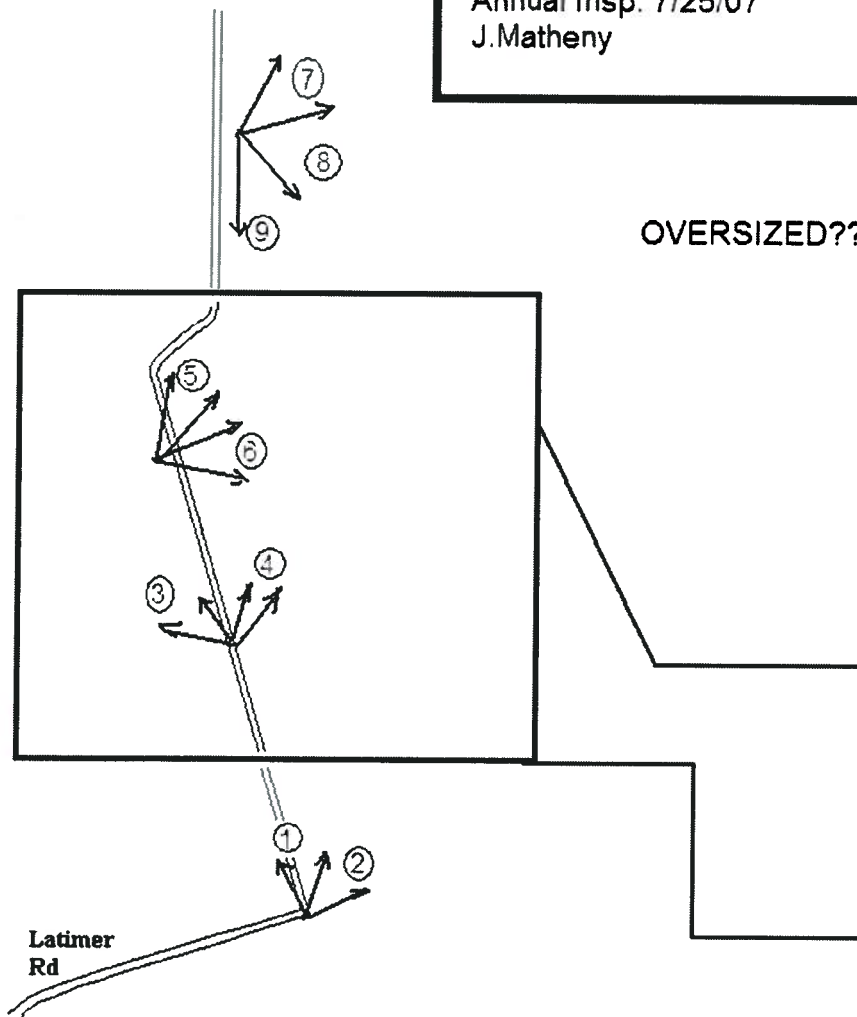

STATE OF MISSISSIPPI
HALEY BARBOUR
GOVERNOR
MISSISSIPPI DEPARTMENT OF ENVIRONMENTAL QUALITY
TRUDY D. FISHER, EXECUTIVE DIRECTOR

August 15, 2007

Mr. Wallace C. Fore
W. C. Fore Trucking, Inc.
P. O. Box 3058
Gulfport, MS 39505

Dear Mr. Fore:

Enclosed is a copy of the annual inspection report for the area covered by Surface Mining Permit P88-027A in Harrison County Mississippi.

The operator appears to be mining outside of the permit boundaries to the north. This area must be permitted. The operator must maintain a permit sign and boundary markers until final bond release.

Sincerely,

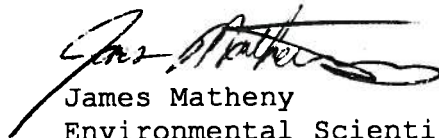

James Matheny
Environmental Scientist
Mining and Reclamation Division

Enclosure

**MISSISSIPPI DEPARTMENT OF ENVIRONMENTAL QUALITY
OFFICE OF GEOLOGY - MINING AND RECLAMATION DIVISION
INSPECTION REPORT**

Operator: W. C. Fore Trucking, Inc. Copy to Operator: Yes
 Application/Permit #: P88-027A Acres: 76 Inspection Type: Annual
 Inspected By: Ron Porter Date: 08-04-2006
 Location of Operation: NW 1/4 of SW 1/4 Section 1, Township 7 South, Range 11 West, Harrison County, Mississippi

Mining Status: Active "Granthfather Pat"
 Within Permit Limits? Yes
 Mining Without Permit? No
 Mining Within 300 Feet of Occupied Dwelling? No
 Mining Within 100 Feet of Right of Way? No
 Identification Sign: Absent
 Monitor or Location Marker: Absent
 Water Control: Adequate
 Sediment Pond: Adequate
 Sediment Runoff: Not Excessive
 Dam(s) to Pond(s) Present: Appear Adequate

AI 3888
MSR32 0294
STORMWATER SEP - 1 2006

RECLAMATION

Progress: Inadequate Scheduled to be completed by the end of 2002
 Plan Filed: minimal required = 3 to 1 grassed slopes
 Plan Implemented: nothing
 Debris Disposal: Proper
 Slopes: vary Horizontal to Vertical
 Slope Condition: Unstable High walls present and no grass cover
 Vegetative Cover: Very Poor

Comments: Completion of reclamation for this site is scheduled to be completed by the end of 2002. This schedule was not met, therefore; the operator is required to file a new plan for completion of reclamation (see attached form). Please keep in mind that the bond release process, once the initial release has been granted, takes a minimum of 2 years to complete. New dates should not extend beyond five years from August of 2006 (August of 2011). There is much work to be done. We recommend the establishment of a grassy cover and implementation of appropriate best management practices (BMP's) in all areas as soon as the dirt work for that area has been completed.

BR Status:

BR Recommendation:



1-



2-



3-



4-

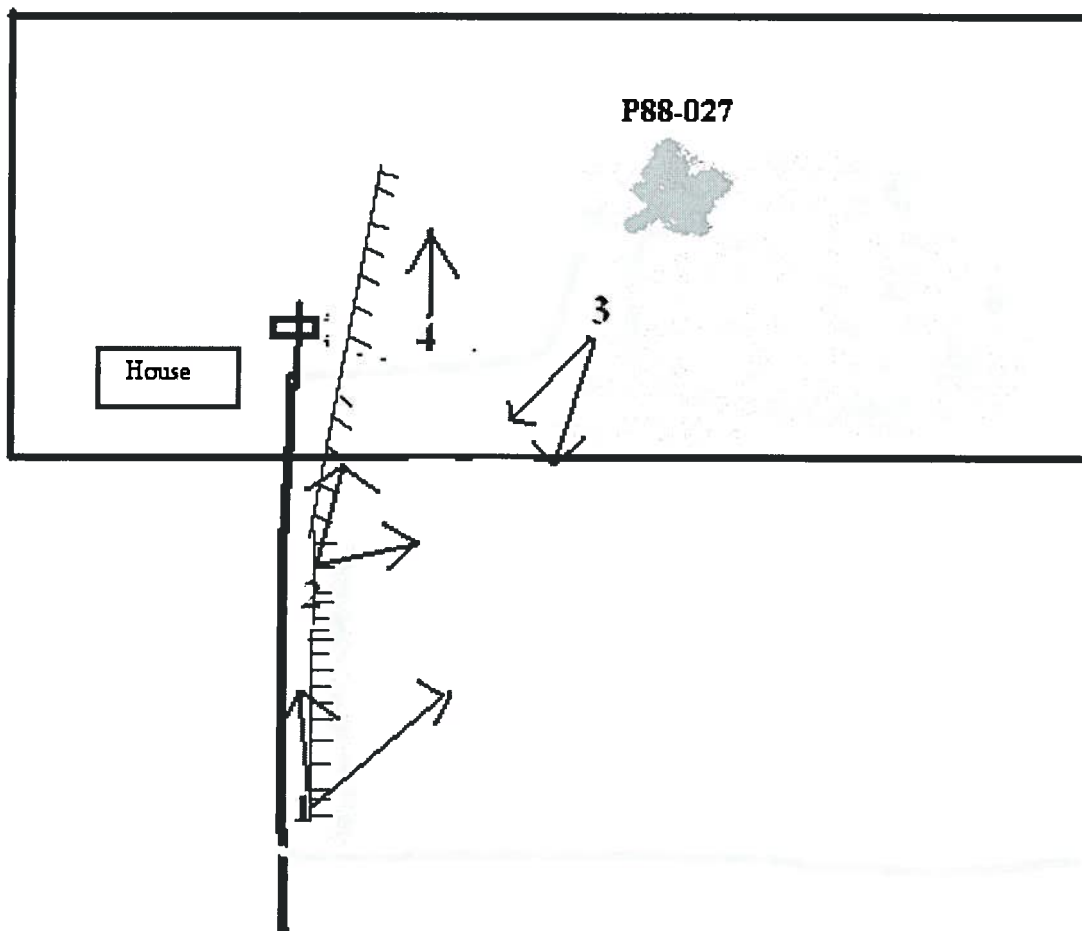

W. C. Fore Trucking Inc.

Per-027A

76-Acres

"Grandfather Pat"

Harrison County

Storm Water: Storm water appears to be contained on site and routed to sediment basin.



STATE OF MISSISSIPPI

HALEY BARBOUR

GOVERNOR

MISSISSIPPI DEPARTMENT OF ENVIRONMENTAL QUALITY

CHARLES H. CHISOLM, EXECUTIVE DIRECTOR

MEMORANDUM

Date: March 9, 2005

From: Louis Lavallee *LL*

Through: Chris Sanders *CS*

To: file

Subject: Inspection, W. C. Fore, Grandfather Pat Mine, OG P88027, MSR320294
S1, T7S, R11W, Latimer Road, Harrison County *A1 3888*

On Tuesday, 3/8/05, I visited subject mine about 11:45 a.m., as requested - to inspect for storm water compliance issues. The weather was sunny and clear, though it had rained the evening before. The National Weather Service recorded 0.26 inches of rain in Gulfport on the 7th. I drove and walked around the entire mined area and took the attached pictures.

The mine appeared to be inactive. I met no one, though there was a residence on the west side of the mine, about half way between the south and north ends. Latimer Road extends north along the west side of the mine to the house. Driving beyond the house to a barn takes one almost to the northern tip of the mine.

The entire mine was graded to keep sediment on-site. There were several ponds all with clear water. Two of the ponds discharged toward Fritz Creek. There were high walls and some erosion within the mine, but no apparent erosion of sediment from the mine. Marine dredged material placed in the southern part of the mine appeared stable and resistant to erosion. Most storm water from the dredged material would flow to the pond at the southeast corner, which had a small discharge through a grassed swale. See attached pictures.

There was a pile of gravel mixed with broken asphalt next to the road. This may be used for road bedding. The pile appeared to have no impact on storm water.

Attached pictures.

c: Office of Geology w/pictures

OFFICE OF POLLUTION CONTROL

POST OFFICE BOX 10385 • JACKSON, MISSISSIPPI 39289-0385 • TEL: (601) 961-5171 • FAX: (601) 354-6612 • www.deq.state.ms.us

AN EQUAL OPPORTUNITY EMPLOYER

W. C. Fore, Grandfather Pat mine, Harrison Cty, OG P87-027, MSR320294, 3/8/05; Looking N from S boundary of mined area. Storm water flows to pond on right. Light-gray colored soil in distance is marine dredge material, which has been placed on some of the mined area. It appeared resistant to erosion.



Full view of pond from same point. Discharge was from the NE corner (left, back).



There was a small discharge of clear water through the tall grass.



W. C. Fore, Grandfather Pat mine, Harrison Cty, OG P87-027, MSR320294, 3/8/05; Looking SW from near NE corner of permitted area. Mine contoured to hold water. The light-gray soil in the distance is the marine dredge material, here viewed from the northeast.



Discharge from the marshy pond. Discharge is before the trees in above photo.



The clear discharge flowing into woods, toward Fritz Creek.



W. C. Fore, Grandfather Pat mine, Harrison Cty, P87-027, MSR320294, 3/8/05; Dredge material along E side of mine.



The dredge material did not appear eroded, nor tracked, onto the adjacent land to the east.



W. C. Fore, Grandfather Pat mine, Harrison Cty, OG P87-027, MSR320294, 3/8/05; Looking NE from bluff on W side. Large pond retains storm water. Edge of marsh to right.



Farther N at end of impacted area. Land is sloped to the ponds on the right. The far pond is also just visible in middle back of above picture.



W. C. Fore, Grandfather Pat mine, Harrison Cty, OG P87-027, MSR320294, 3/8/05; View S from far NW corner.



View along the NE border of the mine, looking SE. Saw no sediment eroded into the woods toward Fritz Creek.



Tree
stump

W. C. Fore, Grandfather Pat mine, Harrison Cty, OG P87-027, MSR320294, 3/8/05; View of pile of sand with pieces of asphalt next to road on W side. (Looking S.) Marine dredge material is in the distance; some recent loads dumped near the road.

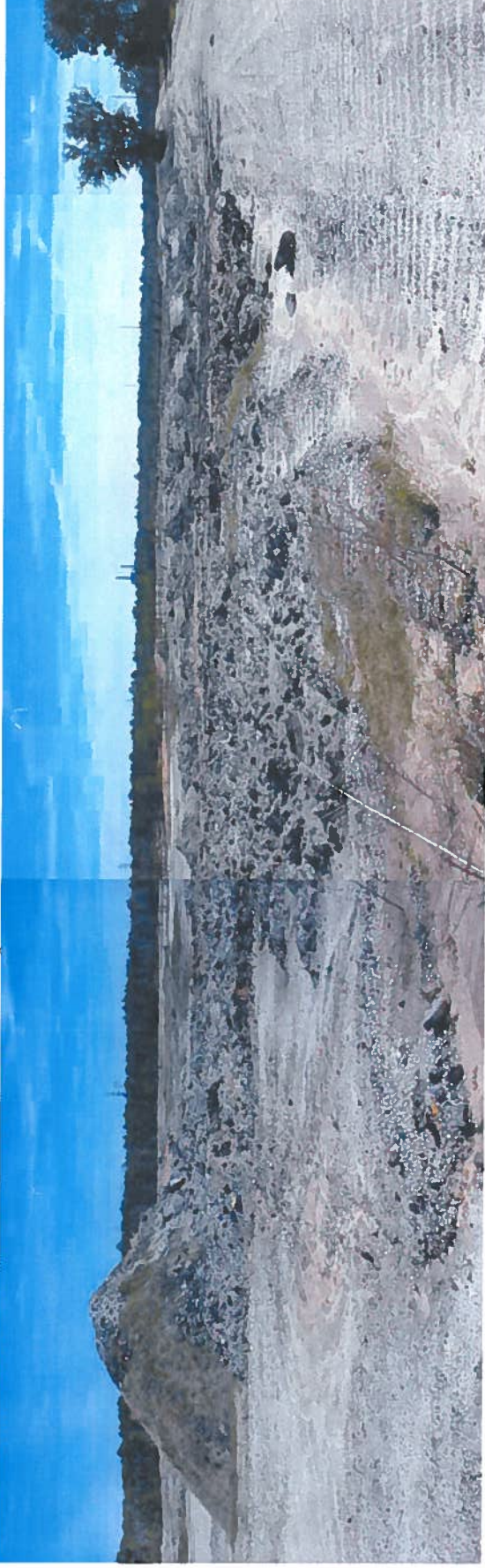

Another view of the gravel/broken asphalt pile.



A close-up of the pile.



11

file

OFFICE OF GEOLOGY - MINING AND RECLAMATION DIVISION
INSPECTION REPORT

Operator:	<u>W. C. Fore Trucking, Inc.</u>	Copy to Operator:	<u>Yes</u>
Application/Permit #:	<u>P88-027A</u>	Acres: <u>76</u>	Inspection Type: <u>Annual</u>
Inspected By:	<u>Ron Porter</u>	Date:	<u>08-05-2005</u>
Location of Operation:	<u>NW 1/4 of SW 1/4 Section 1, Township 7 South, Range 11 West, Harrison County, Mississippi</u>		
Mining Status:	<u>Active</u>	<u>"Grandfather Pat"</u>	<u>AI 3888</u> <u>MSR 320 294</u>
Within Permit Limits?	<u>Yes</u>		
Mining Without Permit?	<u>No</u>		
Mining Within 300 Feet of Occupied Dwelling?	<u>No</u>		
Mining Within 100 Feet of Right of Way?	<u>No</u>		
Identification Sign:	<u>Poor</u>	<u>Incorrect Permit Number</u>	
Monitor or Location Marker:	<u>Absent</u>		
Water Control:	<u>Adequate</u>		
Sediment Pond:	<u>Adequate</u>		
Sediment Runoff:	<u>Not Excessive</u>		
Dam(s) to Pond(s) Present:			

RECLAMATION

Progress:	<u>Inadequate</u>	<u>No dates on file</u>
Plan Filed:	<u>3 to 1 slopes and subdivided for home sites</u>	
Plan Implemented:	<u>none</u>	
Debris Disposal:	<u>Proper</u>	
Slopes:	<u>vary Horizontal to Vertical</u>	
Slope Condition:	<u>Unstable</u>	<u>no vegetation and highwalls</u>
Vegetative Cover:	<u>Very Poor</u>	

Comments:	<u>Operator must continue to monitor the stormwater conditions of this site and make the necessary corrections.</u>
BR Status:	

BR Recommendation:	
---------------------------	--



1-



2-



3-



4-



5-

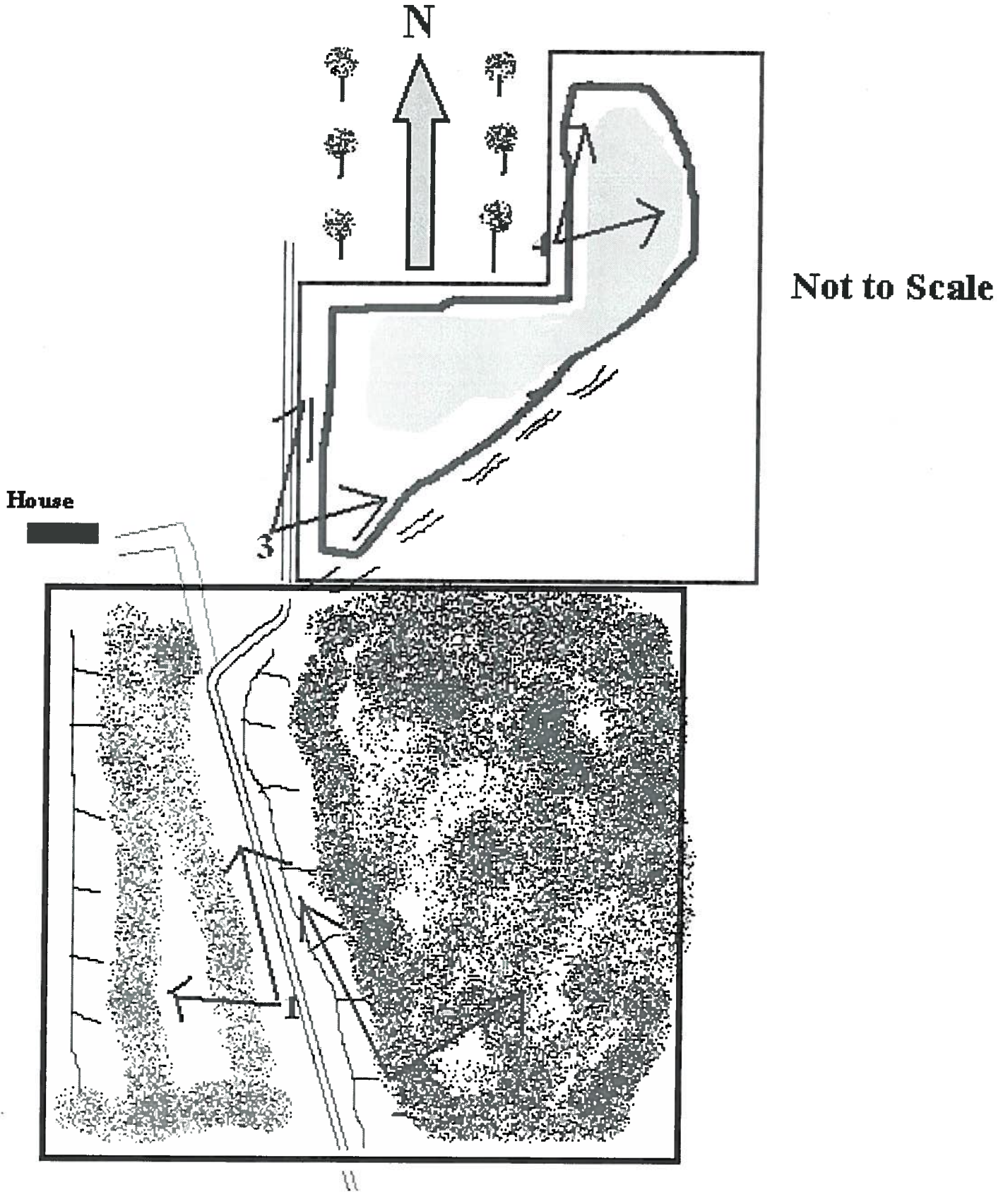

W. C. Fore Trucking, Inc. P88-027A 76-Acres "Granther Pat" Harrison County

Stormwater: Stormwater appears to be contained on site.

AI # 3888
GMP20050001

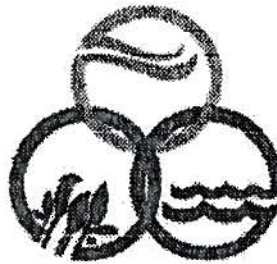

MISSISSIPPI DEPARTMENT OF ENVIRONMENTAL QUALITY

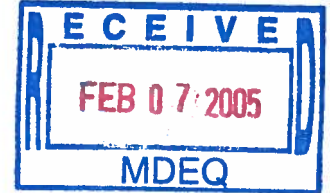

**MINING NOTICE OF INTENT (MNOD)
FOR COVERAGE UNDER MINING STORM WATER
GENERAL NPDES PERMIT MSR32 0294
(Number to be assigned by State)**

File at least 30 days prior to the commencement of mining; 15 days if a Storm Water Pollution Prevention Plan (SWPPP) is already on file. Lateral expansion of an existing mine that has storm water permit coverage does not require submittal of a new MNOI however, modification of the existing SWPPP to include the expansion is required. Also, according to 40 CFR 122.26 (b) (14) (iii), mining operations that do not discharge storm water contaminated by contact with any overburden, raw material, intermediate products, finished products, byproducts or waste products shall not be required to file a MNOL.

IS APPLICANT THE OPERATOR OR OWNER? (Circle one or both)

OPERATOR CONTACT PERSON: W. C. Fore

OPERATOR COMPANY NAME: W. C. Fore Trucking, Inc.

OPERATOR STREET (P. O. BOX): P. O. Box 3058

OPERATOR CITY: Gulfport STATE: MS ZIP: 39505

OPERATOR TELEPHONE NUMBER (INCLUDE AREA CODE): (228) 863-1314

(List owner if different than operator)

OWNER CONTACT PERSON: Same as Above

OWNER COMPANY: _____

OWNER STREET (P. O. BOX): _____

OWNER CITY: _____ STATE: _____ ZIP: _____

OWNER TELEPHONE NUMBER (INCLUDE AREA CODE): _____

(Mine information)

NAME OF MINE: Latimer Road Sand Mine

STREET ADDRESS OR NEAREST NAMED ROAD: Latimer Road

MINE LOCATION: CITY: Gulfport COUNTY: Harrison

(Mine information continued)

SW 1/4 OF NW 1/4 OF SECTION 1, TOWNSHIP 7 South, RANGE 11 West

ATTACH A USGS QUAD MAP OUTLINING MINE LOCATION
(Maps can be obtained from the Mississippi Office of Geology. For information call 601-961-5523).

RECEIVING STREAM: Fritz Creek

STANDARD INDUSTRIAL CLASSIFICATION (SIC) CODE: 1 4 4 2

MATERIAL TO BE MINED: Sand

TOTAL ACREAGE (If modification, give original acreage, expanded acreage and total acreage): Expanded
acreage is 38 Acres. Original acreage is 38 acres. Total Acreage is 76 acres

DOES THIS MINE NEED A CORPS OF ENGINEERS WETLANDS (Sec. 404) PERMIT? No

WILL HYDRAULIC DREDGING BE USED? (Y/N) No WASHING OF SAND/GRAVEL? (Y/N) No

LIST ANY: NPDES PERMIT NO. N/A STATE OPERATING PERMIT NO. N/A

GEOLOGY PERMIT APPLICATION NO. N/A GEOLOGY PERMIT NO. N/A

HAS A "NOTICE OF EXEMPT OPERATIONS" BEEN FILED WITH GEOLOGY? (Y/N) No

A Geology "Notice of Exempt Operations" or "Notice of Intent to Mine Class I or Class II Materials" must be filed before coverage will be granted under the mining storm water NPDES permit. For information on Office of Geology requirements call 601-961-5515.

ESTIMATED START DATE: 2/2005 END DATE: 12/2021

ATTACH A STORM WATER POLLUTION PREVENTION PLAN (SEE PERMIT FOR REQUIREMENTS)

IDENTIFY THE ASSOCIATION OR GENERIC SWPPP PREVIOUSLY SUBMITTED:

I certify under penalty of law that this document and all attachments were prepared under my direction or supervision in accordance with a system designed to assure that qualified personnel properly gathered and evaluated the information submitted. Based on my inquiry of the person or persons who manage the system, or those persons directly responsible for gathering the information, the information submitted is, to the best of my knowledge and belief, true, accurate and complete. I am aware that there are significant penalties for submitting false information, including the possibility of fine and imprisonment for knowing violations.

W. C. Fore
Signature:

January 31, 2005
Date Signed

W. C. Fore
Printed Name

President
Title

This application shall be signed according to the General Permit, Part V.E., as follows:

- For a corporation, by a responsible corporate officer.
- For a partnership, by a general partner.
- For a sole proprietorship, by the proprietor.
- For a municipal, state or other public facility, by either a principal executive officer, the mayor, or ranking elected official.
- Duly Authorized Representative

RECEIVED
FEB 07 2005
MDEQ MHE

LATIMER ROAD SAND MINE
(EXPANSION) 38 ACRES
GULFPORT NORTH QUADRANGLE
SECTION I
TOWNSHIP 7 SOUTH
RANGE 11 WEST

LATIMER ROAD SAND MINE
EXPANSION 38 ACRES

LATIMER ROAD SAND MINE
EXISTING 38 ACRES

NORTH LATIMER ROAD

Substation
DEDEAUX

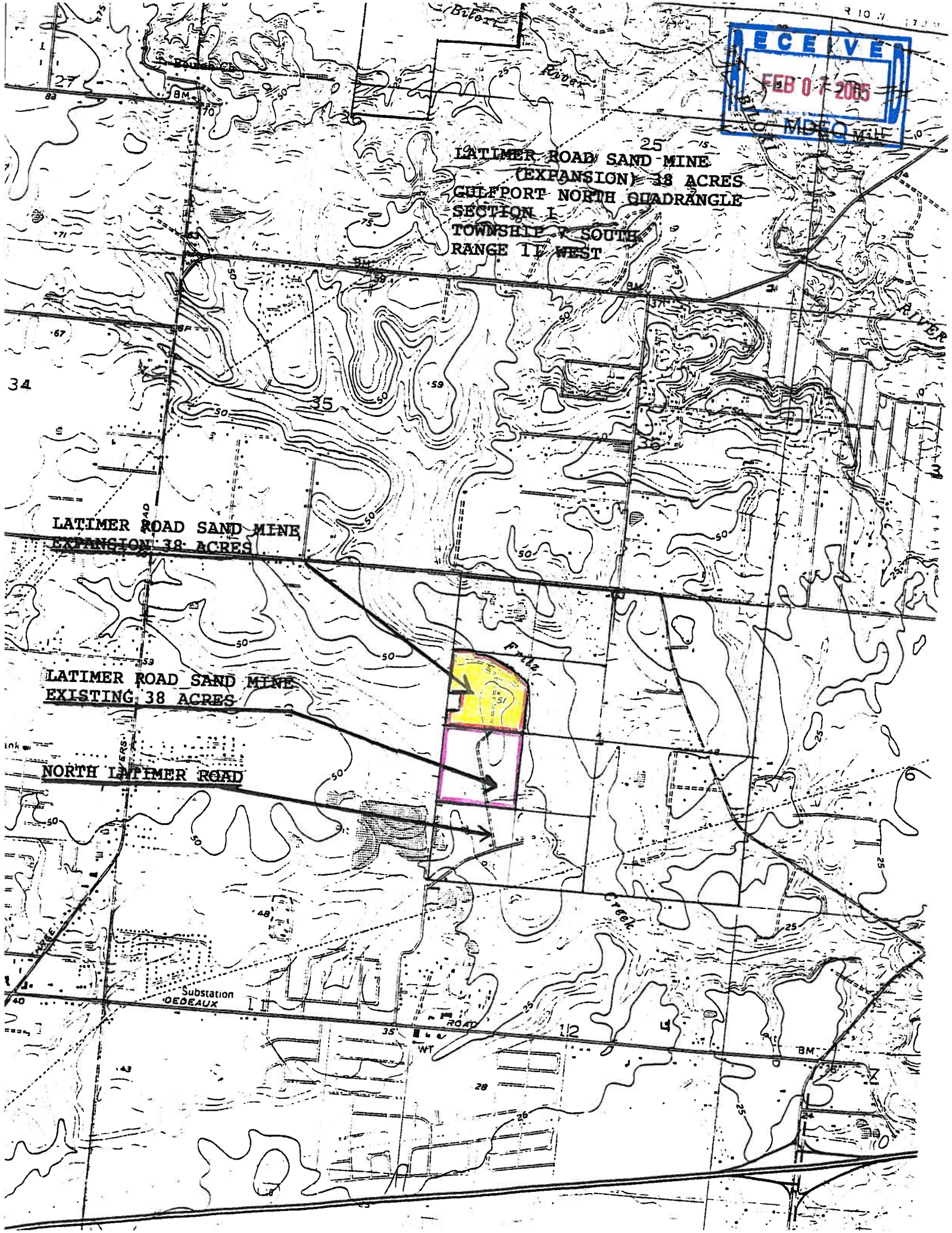

W. C. FORE TRUCKING, INC.

P. O. Box 3058 • Gulfport, MS 39505 • (228) 863-1314 • fax (228) 864-0013

February 1, 2005

Mississippi Department of Environmental Quality
Office of Pollution Control
Environmental Permits Division
Post Office Box 10385
Jackson, Mississippi 39289-0385

RECEIVED
FEB - 7 2005
Miss. of Environmental Quality
Office of Pollution Control

Attention: Mr. Ross Williams

Reference: **Surface Mining Permit Application Amendment,
Latimer Road Sand Mine,
Permit #: P88-027,
Harrison County, Mississippi**

Dear Mr. Williams,

Pursuant to the requirements of the Mississippi Surface and Reclamation Rules and Regulations outlining the requirements to submit a Mining Notice of Intent for the above captioned surface mining pit application, please find enclosed the required items to expand our current operations and they are delineated below.

1. Mining Notice of Intent
2. USGS Quadrangle Map
3. Site-specific Storm Water Pollution Prevention Plan (SWPPP).

This application is to amend the current permit number P88-027. The existing sand mine is 38 acres and is to be expanded by an additional 38 acres to provide us with a total of 76 acres.

If you have any questions at all, please do not hesitate to call our office.

Sincerely,



Michael Rouse

Encl. As Noted

**STORM WATER POLLUTION
PREVENTION PLAN
(SWPPP)**

**Latimer Road Sand Mine
38.0 Acre Amendment
S1, T7S, R11W**

**Gulfport,
Harrison County,
Mississippi**



**W. C. Fore Trucking, Inc.
Post Office Box 3058
Gulfport, MS 39505
(228) 863-1314**

STORM WATER POLLUTION CONTROL PLAN

**Latimer Road Sand Mine
38.0 Acre Amendment
Section 1, Township 7S, Range 11W
Harrison County, Mississippi**

Table of Contents

	Page
Overview	
Introduction	3
Objective	4
General Requirements	
Implementation	5
Erosion and Sediment Controls	6
Structural Practices	6
Inspection Requirements	8
Maintenance	8
Post Construction	9
Reporting	9
Noncompliance Reporting	
Anticipated Noncompliance	9
Unanticipated Noncompliance	9
Termination of Reporting and Permit Coverage	10
Pollution Prevention Plan Certification	10
Attachment 1	
Site Location Map	11
Reclamation Site Map	11



Typical Drawings

Typical Interceptor Dikes and Swales
Filter Fence Details
Brush Barrier
Typical Sediment Trap
Surface Roughening
Level Spreaders

Figure 1
Figure 2
Figure 3
Figure 4
Figure 5
Figure 6

OVERVIEW

Introduction

This document is the Storm Water Pollution Prevention Plan (SWPPP) for property owner and operator, W. C. Fore Trucking, Inc., Post Office Box 3058, Gulfport, Mississippi 39505, for the expansion of the surface mining pit known as "Latimer Road Sand Mine", a 38 acre site located in Gulfport, Harrison County, Mississippi. The expansion is for 38 acres to bring the existing sand mine to a total of 76 acres.

The purpose of this application is to allow W. C. Fore Trucking, Inc., Gulfport, Mississippi, the property owner and operator, to mine sand for a current project at the Mississippi State Port in Gulfport, Mississippi.

The existing haul road shall be utilized for ingress and egress. This haul road shall be reconstructed to become a stabilized all weather construction entrance for ingress and egress of all construction traffic. A buffer zone of 150 feet will be maintained to the north and northeast between the surface mine and the perennial Fritz Creek tributaries. The buffer zones shall remain in their natural vegetative state around the periphery of the site. Only those trees and vegetative growth will be removed that will impede the location and excavation processes of this surface sand mine. Storm water in the buffer zones will follow the existing natural watercourse. Disturbed areas caused by construction or mining activities shall be temporarily or permanently seeded as the circumstances direct. In the interim, sedimentation and erosion controls shall be put in place as needed. Flow of surface water into the mine will be controlled by the use of erosion control structures.

1. Clearing and excavation of the surface mining pit will be in a north to south direction. The removed topsoil shall be stockpiled and the overburden will be used to construct the perimeter berm of the mined area. The berm will be constructed and elevated above the existing natural ground. This raised levee will preclude storm water from entering the mined area from the

surrounding property. A temporary sump basin shall be located in the northeast area of the surface mining operation. The purpose of this temporary sump is to collect sediment and incidental stormwater falling into the sand mine. No impounded stormwater or sediment shall leave the sand mine. All storm water and ground water shall be contained within the confines of the mining pit. The earthen berms comprised of the stripped overburden around the periphery of the excavated areas shall preclude the mingling of the storm water outside the sand mine area and the ground water/stormwater from the excavation.

Storm water falling outside the sand mine area shall drain from the area through existing natural watercourses. Ultimately, the receiving waters of the State of Mississippi will be Fritz Creek to the north and northeast of the project. In its undeveloped state the surface sand mine area encompasses the 50-foot elevation, the highest point in the area and stormwater presently appears to flow to the west, east, and north.

The Storm Water Permit shall be displayed in a conspicuous location to enable public review.

This Plan is the criteria for compliance with regulations set forth by the Environmental Protection Agency, 40 CFR, Parts 122, 123 and 124, National Pollutant Discharge Elimination System Application Regulations for Storm Water Management for Construction Activities.

Objective

The purpose and objective of this Storm Water Pollution Prevention Plan is to meet the requirements of the State of Mississippi and the U. S. Environmental Protection Agency for the control and mitigation of pollutants to storm water discharges associated with this surface mining operation for sand and clay.

GENERAL REQUIREMENTS

This Storm Water Pollution Prevention Plan consists of certain major activities and controls appropriate for surface mining activities.

Implementation

1. Install stabilized construction entrance.
2. Install erosion control structures as needed.
3. Perform stripping activities: Topsoil shall be stockpiled for future plating of the slopes and the overburden shall be used to construct the berms around the perimeter of the sand mine. Clearing and excavation of the surface sand mine will be in a north to south direction. The topsoil shall be removed and stockpiled. The overburden will be used to construct the perimeter berm of the mined area. The berm will be constructed and elevated above the existing natural ground. This raised levee will preclude storm water outside the sand mine zone from entering the mined area. Storm water shall drain away from the site through existing natural watercourses and elevation changes. A temporary sump basin shall be located in the northeast area of each phase of the surface mining operation. The purpose of this temporary sump is to collect sediment and stormwater falling into the mining pit. All incidental storm water entering the mining operation and ground water will not leave the sand mine and shall not be discharged into the waters of the State of Mississippi.
4. The general configuration of the mining operation and the construction techniques of the surface mining area has been arranged to minimize any impact to the adjacent lands.

Erosion and Sediment Controls

Mine development will proceed in the planned sequence and every attempt will be made to prevent erosion. All disturbed areas will be managed and revegetated as soon as practicable after construction activities. Where applicable, disturbed areas will be stabilized by temporary seeding, permanent seeding, mulching and/or vegetative buffer strips as each case dictates.

Structural Practices

In addition to vegetative practices referenced above, certain structural erosion control measures shall be implemented as needed. The measures include diverting flows from exposed soils, storing flows or otherwise limiting runoff from exposed areas. Other structural methods will include straw bale dikes, silt fences, earth dikes, brush barriers, drainage swales, check dams, outlet protection, detention/retention basins, sediment traps, temporary sediment basins or equivalent sediment controls.

1. Construct the sediment / detention pond with the spoils from the excavation to be used in berms.
2. Divert upslope surface water around disturbed areas of the site as shown in figure 1, Diversion Dikes.
3. Limit the exposure of the disturbed area to the shortest amount of time as practicable.
4. Minimize the amount of surface area that must be disturbed at one time.
5. Implement the best management practices to mitigate adverse impacts from storm water runoff. Shown in Figures 2, 3, 4, 5 and 6.

Erosion and sediment controls consisting of vegetative and structural practices shall be designed to preserve vegetation or timely revegetated disturbed areas and divert from exposed soils or otherwise limit runoff from exposed areas.

Controls shall be placed to minimize off-site vehicle tracking of sediments.

Controls shall be implemented as needed to retain storm water in the on-site detention pond to prevent adverse impact to receiving streams. When work is not being performed in a disturbed area, appropriate temporary and/or vegetative and structural practices shall be initiated.

Any of the following erosion and sedimentation control measures may be used to control/reduce pollutants in storm water.

- Temporary Seeding
- Permanent Seeding
- Mulching
- Sod Stabilization
- Vegetative Buffer Strips
- Grassy Swales
- Modification of Contours
- Silt Fences
- Detention Basin
- Sediment Traps
- Sedimentation Basin
- Check Dams
- Straw Bale Dikes
- Earth and/or Sandbag Dikes
- Brush Barriers
- Subsurface Drains
- Pipe Slope Drains
- Storm Drain Inlet Protection
- Drainage Swales
- Rock Outlet Protection

A rain gauge shall be set up on site during mining operations. The rain gauge shall be located near the sand mine. Within twenty-four hours after commencement of a rainfall event greater than or equal to a Two Year 24 Hour Storm Event (6 inches), an inspection of all controls and

other SWPPP requirements shall be performed during the permit coverage in compliance with Part IV.B of the permit.

Other controls of importance may include, but are not limited to:

1. Topsoil will be removed from the area to be mined and used to plate diversion dikes and berms.
2. Preserving existing vegetation and revegetating disturbed soil as soon as possible to limit the exposure time of the disturbed area.
3. Surface area that must be disturbed will be minimized.
4. Management practices to mitigate adverse impacts from storm water runoff are, but not limited to, interceptor dikes and swales, hay bales, brush barriers, silt fences, and sediment traps. Figures 1, 2, 3, 4, 5 and 6.
5. Structurally sound dams and levees will be constructed for impoundments.
6. Encompassing various stockpiles such as fill or topsoil materials with silt fence and or hay bales.
7. Properly maintaining, cleaning, repairing the site, and erosion prevention controls.

Inspection Requirements

Inspection of all temporary and vegetative, erosion and sediment controls, and other protective measures and SWPPP requirements will be performed during the permit coverage.

After each significant rainfall, but not less than once a week all disturbed areas, erosion and sediment controls shall be inspected.

At least once every month:

1. Within twenty-four hours after commencement of a rainfall event greater than or equal to a Two Year 24 Hour Storm Event (6 inches).
2. As often as necessary ensure that appropriate erosion and sediment controls have been properly constructed and maintained.

Maintenance

1. All needed repairs shall be made within 24 hours.
2. Remove sediment from inlet protection devices and silt fences when accumulated silt has attained 50 percent capacity.
3. Reseed, fertilize and mulch as needed.

Post Construction

Upon completion of mining activities, post construction control measures shall include on-site infiltration, flow attenuation in vegetated swales and natural depressions and retention structures. Velocity dissipation devices may be required at the outfall of these structures and along the outfall channels provide non-erosive flows.

REPORTING

Inspections will be reported on copies of the forms provided. The report form shall be submitted semi-annually, postmarked not later than the 28th day of July or January for each six-month period. All records, reports and information resulting from activities required by this permit shall be retained of at least three years from the date of the MNOI, inspection or report. The inspection report is attached at the end of this SWPPP. This form shall be duplicated as necessary.

NONCOMPLIANCE REPORTING

1. **Anticipated Noncompliance:** The Mississippi Office of Pollution Control (OPC) will be given at least ten days advance notice, if possible, before any planned noncompliance with permit requirements.
2. **Unanticipated Noncompliance:** The Mississippi Office of Pollution Control (OPC) shall be notified orally within 24 hours from the time that the operator becomes aware of the unanticipated noncompliance. A written report will be provided to the OPC within five working days from the time the operator becomes aware of the circumstances. The

report shall describe the cause, the exact dates and times, steps taken or planned to reduce, eliminate, or prevent reoccurrence and, if the noncompliance has not ceased, the anticipated time for correction.

TERMINATION of REPORTING & PERMIT COVERAGE

Upon successful completion of all permanent erosion control and sediment controls for a covered project, a certification of the same will be submitted to the Mississippi Office of Pollution Control. Inspections shall continue for at least two months beyond completion. If controls have been successful during these two months, reporting and permit coverage is automatically terminated unless notified by OPC within thirty days of receiving the final inspection report.

POLLUTION PREVENTION PLAN CERTIFICATION

I certify under penalty of law that this document and all attachments were prepared under my direction or supervision in accordance with a system designed to assure that qualified personnel properly gathered and evaluated the information submitted. Based on my inquiry of the person or persons who manage the system, or those persons responsible for gathering the information, the information submitted, to the best of my knowledge and belief, true accurate and complete. I am aware that there are significant penalties for submitting false information, including the possibility of fine and imprisonment for knowing violations.

Signed: _____

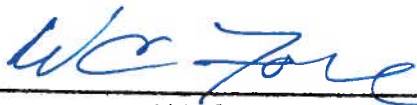

W. C. Fore

Date: _____

January 31, 2005

ATTACHMENT 1

**STORM WATER POLLUTION
PREVENTION PLAN**

SITE LOCATION MAP

RECLAMATION SITE MAP

LATIMER ROAD SAND MINE
38 ACRES AMENDMENT
SECTION 1
TOWNSHIP 7 SOUTH
RANGE 11 WEST
GULFPORT NORTH QUADRANGLE
GULFPORT, HARRISON, MISSISSIPPI

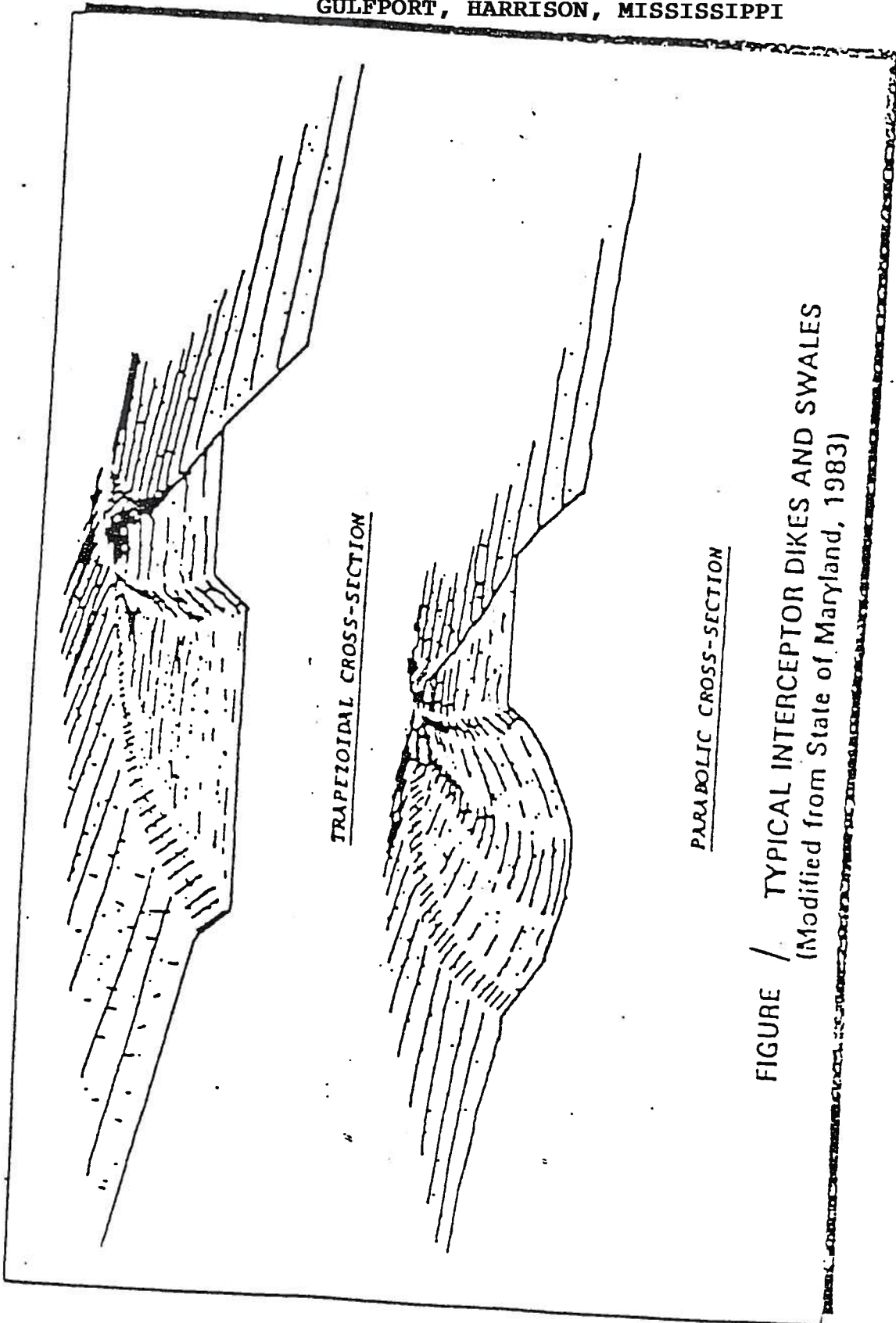

FIGURE / TYPICAL INTERCEPTOR DIKES AND SWALES
(Modified from State of Maryland, 1983)

LATIMER ROAD SAND MINE
38 ACRE AMENDMENT
SECTION 1
TOWNSHIP 7 SOUTH
RANGE 11 WEST
GULFPORT NORTH QUADRANGLE
GULFPORT, HARRISON, MISSISSIPPI

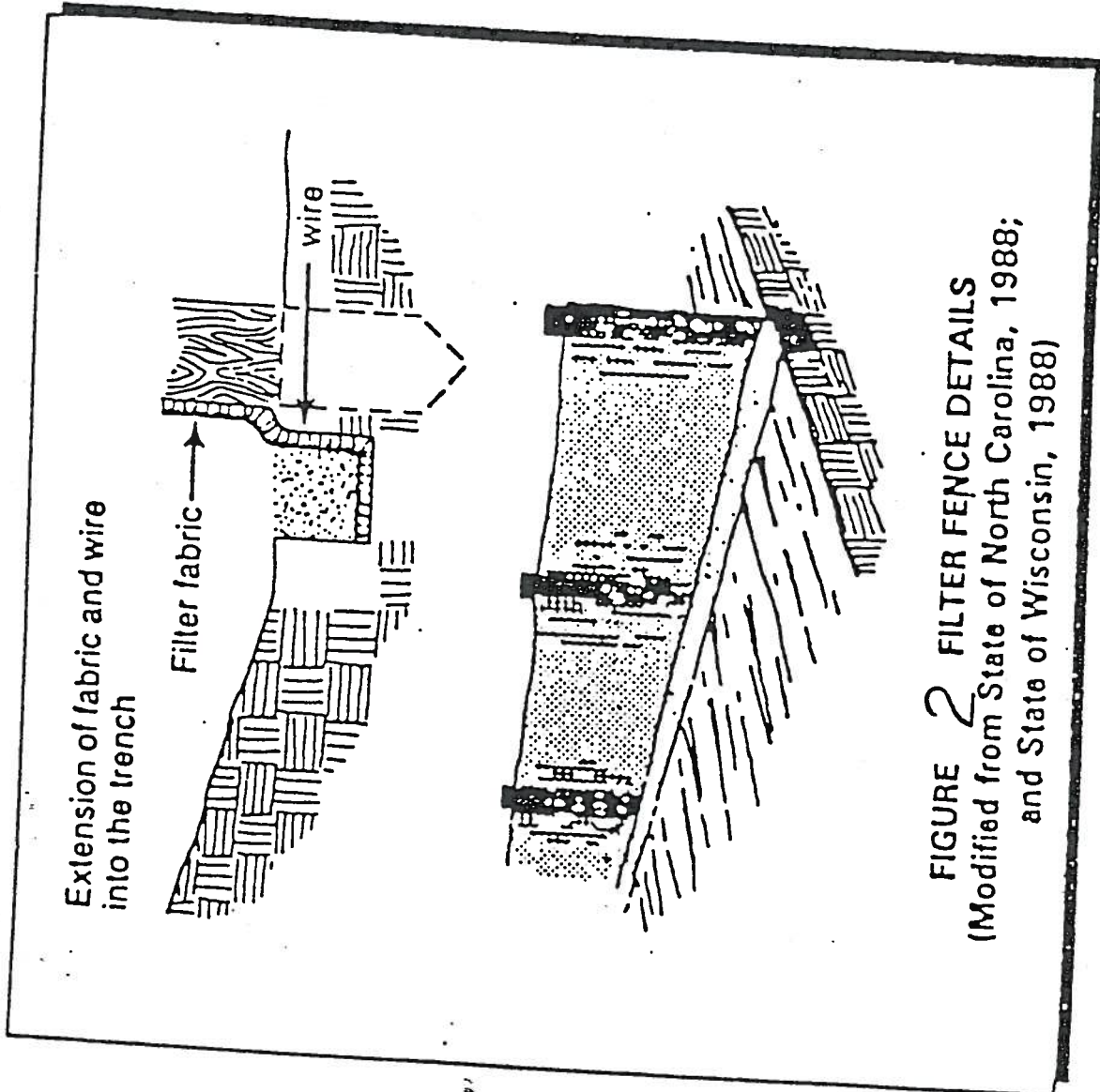

FIGURE 2 FILTER FENCE DETAILS
(Modified from State of North Carolina, 1988;
and State of Wisconsin, 1988)

LATIMER ROAD SAND MINE
38 ACRE AMENDMENT
SECTION 1
TOWNSHIP 7 SOUTH
RANGE 11 WEST
GULFPORT NORTH QUADRANGLE
GULFPORT, HARRISON, MISSISSIPPI

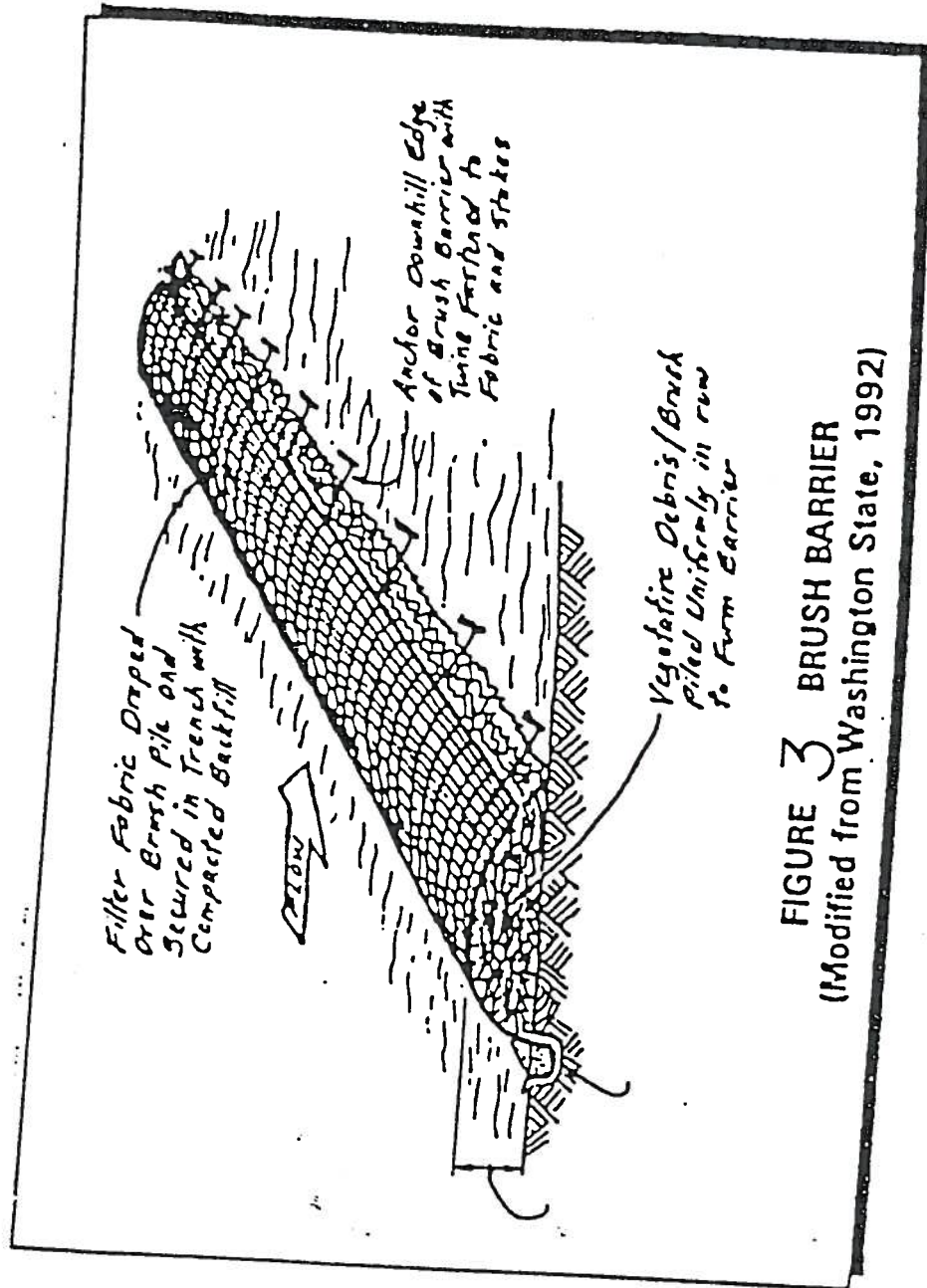

FIGURE 3 BRUSH BARRIER
(Modified from Washington State, 1992)

LATIMER ROAD SAND MINE
38 ACRE AMENDMENT
SECTION 1
TOWNSHIP 7 SOUTH
RANGE 11 WEST
GULFPORT NORTH QUADRANGLE
GULFPORT, HARRISON, MISSISSIPPI

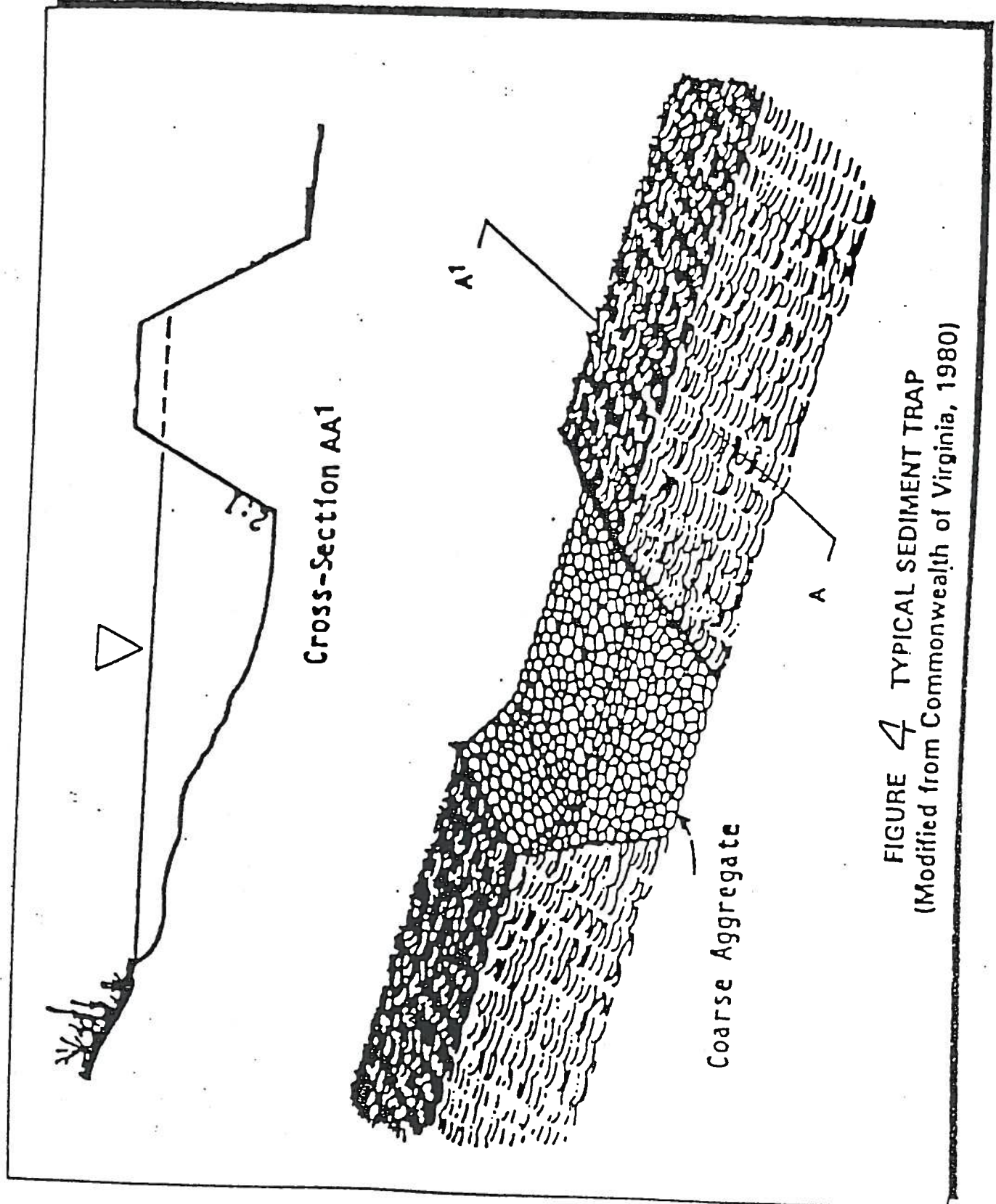
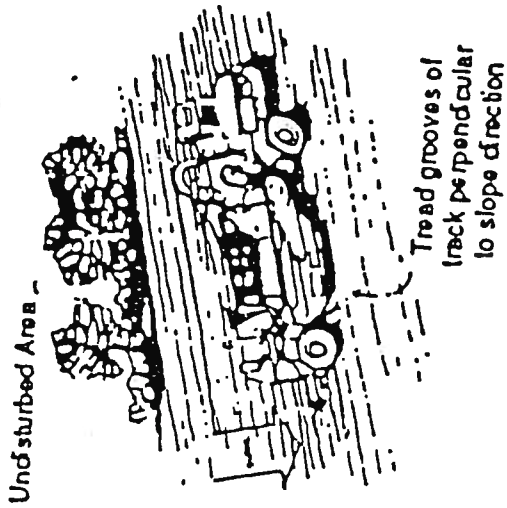
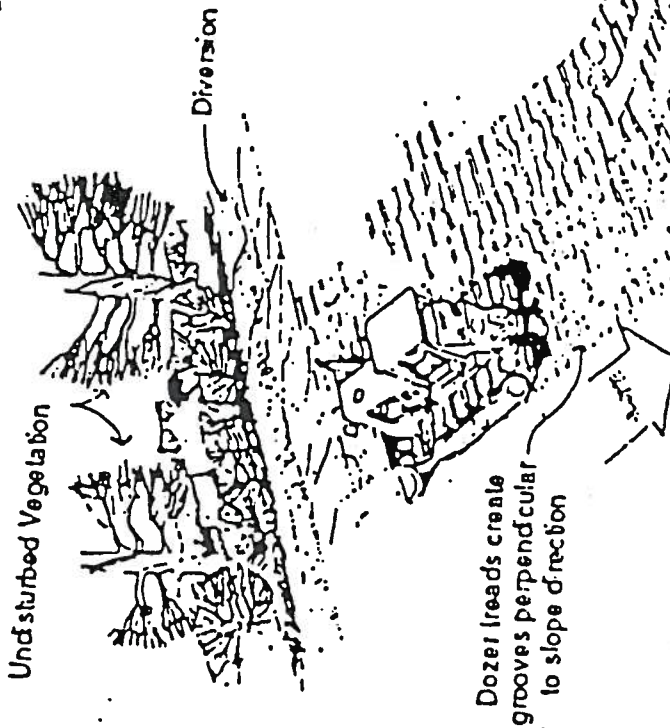

FIGURE 4 TYPICAL SEDIMENT TRAP
(Modified from Commonwealth of Virginia, 1980)

LATIMER ROAD SAND MINE
 38 ACRE AMENDMENT
 SECTION 1
 TOWNSHIP 7 SOUTH
 RANGE 11 WEST
 GULFPORT NORTH QUADRANGLE
 GULFPORT, HARRISON, MISSISSIPPI



Heavy Equipment can be used to mechanically scarify slopes



Unvegetated slopes should be temporarily scarified to minimize runoff velocities

FIGURE 5 SURFACE ROUGHENING

LATIMER ROAD SAND MINE
38 ACRE AMENDMENT
SECTION 1
TOWNSHIP 7 SOUTH
RANGE 11 WEST
GULFPORT NORTH QUADRANGLE
GULFPORT, HARRISON, MISSISSIPPI

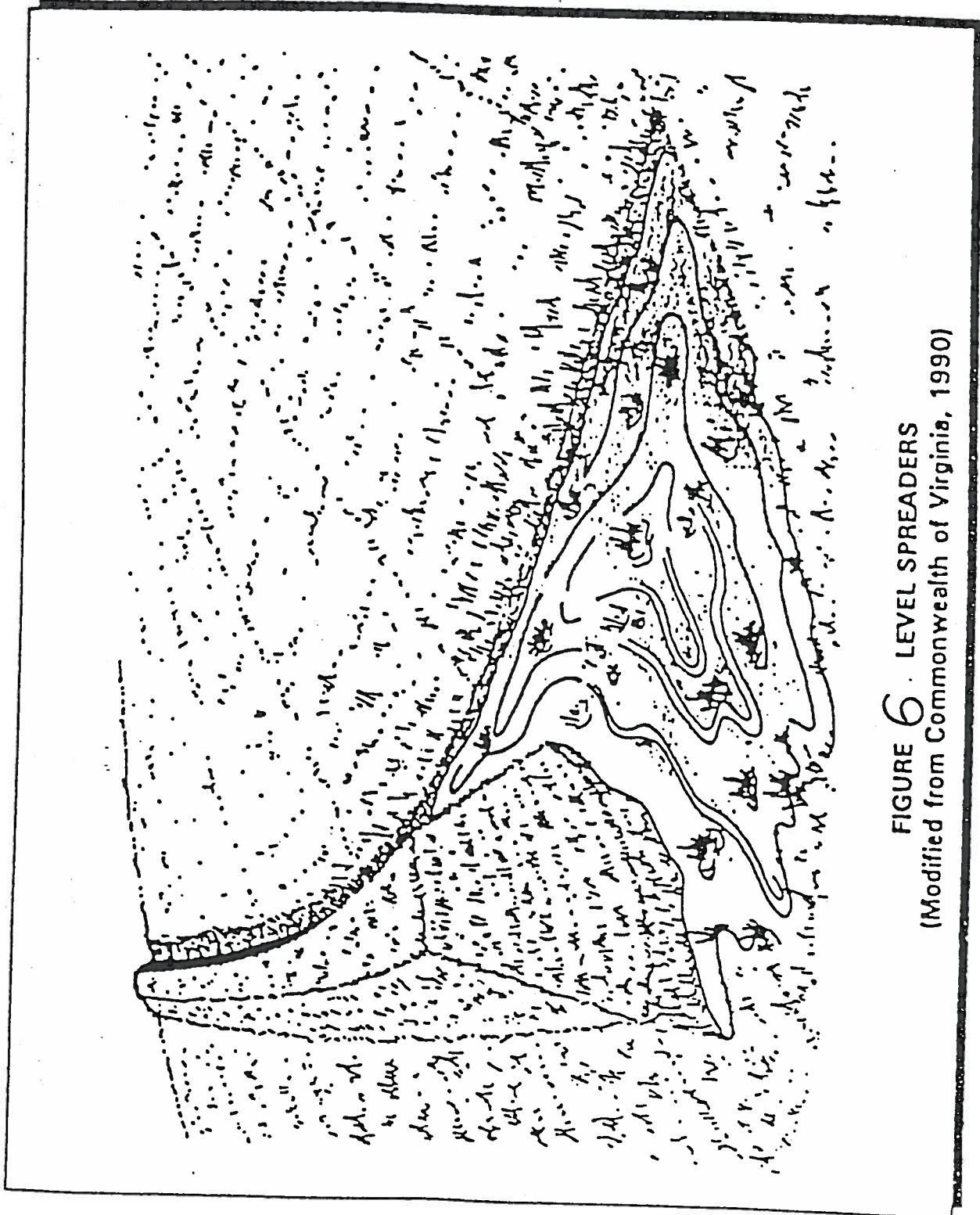

FIGURE 6 LEVEL SPREADERS
(Modified from Commonwealth of Virginia, 1990)

LATIMER ROAD SAND MINE
(EXPANSION) 38 ACRES
GULFPORT NORTH QUADRANGLE
SECTION 1
TOWNSHIP 7 SOUTH
RANGE 11 WEST

LATIMER ROAD SAND MINE
EXPANSION 38 ACRES

LATIMER ROAD SAND MINE
EXISTING 38 ACRES

NORTH LATIMER ROAD

Substation
DEDEAUX

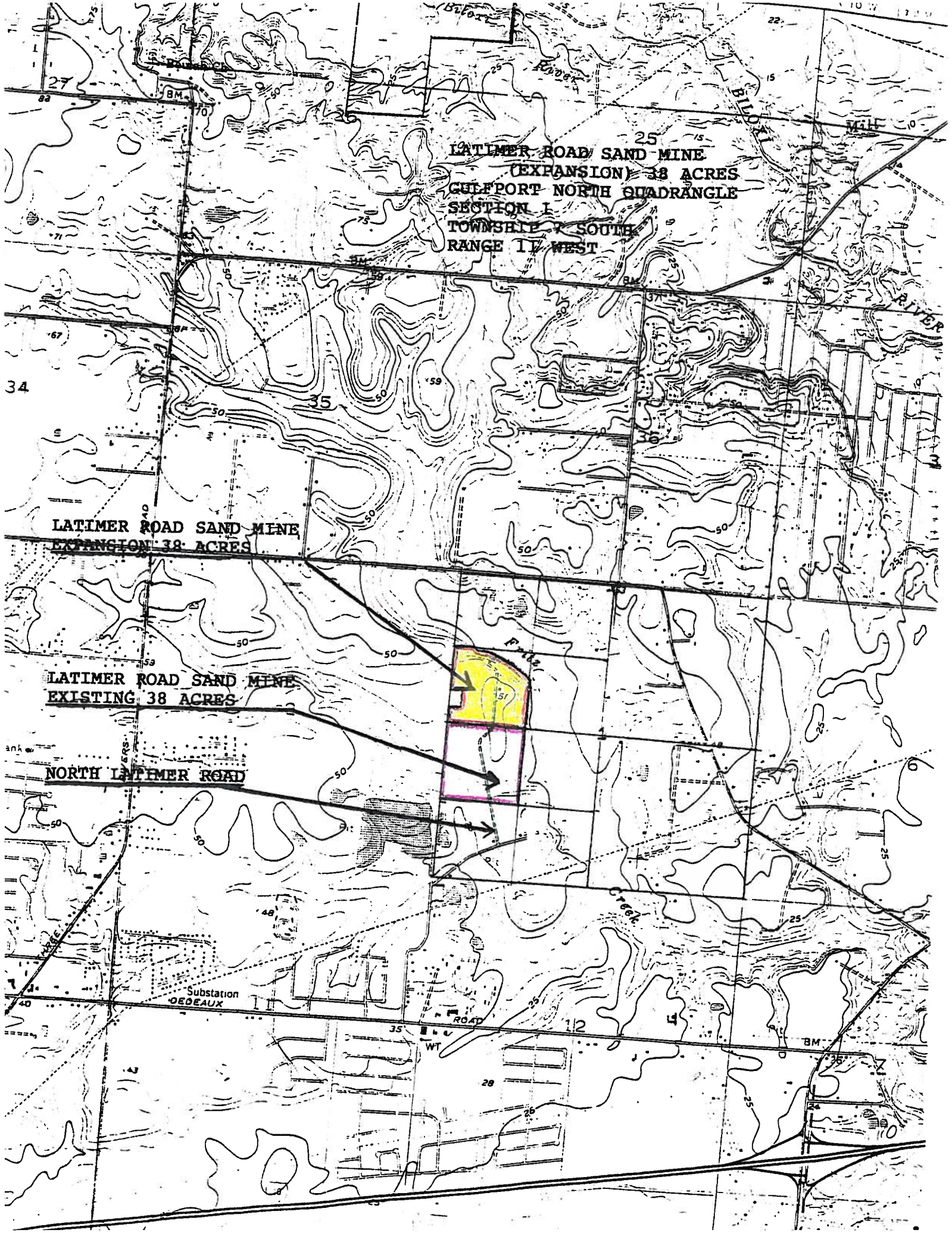

LATIMER ROAD SAND MINE EXPANSION 38 ACRES
GULFPORT NORTH QUADRANGLE

435 000 FEET

300 000 FEET

(Joins sheet 29)

T. 6 S.
T. 7 S.

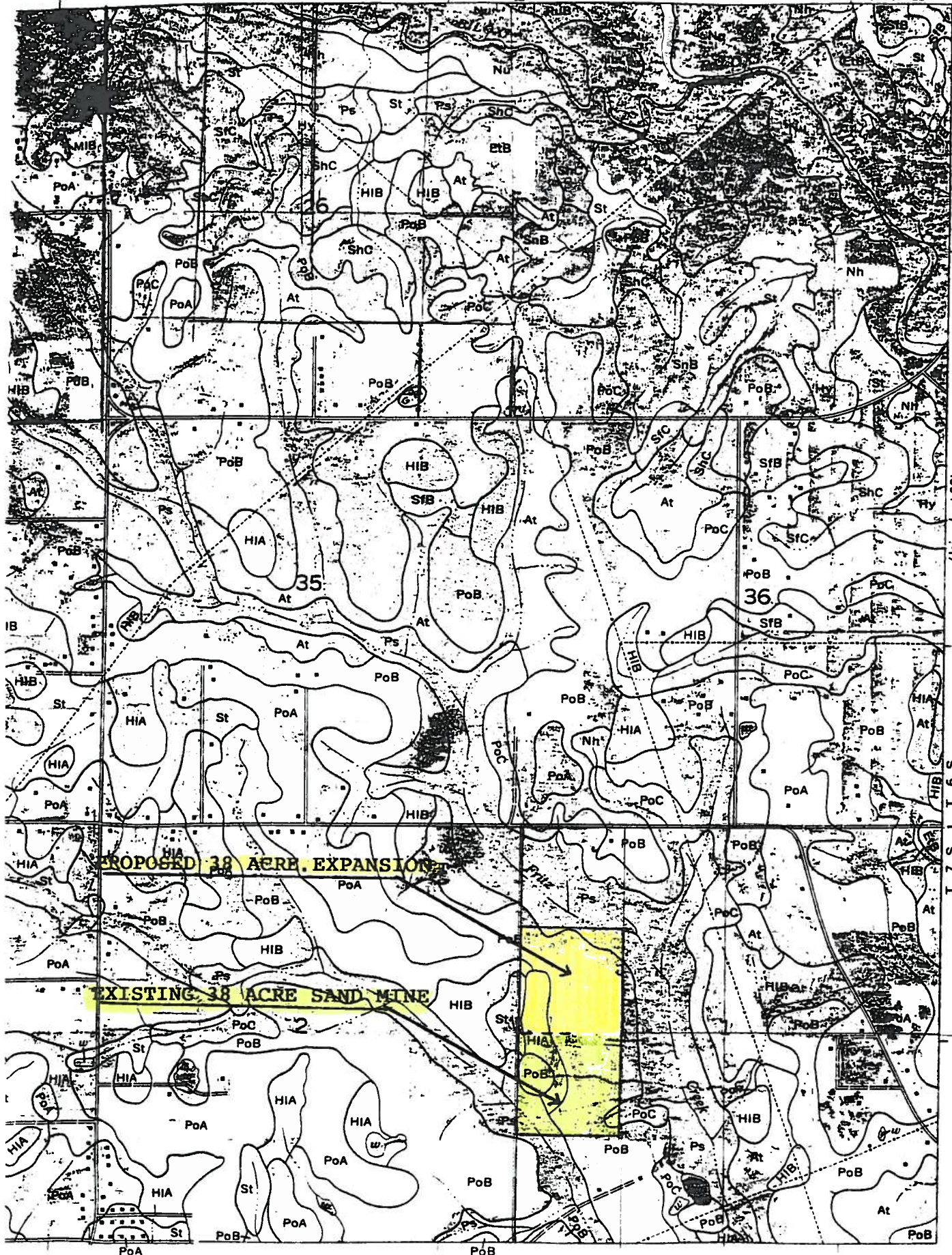

Land division corners are approximately positioned on this map.
Photobase from 1972 aerial photography. Positions of 5,000 ft. grid ticks are approximate and based on the Mississippi coordinate system, east zone
-This map is one of 1972 compiled in 1973 as part of a soil survey by the United States Department of Agriculture, Soil Conservation Service, Forest Service,
Photobase from 1972 aerial photography. Positions of 5,000-ft grid ticks are approximate and based on the Mississippi coordinate system, east zone

SECTION 1

3536
2 1

NW 1/4

NE 1/4

SW 1/4

SE 1/4

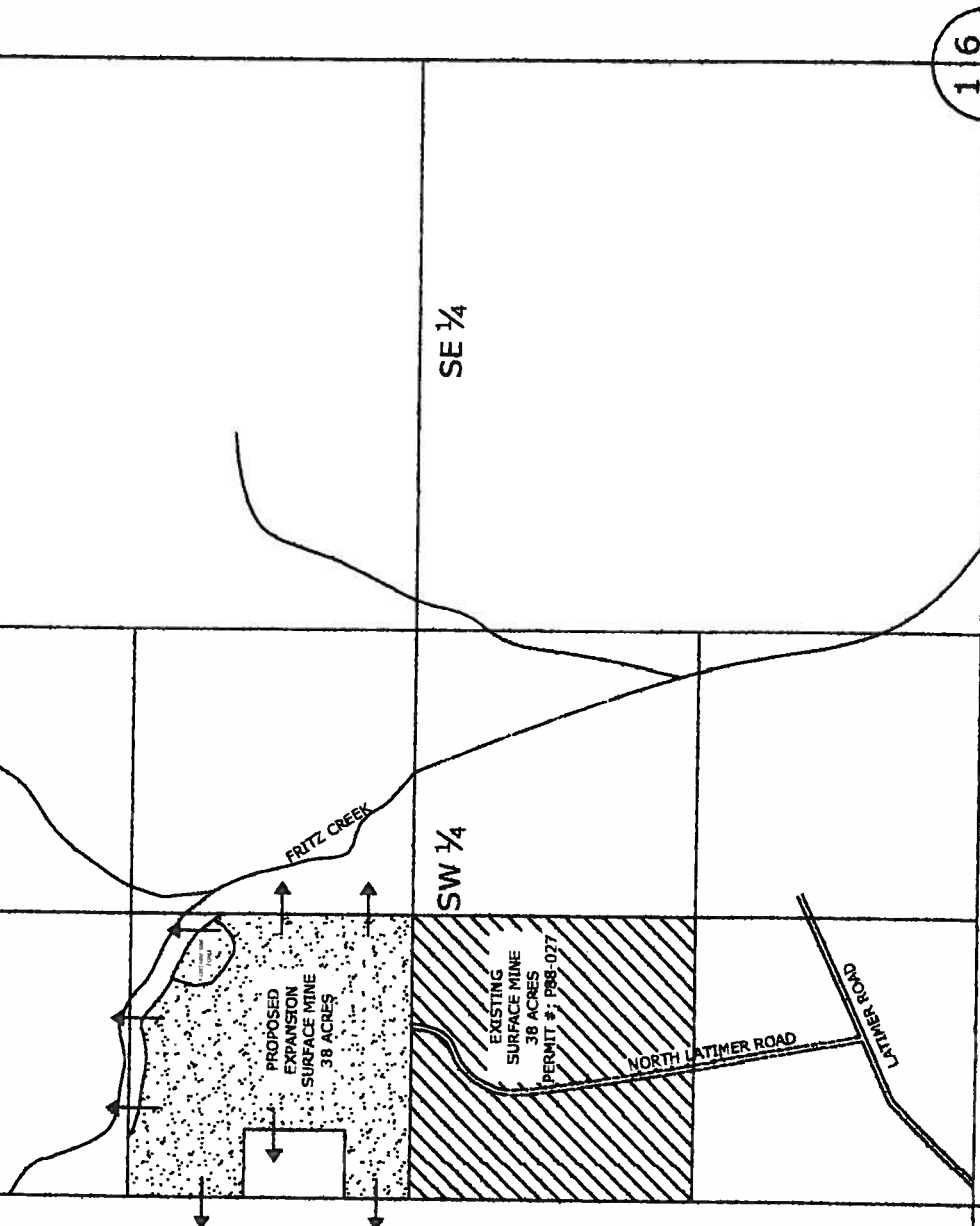
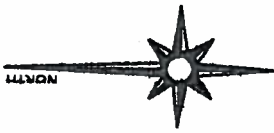

16
127

500 0 200 400 600
CENTIMETERS - FEET

General Notes

SITE PLAN

LEGEND & NOTES

-LATIMER ROAD SAND MINE IS AN 38 ACRE EXPANSION TO PERMIT NUMBER PBB-027.

-NORTH LATIMER ROAD MINE WILL BE A TOTAL OF 76 ACRES.

-NORTH LATIMER ROAD WILL BE USED FOR INGRESS & EGRESS.

-PERMIT AREA: 

-EXISTING AREA: 

-THIS AREA IS NOT LOCATED IN A FLOOD ZONE ACCORDING TO THE FEMA FLOOD ZONE MAP.

-EXISTING SURFACE DRAINAGE: 

TOTAL PERMIT EXPANSION AREA 38.00 ACRES

GULFPORT NORTH QUADRANGLE SECTION 1 TOWNSHIP 7 SOUTH RANGE 11 WEST

No.	Project Number	Date
	2005-2-02	

W. C. FORE TRUCKING, INC.
P. O. BOX 3158
GULFPORT, MS 39505
(228) 863-1314

LATIMER ROAD SAND MINE
LATIMER ROAD
GULFPORT, MS 39505

M. R. ROUSE
Feb. 1, 2005
Scale As Noted
S-1

SECTION 1

3536
2 1

NW 1/4

NE 1/4

SW 1/4

SE 1/4



FRTZ CREEK

PROPOSED
EXPANSION
SURFACE MINE
38 ACRES

EXISTING
SURFACE MINE
38 ACRES
PERMIT #: P88-027

NORTH LATIMER ROAD

LATIMER ROAD

16
127

250 0 200 100 000
SURFACE FEET - FEET

General Notes	
SITE PLAN	
LEGEND & NOTES	
-LATIMER ROAD SAND MINE IS AN 38 ACRE EXPANSION TO PERMIT NUMBER P88-027.	
-NORTH LATIMER SAND MINE WILL BE A TOTAL OF 76 ACRES.	
-NORTH LATIMER ROAD WILL BE USED FOR INGRESS & EGRESS.	
-PERMIT AREA:	
-EXISTING AREA:	
-THIS AREA IS NOT LOCATED IN A FLOOD ZONE ACCORDING TO THE FEMA FLOOD ZONE MAP.	
-EXISTING SURFACE DRAINAGE:	
TOTAL PERMIT EXPANSION AREA 38.00 ACRES	
GULFPORT NORTH QUADRANGLE SECTION 1 TOWNSHIP 7 SOUTH RANGE 11 WEST	
No.	Date
Project Number 2005-2-02	

W. C. FORE TRUCKING, INC.
P. O. BOX 3058
GULFPORT, MS 39505
(228) 863-1314

LATIMER ROAD SAND MINE
LATIMER ROAD
GULFPORT, MS 39505

M. R. ROUSE
Feb. 1, 2005
Scale As Noted

S-1

WEST

EAST

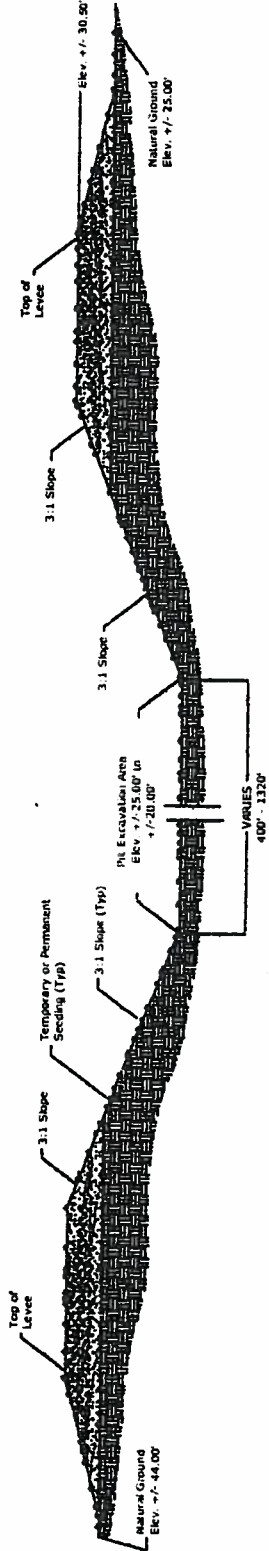

TYPICAL MINING PIT BERM (INTS)

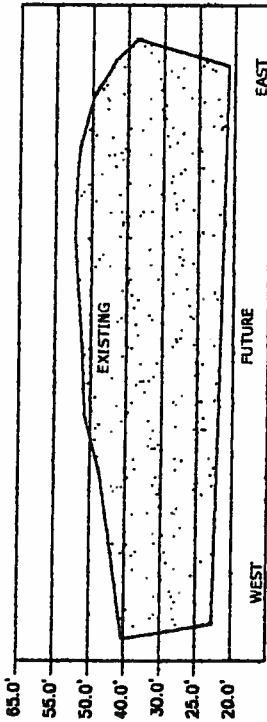

SECTION A-A

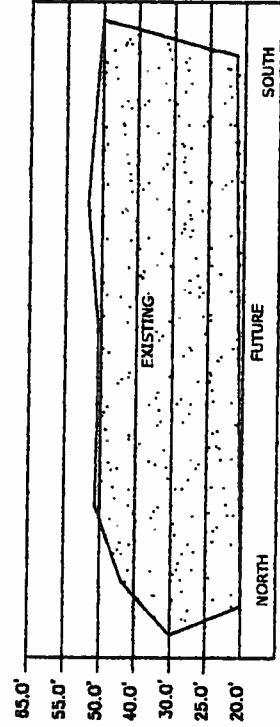

SECTION B-B

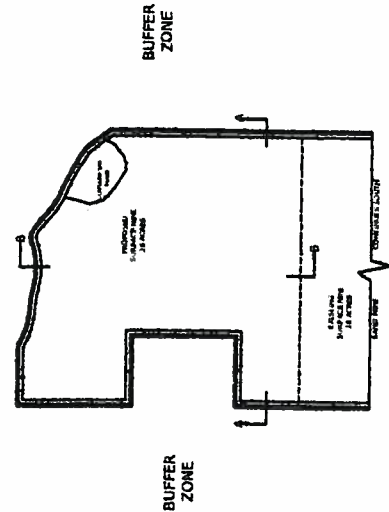

LATIMER ROAD SAND MINE
 MINE EXPANSION AREA 38.00
 EXISTING SAND MINE 38.00

TOTAL IMPACT AREA: 76.00 ACRES

RECLAMATION DETAILS

LEGEND & NOTES

1. All Slopes To Be 3:1.
2. All Slopes To Be Seeded.
3. All Buffer Zones To Be Maintained.
4. Establish Erosion Control On All Slopes & Tops Of Berm.

TOTAL PERMIT
 EXPANSION AREA
 38.00 ACRES

GULFPORT NORTH
 QUADRANGLE
 SECTION 1
 TOWNSHIP 7 SOUTH
 RANGE 11 WEST

No.	Project Number	Date
	2005-2-02	

W. C. FORE
 TRUCKING, INC.
 P. O. BOX 3058
 GULFPORT, MS 39505
 (228) 863-1314

LATIMER ROAD
 SAND MINE
 LATIMER ROAD
 GULFPORT, MS 39505

M. R. ROUSE
 Feb. 1, 2005
 Scale As Noted

R-1

POST RECLAMATION

LEGEND & NOTES

1. A 76.00 acre lake will be formed after reclamation.
2. Proposed Surface Drainage:
3. Surface mine will have grass cover.
4. Berms will be pushed back into the surface mine. Topsoil will be spread on lake edges to begin grass cover.

TOTAL PERMIT EXPANSION AREA 38.00 ACRES

GULFPORT NORTH QUADRANGLE SECTION 1 TOWNSHIP 7 SOUTH RANGE 11 WEST

No.	Project Number	Date
	2005-2-02	

W. C. FORE TRUCKING, INC.
P. O. BOX 3058
GULFPORT, MS 39505
(228) 863-1314

LATIMER ROAD SAND MINE
LATIMER ROAD
GULFPORT, MS 39505

M. R. ROUSE
Feb. 1, 2005
Scale As Noted
R-2

